

RECORD OF LAND CORNER MONUMENTATION

SOUTH 1/4 CORNER SECTION 32, T. 8 S., R. 37 E., W.M.

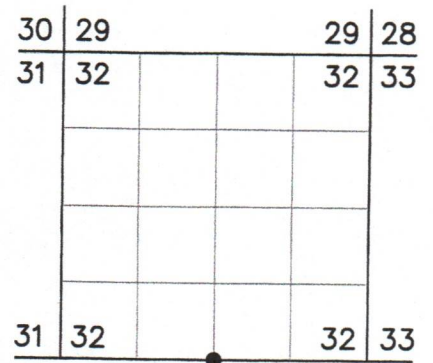

ORIGINALLY ESTABLISHED BY: Lincoln E. Wilkes, U.S. Cadastral Engineer

GROUP NUMBER: 107

APPROVAL DATE: May 26, 1927

SUBSEQUENT SURVEYS: Corner maintenance activities performed October 9, 1984, by William L. Hanley, PLS #1639, as evidenced by the Certified Record of Land Corner Monumentation filed June 11, 1985, as Baker County Survey No. 8-37-10.

ORIGINAL DESCRIPTION: Set an iron post, 3 ft. long, 1 in. dia., 27 ins. in the ground, for $\frac{1}{4}$ sec. cor., of sec. 32 only, with brass cap marked (diagram shown) from which

A black pine, 10 ins dia., bears N. 60° E., 36 lks. dist., marked 1/4 S 32 BT.

A tamarack, 5 ins. dia., bears N. 50° W., 12 lks. dist., marked 1/4 S 32 BT.

HANLEY'S DESCRIPTION: Brass cap found as per official record and marked as shown in diagram.

A tamarack, 7 ins. dia., bears N 50°W., 12 lks. dist., with healed blaze.

Remnants of a decomposed log and root hole, bears N 60° E., 36 lks.

Improved surrounding rock mound around corner monument and set a 6 foot steel fence post alongside with a sign 54-9 attached.

New bearing trees:

A fir 8 ins. dia., bears N 32° E. 11.0 ft. marked 1/4 S 32 BT.

A fir 6 ins. dia., bears N 37° W. 6.9 ft. marked 1/4 S 32 BT.

EVIDENCE FOUND: Found 1" iron pipe with 2 $\frac{1}{2}$ " brass cap, marked as shown below, projecting 6" above ground in a 2 ft. diameter mound of stone, with a steel fence post with attached USFS 54-9 sign set Northeast, 4 ft. from monument.

Both of Hanley's bearing trees are now snags. I found no remains of the GLO bearing trees.

DESCRIPTION OF MONUMENTS AND ACCESSORIES SET AND METHODS USED:

I accept the position of the found monument for the corner.

From which, **I SCRIBE NEW BEARING TREES:**

- ▶ A western larch, 15" dbh, bears N.22 $\frac{1}{2}$ ° E., 15.98 ft. marked 1/4 S32 in upper blaze, and BT in lower blaze.
- ▶ A white fir, 17" dbh, bears S.77°E., 18.77 ft. marked X in upper blaze, and BT in lower blaze.
- ▶ A white fir, 12" dbh, bears S.09°W., 25.35 ft. marked X in upper blaze, and BT in lower blaze.
- ▶ A white fir, 9" dbh, bears N.47°W., 11.14 ft. marked 1/4 S32 in upper blaze, and BT in lower blaze.

CORNER MONUMENT
MARKED:



Painted a 6 inch red band around each bearing tree, painted the blazes red, and attached USFS 54-3 and 54-9 signs. Used a staff compass with 14° East declination to measure bearings to BT's. Used an EDM device to measure distances to new bearing trees, measuring to a 60d nail driven in the side-center-right at the root crown of each tree, with an attached 1 $\frac{1}{2}$ " aluminum washer stamped PLS 69454. See associated Map of Survey dated October 17, 2023 for survey-related information.

RESTORATION BY, STAMP AND DATE:

Work performed July 5, 2023
Survey completed October 17, 2023

Jason L. Hatfield, PLS
Spencer B. Jones, Survey Tech

USDA FOREST SERVICE
NORTHEAST OREGON LAND ZONE
1550 Dewey Avenue, Suite A
Baker City, OR 97814
(541) 523-1283

FILED December 20, 2023
BAKER COUNTY SURVEYOR
SURVEY NO. 8-37-167
9-37-142 A-7
342

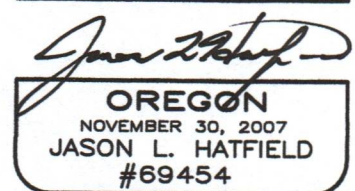
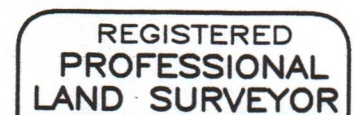

EXPIRES: 6/30/2025