

# RECORD OF LAND CORNER MONUMENTATION

EAST 1/4 CORNER SECTION 32, T. 8 S., R. 37 E., W.M.

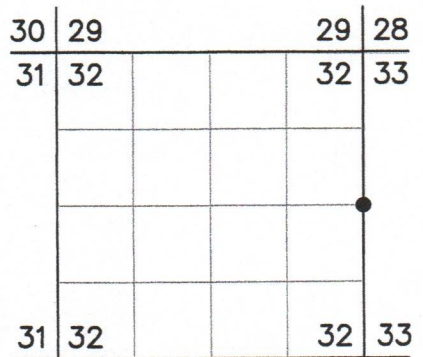

**ORIGINALLY ESTABLISHED BY:** Lincoln E. Wilkes, U.S. Cadastral Engineer

**GROUP NUMBER:** 107

**APPROVAL DATE:** May 26, 1927

**SUBSEQUENT SURVEYS:** Corner maintenance activities performed June 11, 1985 by William L. Hanley, PLS #1639, as evidenced by the Certified Record of Land Corner Monumentation filed February 5, 1986, as Baker County Survey No. 8-37-85

**ORIGINAL DESCRIPTION:** Set an iron post, 3 ft. long, 1 in. dia., 27 ins. in the ground, for 1/4 sec. cor., with brass cap marked (diagram shown) from which  
 A tamarack, 7 ins. dia., bears S. 26° E., 25 lks. dist., marked 1/4 S 33 BT.  
 A white fir, 7 ins. dia., bears N. 10 1/2° W., 45 lks. dist., marked 1/4 S 32 BT.

**HANLEY'S DESCRIPTION:**

A tamarack 22 ins diam bears S26°E, 25 lks dist with fully healed blaze.  
 A fir 22 ins diam bears N10 1/2°W, 45 lks dist with fully healed blaze.

At corner position established from above noted original accessories, found a brass cap monument in concrete encasement and marked as shown in corner diagram.

Improved surrounding rock mound around recovered corner monument and set a 6 foot steel fence post alongside with a sign 54-9 attached.

No new bearing trees established.

**EVIDENCE FOUND:** Found 1 1/2" galvanized iron pipe with 2 1/2" brass cap, marked as shown below, projecting 5" above ground, with a steel fence post with attached USFS 54-9 sign set northwesterly, 3 ft. from the found monument.

From which:

A western larch, 27" dbh, bears S.26°E., 16.5 ft., in good condition.

A fir, 28" dbh, bears N.10 1/2°W., 29.7 ft., in good condition.

Note: there were piles of dirt pushed up against the front of both trees, covering the blaze locations.

**DESCRIPTION OF MONUMENTS AND ACCESSORIES SET AND METHODS USED:**

I accept the position of the found monument for the corner.

CORNER MONUMENT  
MARKED:

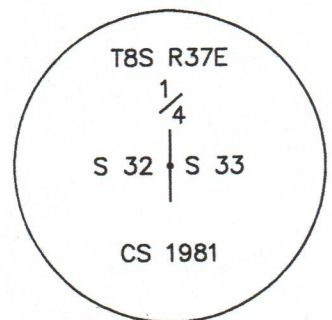

Used magnetic compass with 14° East declination to measure bearings. Used an EDM device to measure distances to BT's. See associated Map of Survey dated October 17, 2023 for survey-related information.

**RESTORATION BY, STAMP AND DATE:**

Work performed July 6, 2023  
 Survey completed October 17, 2023

Toribio J. Quinones, LSIT

USDA FOREST SERVICE  
 NORTHEAST OREGON LAND ZONE  
 1550 Dewey Avenue, Suite A  
 Baker City, OR 97814  
 (541) 523-1283

FILED December 20, 2023  
 BAKER COUNTY SURVEYOR  
 SURVEY NO. 8-37-165

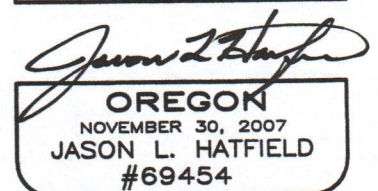
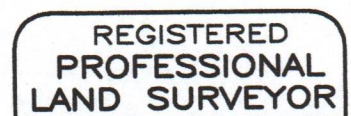

EXPIRES: 6/30/2025