

# RECORD OF LAND CORNER MONUMENTATION

SOUTH 1/4 CORNER SECTION 28, T. 8 S., R. 37 E., W.M.

**ORIGINALLY ESTABLISHED BY:** Lincoln E. Wilkes, U.S. Cadastral Engineer

**GROUP NUMBER:** 107

**APPROVAL DATE:** May 26, 1927

**SUBSEQUENT SURVEYS:** Corner maintenance activities performed June 11, 1985 by William L. Hanley, PLS #1639, as evidenced by the Certified Record of Land Corner Monumentation filed February 5, 1986, as Baker County Survey No. 8-37-81

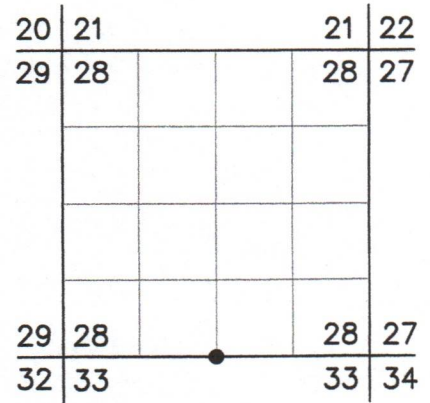

**ORIGINAL DESCRIPTION:** Set an iron post, 3 ft. long, 1 in. dia., 27 ins. in the ground, for 1/4 sec. cor., with brass cap marked (diagram shown) from which  
 A white fir, 24 ins. dia., bears N. 45° W., 89 lks. dist., marked 1/4 S 28 BT.  
 A white fir, 12 ins. dia., bears S. 4° E., 48 lks. dist., marked 1/4 S 33 BT.

**HANLEY'S DESCRIPTION:** NOTE: Additional accessory bearing trees were established by John R. Mitchell, skilled surveyor technician, to perpetuate this corner as noted below.  
 A brass cap of record dimensions and markings as shown in corner diagram.  
 No evidence of old BT's. A broken off stump bears N39°W but no sign of scribes (does not look like it was big enough)  
 Improved surrounding rock mound around recovered corner monument and set a 6 foot steel fence post alongside with a sign 54-9 attached.  
 Bearing trees established by John R. Mitchell in 1981:  
 A western larch 11 ins dia bears S37°E, 18.8 ft marked 1/4S33BT.  
 A spruce 10 ins dia bears N83°E, 16.5 ft marked 1/4S28BT.

**EVIDENCE FOUND:** Found 1" iron pipe with 2 1/2" brass cap, marked as shown below, projecting 8" above ground in a 3 ft. diameter mound of stone, with a steel fence post with attached USFS 54-9 sign set Northeast, 4 ft. from monument.

From which,

- ▶ A rootwad depression, bears N.83°E., 16.5 ft. (Mitchell BT).
- ▶ A western larch, 18" dbh , bears S.37°E., 18.8 ft., in good condition with a healed single blaze (Mitchell BT).

**DESCRIPTION OF MONUMENTS AND ACCESSORIES SET AND METHODS USED:**

I accept the position of the found monument for the corner.

From which, **I SCRIBE NEW BEARING TREES:**

- ▶ A lodgepole pine, 12" dbh, bears N.71°E., 44.73 ft. marked 1/4 S28 in upper blaze, and BT in lower blaze.
- ▶ A white fir, 14" dbh, bears S.64°W., 42.23 ft. marked 1/4 S33 in upper blaze, and BT in lower blaze.
- ▶ A white fir, 10" dbh, bears N.09°W., 27.10 ft. marked X in upper blaze, and BT in lower blaze.

CORNER MONUMENT MARKED:



Painted a 6 inch red band around each bearing tree, painted the blazes red, and attached USFS 54-3 and 54-9 signs. Used a magnetic compass with 14° East declination to measure bearings to BT's. Used an EDM device to measure distances to new bearing trees, measuring to a 60d nail driven in the side-center-right at the root crown of each tree, with an attached 1 1/2" aluminum washer stamped PLS 69454.

**RESTORATION BY, STAMP AND DATE:**

Work Performed July 12, 2023  
 Survey completed October 17, 2023

Vincent L. Kelly, Survey Tech  
 Daniel B. Lee, Survey Tech

USDA FOREST SERVICE  
 NORTHEAST OREGON LAND ZONE  
 1550 Dewey Avenue, Suite A  
 Baker City, OR 97814  
 (541) 523-1283

FILED December 20, 2023  
 BAKER COUNTY SURVEYOR  
 SURVEY NO. 8-37-162

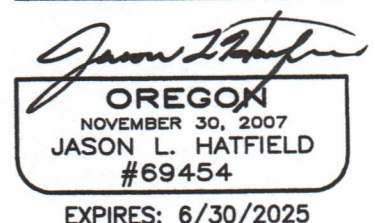
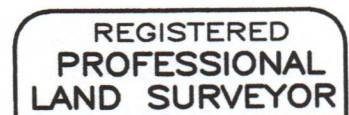

EXPIRES: 6/30/2025