

RECORD OF LAND CORNER MONUMENTATION

WEST-EAST-WEST 1/256 CORNER SECTIONS 29 & 32, T. 8 S., R. 37 E., W.M.

ORIGINALLY ESTABLISHED BY: CORNER NOT PREVIOUSLY ESTABLISHED

GROUP NUMBER: N/A

APPROVAL DATE: N/A

19	20	20	21
30	29	29	28
30	29	29	28
31	32	32	33

ORIGINAL DESCRIPTION: N/A

EVIDENCE FOUND: N/A

DESCRIPTION OF MONUMENTS AND ACCESSORIES SET AND METHODS USED:

At the corner point as determined by survey, I set a standard USFS 2 1/2" x 30" aluminum pipe with attached 3 1/4" aluminum cap, 26" in the ground. Raised a 3 ft. diameter mound of stone around the monument to top of cap. Cap is marked as shown below.

From which, I SCRIBE NEW BEARING TREES:

- ▶ A western larch, 16" dbh, bears S.73°05'W., 22.30 ft. marked *W-E-W1/256 S32* in upper blaze, and *BT* in lower blaze.
- ▶ A Douglas-fir, 26" dbh, bears N.33°18'W., 20.71 ft. marked *W-E-W1/256 S29* in upper blaze, and *BT* in lower blaze.

CORNER MONUMENT MARKED:

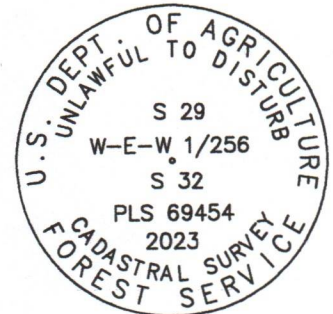

Placed a plastic-encased magnet beneath the base of the pipe. Painted a 6 inch red band around each bearing tree, painted the blazes red, and attached USFS 54-3 and 54-9 signs. Used a total station to measure bearing and distance to each tree. Distances were measured to a 60d nail driven in the side-center-right at the root crown of each tree, with an attached 1 1/2" aluminum washer stamped PLS 69454. Set aluminum guard posts North and South, with USFS 54-2 and 54-9 signs attached. See associated Map of Survey dated October 17, 2023 for survey-related information.

RESTORATION BY, STAMP AND DATE:

Work performed September 27, 2023
Survey completed October 17, 2023

Jason L. Hatfield, PLS
Daniel B. Lee, Survey Tech
Ian R. Adler

USDA FOREST SERVICE
NORTHEAST OREGON LAND ZONE
1550 Dewey Avenue, Suite A
Baker City, OR 97814
(541) 523-1283

FILED December 20, 2023
BAKER COUNTY SURVEYOR
SURVEY NO. 8-37-159

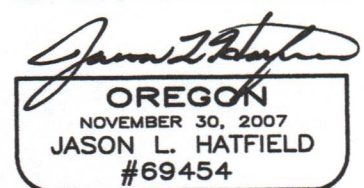
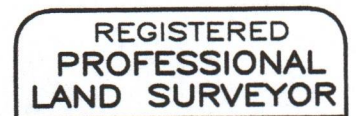

EXPIRES: 6/30/2025