

RECORD OF LAND CORNER MONUMENTATION

SOUTHWEST CORNER SECTION 30, T. 8 S., R. 37 E., W.M.

ORIGINALLY ESTABLISHED BY: Lincoln E. Wilkes, U.S. Cadastral Engineer

GROUP NUMBER: 107

APPROVAL DATE: May 26, 1927

SUBSEQUENT SURVEYS: Corner maintenance activities performed October 2, 1984 by William L. Hanley, PLS #1639, as evidenced by the Certified Record of Land Corner Monumentation filed June 11, 1985, as Baker County Survey No. 8-37-5

19			19	20
30			30	29
30			30	29
31			31	32

ORIGINAL DESCRIPTION: Set an iron post, 3 ft. long, 2 ins dia., 27 ins. in the ground for closing cor. of secs. 30 and 31, with brass cap marked (diagram shown) from which
 A black pine, 4 ins. dia., bears N. 54° E., 60 lks. dist., marked T 8 S R 37 E S 30 CC BT.
 A black pine, 4 ins. dia., bears S. 55° E., 111 lks. dist., marked T 8 S R 37 E S 31 CC BT.

HANLEY'S DESCRIPTION: Brass cap found as per official record and marked as shown in diagram.
 A pine snag 13 ins. diam., bears S 54° W., 60 lks. dist., with healed blaze.
 A pine snag 12 ins. diam., bears N 55° W., 111 lks. dist., with healed blaze.
 Improved surrounding rock mound around corner monument and set a 6 foot steel fence post alongside with a sign 54-9 attached.
 New bearing trees:
 A pine 7 ins. diam. bears S 75° E 14.1 ft. marked T 8 S R 37 E S 31 CC BB
 A fir 6 ins. diam., bears N 57° E 23.2 ft. marked T 8 S R 37 E S 30 CC BT

EVIDENCE FOUND: Found 2" iron pipe with 2 1/2" brass cap, marked as shown below, firmly set and projecting 4" above ground in a 2 ft. diameter mound of stone, with a steel fence post with attached USFS 54-9 sign set alongside.

From which,
 ▶ A fir snag, 6" dbh, bears N.57°E., 23.2 ft., with visible scribing in an open blaze (Hanley BT).
 All other bearing trees are dead and down.

DESCRIPTION OF MONUMENTS AND ACCESSORIES SET AND METHODS USED:

I accept the position of the found monument for the corner. I rebuilt the mound of stone, 3 ft. diameter to base of cap.

From which, **I SCRIBE NEW BEARING TREES:**

- ▶ A lodgepole pine, 13" dbh, bears N.46°E., 69.4 ft. marked T8SR37ES30CC in upper blaze, and BT in lower blaze.
- ▶ An Engelmann spruce, 15" dbh, bears S.89°E., 72.0 ft. marked T8SR37ES31CC in upper blaze, and BT in lower blaze.

CORNER MONUMENT
MARKED:

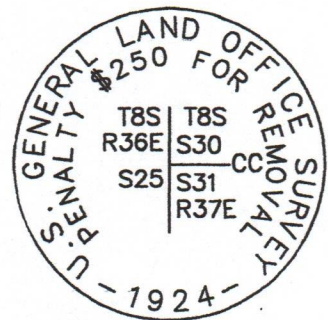

Painted a 6 inch red band around each bearing tree, and also painted the blazes red. Attached USFS 54-3 and 54-9 signs to BT's. Used a staff compass with 14° East declination to measure bearings to accessories. Used an EDM device to measure distances to new bearing trees, measuring to a 60d nail driven in the side-center-right at the root crown of each tree, with an attached 1 1/2" aluminum washer stamped PLS 69454. See associated Map of Survey dated October 17, 2023 for survey-related information.

RESTORATION BY, STAMP AND DATE:

Work performed June 12, 2023
 Survey completed October 17, 2023

Jason L. Hatfield, PLS
 Daniel B. Lee, Survey Tech

USDA FOREST SERVICE
 NORTHEAST OREGON LAND ZONE
 1550 Dewey Avenue, Suite A
 Baker City, OR 97814
 (541) 523-1283

FILED December 20, 2023
 BAKER COUNTY SURVEYOR
 SURVEY NO. 8-36-97
8-37-156

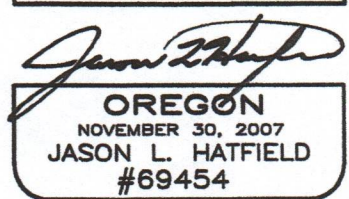
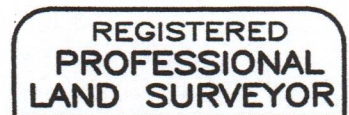

EXPIRES: 6/30/2025