

# RECORD OF LAND CORNER MONUMENTATION

CENTER-SOUTH 1/16 CORNER SECTION 30, T. 8 S., R. 37 E., W.M.

**ORIGINALLY ESTABLISHED BY:** CORNER NOT PREVIOUSLY ESTABLISHED

**GROUP NUMBER:** N/A

**APPROVAL DATE:** N/A

19			19		20
30			30		29
		●			
30			30		29
31			31		32

**ORIGINAL DESCRIPTION:** N/A

**EVIDENCE FOUND:** N/A

**DESCRIPTION OF MONUMENTS AND ACCESSORIES SET AND METHODS USED:**

At the corner point as determined by survey, I set a standard USFS 2 1/2" x 30" aluminum pipe with attached 3 1/4" aluminum cap, 26" in the ground. Raised a 2 ft. diameter mound of stone around the monument to top of cap. Cap is marked as shown below.

**From which, I SCRIBE NEW BEARING TREES:**

- ▶ A lodgepole pine, 18" dbh, bears S.81°E., 60.49 ft. marked X in upper blaze, and BT in lower blaze.
- ▶ A lodgepole pine, 16" dbh, bears S.39°E., 32.27 ft. marked CS1/16 S30 in upper blaze, and BT in lower blaze.

CORNER MONUMENT MARKED:

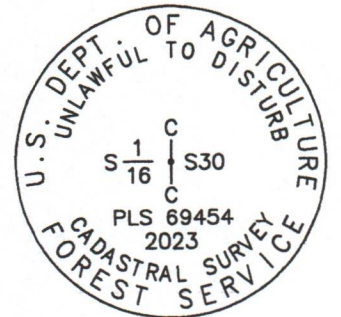

Placed a plastic-encased magnet beneath the base of the pipe. Painted a 6 inch red band around the bearing trees, painted the blazes red, and attached USFS 54-3 and 54-9 signs. Used a magnetic compass with 14° East declination to measure bearings. Used a steel tape to measure distances to bearing trees, measuring to a 60d nail driven in the side-center-right at the root crown of each tree, with an attached 1 1/2" aluminum washer stamped PLS 69454. Set an aluminum guard post East, with USFS 54-2 and 54-9 signs attached, and another one West, with a USFS 54-2 sign attached. See associated Map of Survey dated October 17, 2023 for survey-related information.

**RESTORATION BY, STAMP AND DATE:**

Work performed September 13, 2023  
Survey completed October 17, 2023

Jason L. Hatfield, PLS  
Daniel B. Lee, Survey Tech

USDA FOREST SERVICE  
NORTHEAST OREGON LAND ZONE  
1550 Dewey Avenue, Suite A  
Baker City, OR 97814  
(541) 523-1283

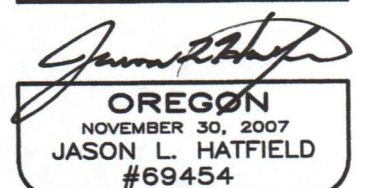
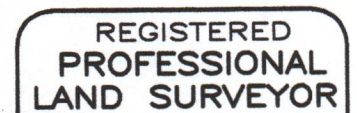

EXPIRES: 6/30/2025

FILED December 20, 2023  
BAKER COUNTY SURVEYOR  
SURVEY NO. 8-37-152