

RECORD OF LAND CORNER MONUMENTATION

EAST 1/4 CORNER SECTION 29, T. 8 S., R. 37 E., W.M.

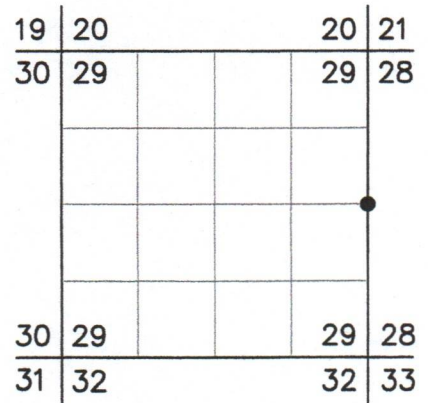

ORIGINALLY ESTABLISHED BY: Lincoln E. Wilkes, U.S. Cadastral Engineer

GROUP NUMBER: 107

APPROVAL DATE: May 26, 1927

SUBSEQUENT SURVEYS: Corner maintenance activities performed June 11, 1985 by William L. Hanley, PLS #1639, as evidenced by the Certified Record of Land Corner Monumentation filed February 5, 1986, as Baker County Survey No. 8-37-75

ORIGINAL DESCRIPTION: Set an iron post, 3 ft. long, 1 in. dia., 27 ins. in the ground, for 1/4 sec. cor., with brass cap marked (diagram shown) from which

A fir, 20 ins. dia., bears N. 16 1/4° E., 73 lks. dist., marked 1/4 S 28 BT.

A fir, 16 ins. dia., bears S. 34° W., 71 lks. dist., marked 1/4 S 29 BT.

HANLEY'S DESCRIPTION:

NOTE: Additional accessory bearing trees were established by John R. Mitchell, skilled surveyor technician, to perpetuate this corner as noted below.

A brass cap of record dimensions and markings as shown in diagram.

A white fir cut log stump 30 ins dia bears N.16 1/4°E., 73 lks with healed blaze.

A douglas fir 27 ins dia bears S34°W, 71 lks with healed blaze.

Improved surrounding rock mound around recovered corner monument and set a 6 foot steel fence post alongside with a sign 54-9 attached.

Bearing tree established by John R. Mitchell in 1981:

An alpine fir 11 ins dia bears N 66° E, 11.9 ft. marked 1/4 S28 BT.

EVIDENCE FOUND: Found 1" iron pipe with 2 1/2" brass cap, marked as shown below, projecting 10" above ground in a 2 ft. diameter mound of stone, with a steel fence post with attached USFS 54-9 sign set northwesterly, 4 ft. from the found monument. The brass cap was oriented N.32°E.

From which:

- ▶ A stump bears N.16 1/4°E., 48.2 ft. (GLO BT).
- ▶ A subalpine fir, 18" dbh, bears N.66°E., 11.9 ft., with visible scribing in a partially healed single blaze (Mitchell BT).
- ▶ A Douglas-fir, 33" dbh, bears S.34°W., 46.9 ft., with healed double blaze (Hanley BT).

DESCRIPTION OF MONUMENTS AND ACCESSORIES SET AND METHODS USED:

I accept the position of the found monument for the corner.

CORNER MONUMENT
MARKED:

Painted a 6 inch red band around each bearing tree, and also painted the blazes red. Attached USFS 54-3 and 54-9 signs to BT's. Used magnetic compass with 14° East declination to measure bearings. Used an EDM device to measure distances to BT's. See associated Map of Survey dated October 17, 2023 for survey-related information.



RESTORATION BY, STAMP AND DATE:

Work performed July 7, 2023
Survey completed October 17, 2023

Toribio J. Quinones, LSIT
Spencer B. Jones, Survey Tech

USDA FOREST SERVICE
NORTHEAST OREGON LAND ZONE
1550 Dewey Avenue, Suite A
Baker City, OR 97814
(541) 523-1283

FILED December, 20, 2023
BAKER COUNTY SURVEYOR
SURVEY NO. 8-37-150

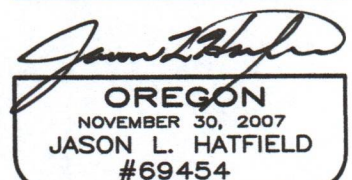
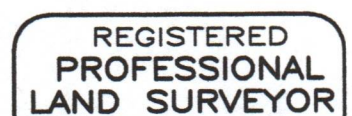

EXPIRES: 6/30/2025