

RECORD OF LAND CORNER MONUMENTATION

CENTER-EAST 1/16 CORNER SECTION 30, T. 8 S., R. 37 E., W.M.

ORIGINALLY ESTABLISHED BY: CORNER NOT PREVIOUSLY ESTABLISHED

GROUP NUMBER: N/A

APPROVAL DATE: N/A

19			19		20
30			30		29
		●			
30			30		29
31			31		32

ORIGINAL DESCRIPTION: N/A

EVIDENCE FOUND: N/A

DESCRIPTION OF MONUMENTS AND ACCESSORIES SET AND METHODS USED:

At the corner point as determined by survey, I set a standard USFS 2 1/2" x 30" aluminum pipe with attached 3 1/4" aluminum cap, 25" in the ground. Raised a 2 ft. diameter mound of stone around the monument to top of cap. Cap is marked as shown below.

From which, I SCRIBE NEW BEARING TREES:

- ▶ An Engelmann spruce, 13" dbh, bears S.11°06'E., 19.59 ft. marked *CE1/16 S30* in upper blaze, and *BT* in lower blaze.
- ▶ A lodgepole pine, 15" dbh, bears N.28°22'W., 27.36 ft. marked *CE1/16 S30* in upper blaze, and *BT* in lower blaze.

CORNER MONUMENT
MARKED:



Placed a plastic-encased magnet beneath the base of the pipe. Painted a 6 inch red band around each bearing tree, and also painted the blazes red. Attached USFS 54-3 and 54-9 signs to BT's. Used a total station to measure bearings and distances to bearing trees. Distances were measured to a 60d nail driven in the side-center-right at the root crown of each tree, with an attached 1 1/2" aluminum washer stamped PLS 69454. Bearings are geodetic, based on GPS observation at the corner. Set an aluminum guard post South, with USFS 54-2 and 54-9 signs attached, and another West, with USFS 54-2 sign attached. See associated Map of Survey dated October 17, 2023 for survey-related information.

RESTORATION BY, STAMP AND DATE:

Work performed August 10, 2023
Survey completed October 17, 2023

Jason L. Hatfield, PLS
Daniel B. Lee, Survey Tech
Vincent L. Kelly, Survey Tech

USDA FOREST SERVICE
NORTHEAST OREGON LAND ZONE
1550 Dewey Avenue, Suite A
Baker City, OR 97814
(541) 523-1283

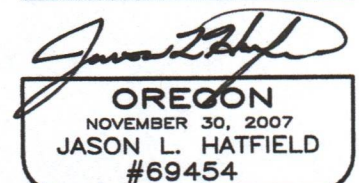
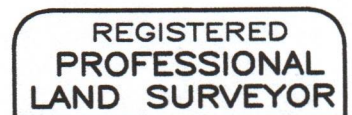

EXPIRES: 6/30/2025

FILED December 20, 2023
BAKER COUNTY SURVEYOR
SURVEY NO. 8-37-148