

RECORD OF LAND CORNER MONUMENTATION

CENTER-NORTH 1/16 CORNER SECTION 30, T. 8 S., R. 37 E., W.M.

ORIGINALLY ESTABLISHED BY: CORNER NOT PREVIOUSLY ESTABLISHED

GROUP NUMBER: N/A

APPROVAL DATE: N/A

19		19	20
30		30	29
	●		
30		30	29
31		31	32

ORIGINAL DESCRIPTION: N/A

EVIDENCE FOUND: N/A

DESCRIPTION OF MONUMENTS AND ACCESSORIES SET AND METHODS USED:

At the corner point as determined by survey, I set a standard USFS 2 1/2" x 30" aluminum pipe with attached 3 1/4" aluminum cap, 22" in the ground to bedrock. Raised a 3 ft. diameter mound of stone around the monument to top of cap. Cap is marked as shown below.

From which, I SCRIBE NEW BEARING TREES:

- ▶ A lodgepole pine, 12" dbh, bears N.36°E., 26.0 ft. marked X in upper blaze, and BT in lower blaze.
- ▶ A lodgepole pine, 14" dbh, bears N.45°W., 39.9 ft. marked CN1/16 S30 in upper blaze, and BT in lower blaze.

CORNER MONUMENT
MARKED:

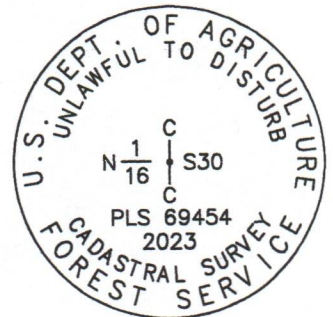

Placed a plastic-encased magnet beneath the base of the pipe. Painted a 6 inch red band around each bearing tree, and also painted the blazes red. Attached USFS 54-3 and 54-9 signs to BT's. Used a hand compass with 14° East declination to measure bearings to accessories. Used a steel tape to measure distances to bearing trees, measuring to a 60d nail driven in the side-center-right at the root crown of each tree, with an attached 1 1/2" aluminum washer stamped PLS 69454. Set an aluminum guard post West, with USFS 54-2 and 54-9 signs attached, and another one South, with USFS 54-2 sign attached. See associated Map of Survey dated October 17, 2023 for survey-related information.

RESTORATION BY, STAMP AND DATE:

Work performed August 28, 2023
Survey completed October 17, 2023, by:

Jason L. Hatfield, PLS
Daniel B. Lee, Survey Tech

USDA FOREST SERVICE
NORTHEAST OREGON LAND ZONE
1550 Dewey Avenue, Suite A
Baker City, OR 97814
(541) 523-1283

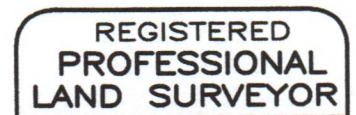

Jason L. Hatfield

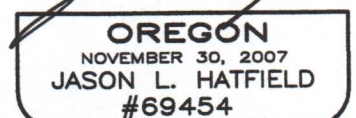

EXPIRES: 6/30/2025

FILED December 20, 2023
BAKER COUNTY SURVEYOR
SURVEY NO. 8-37-145