

RECORD OF LAND CORNER MONUMENTATION

NORTH QUARTER CORNER SECTION 29, T. 8 S., R. 37 E., W.M.

ORIGINALLY ESTABLISHED BY: Lincoln E. Wilkes, U.S. Cadastral Engineer

GROUP NUMBER: 107

APPROVAL DATE: May 26, 1927

SUBSEQUENT SURVEYS:

- ▶ Corner maintenance activities performed June 4, 1985 by William L. Hanley, PLS #1639, as evidenced by the Certified Record of Land Corner Monumentation filed February 5, 1986, as Baker County Survey No. 8-37-70
- ▶ Corner maintenance activities performed November 5, 1997 by Roger O. Green, PLS #2211, as evidenced by the Certified Record of Land Corner Monumentation filed May 19, 1998, as Baker County Survey No. 8-37-125

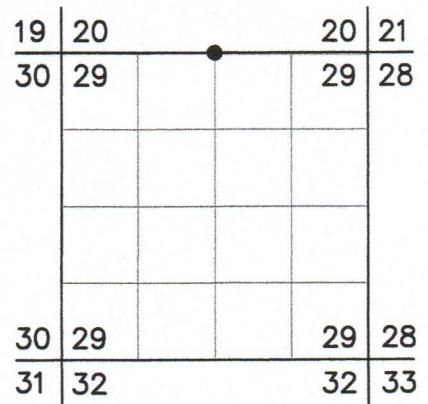

ORIGINAL DESCRIPTION: Set an iron post, 3 ft. long, 1 ins dia., 27 ins. in the ground, for $\frac{1}{4}$ sec. cor., with brass cap marked (diagram shown) from which

- A spruce, 8 ins. dia., bears N. $40\frac{3}{4}^\circ$ E., 29 lks. dist., marked 1/4 S 20 BT.
- A white fir, 8 ins. dia., bears S. 73° W., 23 lks. dist., marked 1/4 S 29 BT.

HANLEY'S DESCRIPTION: A brass cap of record dimensions and markings as shown in corner diagram.

- A spruce stump 17 ins dia bears N40 $\frac{3}{4}$ °W, 29 lks. with evidence of scribes.
- An uprooted white fir 12 ins dia bears S73°W, 23 lks with visible scribes.
- Improved surrounding rock mound around corner monument and set a 6 foot steel fence post alongside with a sign 54-9 attached.
- Bearing trees established by J.R. Mitchell in 1981:
 - An alpine fir 12 ins dia bears S04°E, 26.9 ft marked 1/4S29BT.
 - An alpine fir 11 ins dia bears N54°W, 23.6 ft marked 1/4S20BT.

GREEN'S DESCRIPTION: Found a 2 1/2" brass cap on a 1" diam. iron pipe, 10" above ground, in mound of stone, marked as shown in corner diagram, from which:

- Original bearing trees:
 - A spruce stump 17" diam., bears N41°W, 29 lks. (19.1 feet), with evidence of scribes.
 - An uprooted White Fir, 12" diam., bears S73°W, 23 lks (15.2 feet), scribe marks visible.
- Mitchell Bearing Trees:
 - An Alpine Fir, 12" diam., bears S04°E, 26.9 feet, marked 1/4 S29 BT.
 - An Alpine Fir, 11" diam., bears N54°W, 23.6 feet, marked 1/4 S20 BT.
- From the brass cap, I set the following references:
 - A blue magnetic memorial, 12" in the ground, S. 45° W., 4.0 feet, with brass washer marked LS2211 wired around the magnet.
 - A red magnetic memorial, 12" in the ground, N. 45° W., 4.0 feet, with brass washer marked LS2211 wired around the magnet.

EVIDENCE FOUND: Found 1" iron pipe with 2 1/2" brass cap, marked as shown below, projecting 9" above ground, in a 2 ft. diameter mound of stone, with a steel fence post with USFS sign 54-9, located 3 ft. North and alongside.
From which, the following accessories were found:

- ▶ A subalpine fir snag bears S.04°E., 26.9 ft. (Mitchell BT)
- ▶ A blue magnet, buried below ground, bears S.45°W., 4.0 ft. (Set by Green)
- ▶ The rotted remains of a white fir, bears S.73°W., 15.2 ft. (GLO BT)
- ▶ A subalpine fir, dead and down, bears N.54°W., 23.6 ft. (Mitchell BT)
- ▶ A red magnet, buried below ground, bears N.45°W., 4.0 ft. (Set by Green)

Painted a 6 inch red band around the bearing trees, and also painted the blazes red. Used a hand compass with 14° East declination to measure bearings. Used an EDM device to measure distances. See associated Map of Survey dated October 17, 2023 for survey-related information.

CORNER MONUMENT MARKED:



RESTORATION BY, STAMP AND DATE:

Work Performed July 7, 2023 and Survey Completed October 17, 2023

Toribio J. Quinones, LSIT
Spencer B. Jones, Survey Tech

USDA FOREST SERVICE
NORTHEAST OREGON LAND ZONE
1550 Dewey Avenue, Suite A
Baker City, OR 97814
(541) 523-1283

FILED December 20, 2023
BAKER COUNTY SURVEYOR
SURVEY NO. 8-37-143

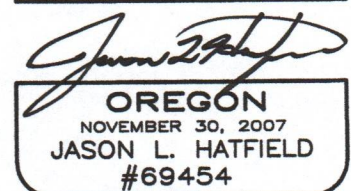
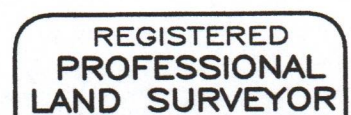

EXPIRES: 6/30/2025