

RECORD OF LAND CORNER MONUMENTATION

EAST 1/4 CORNER SECTION 25, T. 8 S., R. 36 E., W.M.

ORIGINALLY ESTABLISHED BY: Lincoln E. Wilkes, U.S. Cadastral Engineer

GROUP NUMBER: 107

APPROVAL DATE: May 26, 1927

SUBSEQUENT SURVEYS: Corner maintenance activities performed October 2, 1984 by William L. Hanley, PLS #1639, as evidenced by the Certified Record of Land Corner Monumentation filed June 11, 1985, as Baker County Survey No. 8-36-4

23	24	24
26	25	25
26	25	25
35	36	36

ORIGINAL DESCRIPTION: Set an iron post, 3 ft. long, 1 in. dia., 27 ins. in the ground, for 1/4 sec. cor. of sec. 25 only, with brass cap marked (diagram shown) from which

A black pine, 6 ins. dia., bears S. 21° W., 28 1/2 lks. dist., marked 1/4 S 25 BT.

A black pine, 6 ins. dia., bears N. 32 1/2° W., 30 1/2 lks. dist., marked 1/4 S 25 BT.

HANLEY'S DESCRIPTION: A brass cap on an iron pipe marked as shown in corner diagram.

A 14" pine log and stump bears N 32 1/2° W., 30 1/2 lks. dist with healed blaze.

A 13" pine snag bears S 21° W., 28 1/2 lks. dist. with fragmentary scribes visible.

Improved surrounding rock mound around corner monument and set a 6 foot steel fence post alongside with a sign 54-9 attached.

New bearing trees:

A fir 7 inches diam. bears N 63° W., 41.5 ft. dist. marked 1/4 S 25 BT.

A fir 8 inches diam. bears N 09° E., 27.9 ft. dist. marked 1/4 S 25 BT.

EVIDENCE FOUND: Found 1" iron pipe with 2 1/2" brass cap, marked as shown below, projecting 6" above ground in a 2.5 ft. diameter mound of stone, with a steel fence post with attached USFS 54-9 sign set alongside.

From which:

- ▶ A lodgepole pine, 12" dbh, bears S.14 1/2° W., 27.9 ft., with visible scribing in a partially healed single blaze (Hanley BT).
- All other bearing trees are dead and down.

DESCRIPTION OF MONUMENTS AND ACCESSORIES SET AND METHODS USED:

I accept the position of the found monument for the corner. I repaired the mound of stone.

CORNER MONUMENT
MARKED:

From which, I **SCRIBE A NEW BEARING TREE:**

- ▶ A lodgepole pine, 14" dbh, bears N.31°W., 51.0 ft. marked X in upper blaze, and BT in lower blaze.

Also from which, I **SET NEW REFERENCE POINTS:**

- ▶ A 5/8"x 24" iron pin, bears N.28°E., 6.67 ft., with attached 2" aluminum cap marked *RP 1 2023 PLS 69454*
- ▶ A 5/8"x 24" iron pin, bears S.76°E., 7.98 ft., with attached 2" aluminum cap marked *RP 2 2023 PLS 69454*



Painted a 6 inch red band around each bearing tree, and also painted the blazes red. Attached USFS 54-3 and 54-9 signs to BT's. Used a staff compass with 14° East declination to measure bearings to accessories. Used an EDM device to measure distances to bearing trees. Distance to new bearing tree was measured to a 60d nail driven in the side-center-right at the root crown of the tree, with an attached 1 1/2" aluminum washer stamped PLS 69454. Distances to RP's measured with a steel tape. See associated Map of Survey dated October 17, 2023 for survey-related information.

RESTORATION BY, STAMP AND DATE:

Work Performed June 13, 2023
Survey completed October 17, 2023

Jason L. Hatfield, PLS
Daniel B. Lee, Survey Tech

USDA FOREST SERVICE
NORTHEAST OREGON LAND ZONE
1550 Dewey Avenue, Suite A
Baker City, OR 97814
(541) 523-1283

FILED December 20, 2023
BAKER COUNTY SURVEYOR
SURVEY NO. 8-36-96
8-37-141

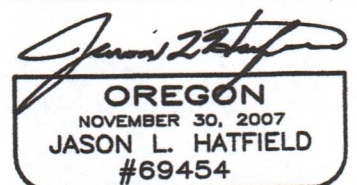
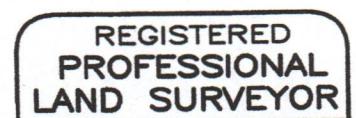

EXPIRES: 6/30/2025