

BASIS OF BEARING IS 1st STREET
BETWEEN POINTS "A" AND "D"

NARRATIVE

The purpose of this survey for the City of Huntington, Oregon is to mark on the ground with proper monumentation, the street intersections as shown hereon. The original map of Huntington is filed in County Plat Book No. 1, Page 48, dated April 8, 1886. The plat describes four permanent corners having been established at points "A", "B", "C", and "D". All monumentation marking these points was recovered; consisting of the following: "A" monument at 1st and Washington is now a 5/8 inch rebar; "B" monument at 6th and Washington is the original 2 1/2 inch x 4 inch steel plate; "C" monument at 6th and Monroe is now a 1 inch diameter iron rod; "D" monument at 1st and Monroe is now a 2 1/2 inch diameter O.S.H.D. brass cap set in concrete. Further explanation is found in Survey No. 14-44-14. The record bearing between "A" and "D" of N. 04°28'00" W, is held this survey.

LEGEND

- FOUND MONUMENT AS NOTED
- SET 5/8" x 30" REBAR WITH PLASTIC CAP MARKED "HANLEY ENGRG PLS 1206"

MAP OF SURVEY INTERSECTION MONUMENTATION HUNTINGTON TOWNSITE

FOR CITY OF HUNTINGTON
SURVEYED JULY 15 & 16, 1998
SCALE 1" = 100'

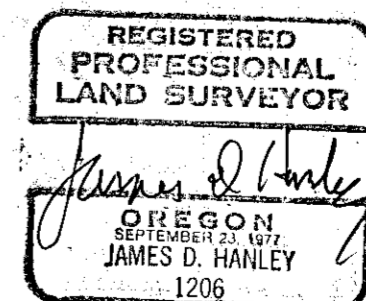

FILED AUG. 28, 1998
BAKER COUNTY SURVEYOR
SURVEY NO. 14-44-25

RENEWS JUNE 30, 1999

BY:
HANLEY ENGINEERING, INC.
2043 MAIN STREET
BAKER CITY, OREGON

14 44 sec 13