

CERTIFIED RECORD OF LAND CORNER MONUMENTATION

HISTORY OF ORIGINAL CORNER ESTABLISHMENT:

This corner was never established.

M16

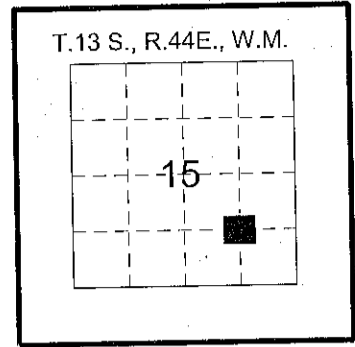

DESCRIPTION OF CORNER EVIDENCE FOUND:

DESCRIPTION OF MONUMENT AND ACCESSORIES ESTABLISHED TO PERPETUATE THE ORIGINAL LOCATION OF THIS CORNER:

Set a 5/8 inch diameter by 30 inch long iron rod (rebar), driven 30 inches in the ground, with 3 1/4 inch diameter aluminum cap marked as shown.
Placed a rock collar and set a galvanized steel post, placed north, 3 feet.

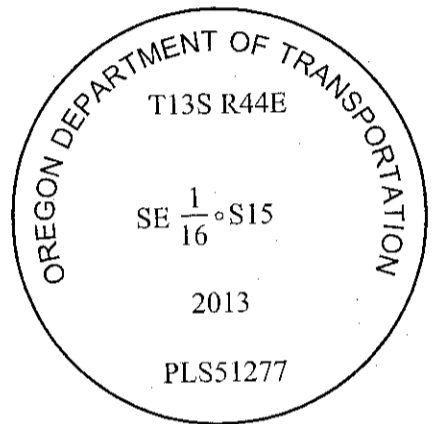

From which: establish the following references:

A clear DEEP-1 magnet, buried 12 inches in the ground, in old wire fence line E-W, bears S. 2° W., 6.20 ft.

A found 1 1/4 inch outside diameter iron pipe, up 14 inches and bent to the southeast (measurements to base on north side), bears S. 79° W., 84.10 ft.

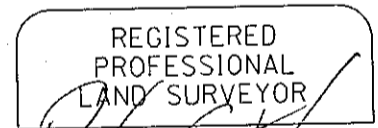

Peter C. Elder

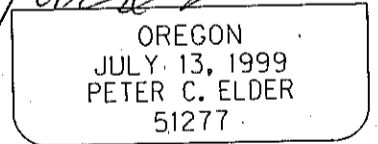

RENEWS: 12/31/2015

Accessories taken using a hand compass set at 19° East declination for bearings, and distance by steeltape for magnet and GPS vector for distance to found pipe.

Witnesses: Ross Hodgson, Peter Elder

I hereby certify that the above corner position was perpetuated as hereon described on December 11, 2013.

FILED Aug. 5, 2014
BAKER COUNTY SURVEYOR
SURVEY NO. 13-44-32

 OREGON DEPARTMENT OF TRANSPORTATION RIGHT OF WAY ENGINEERING MONUMENTATION RECORD	Section	Weatherby - Lime		
	Highway	Interstate 84, Old Oregon Trail		
	County	Baker	Scale	NTS
	Purpose	Quarry	Date	April 22, 2014
	File			