

# RECORD OF LAND CORNER MONUMENTATION

**CORNER:** EAST 1/4 COR. SECTION 13, TWP. 13 S., RANGE 36 E., W.M.

**ORIGINAL SURVEY BY:** Eugene P. McCornack, U.S. Deputy Surveyor

**CONTRACT NUMBER:** 398

**CONTRACT DATE:** July 2, 1881

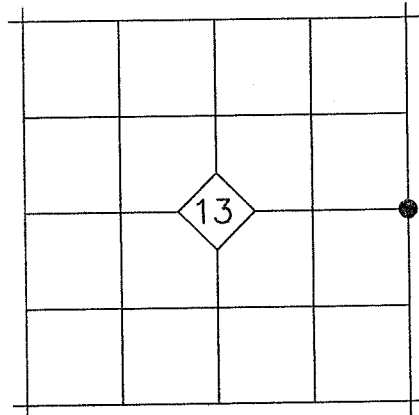

**ORIGINAL DESCRIPTION:** Set Basalt stone 16x7x7 ins, 11 ins in the ground for 1/4 Sec. Cor Marked 1/4S on W face and raised a mound of stone alongside. Pits impracticable.

**EVIDENCE FOUND:** After a diligent search, I found no remaining evidence of the corner. The search area falls on the south side of the county road, where the original monument would have been subject to destruction as a result of road and fence construction. Do to the alignment of the county road and the available records pertaining to its establishment, I do not believe it was ever the intent that the road be centered on the 1/4 Corner. See the Map of Survey filed in conjunction with this monumentation sheet for more details. With a lack of local evidence of the corner location, I declare this corner lost and reestablish its position by single proportionate measurement between the found monument at the NE Corner Section 1, and the monument established at the SE Corner Section 13.

## DESCRIPTION OF MONUMENTS AND ACCESSORIES SET AND METHODS USED:

At the corner location, as determined by survey, I set a 5/8"x30" iron pin 28" in the ground, with attached 2-1/2" aluminum cap. Cap is marked as shown below. Raised a 2 foot mound of stone to top of cap.

## From which, I SET THE FOLLOWING NEW REFERENCE POINTS:

- ▶ A 5/8"x30" iron pin bears N.82°57'E., 50.19 ft. with attached yellow plastic cap marked BENCHMARK SURVEYING, set in a right of way fence.
- ▶ A 5/8"x30" iron pin bears S.00°27'E., 43.74 ft. with attached yellow plastic cap marked BENCHMARK SURVEYING, set in a right of way fence.
- ▶ A 5/8"x30" iron pin bears N.78°56'W., 40.73 ft. with attached yellow plastic cap marked BENCHMARK SURVEYING, set in a right of way fence.
- ▶ A 5/8"x30" iron pin bears N.02°16'W., 78.07 ft. with attached yellow plastic cap marked BENCHMARK SURVEYING.

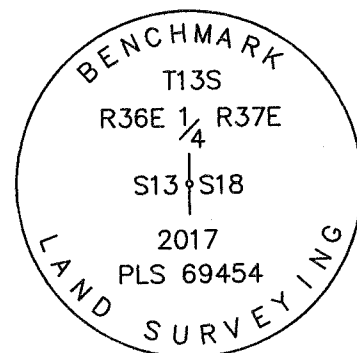

Used RTK GPS to measure the reference points. Bearings are based on Geodetic North determined by GPS observation at the SW Corner Section 13, T.13S., R.36E.

## RESTORATION BY, STAMP AND DATE:

Work Performed April 28, 2017 by:

Jason L. Hatfield, PLS

BENCHMARK LAND SURVEYING, INC.  
1207 Dewey Avenue  
Baker City, OR 97814  
(541) 523-5852  
www.benchmarkls.com

FILED May 9, 2017  
BAKER COUNTY SURVEYOR  
SURVEY NO. 13-36-91  
13-37-34

REGISTERED  
PROFESSIONAL  
LAND SURVEYOR

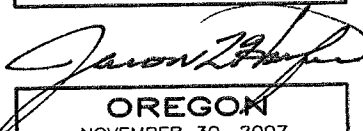
  
OREGON  
NOVEMBER 30, 2007  
JASON L. HATFIELD  
#69454

EXPIRES: 6/30/2017

L-25/L-1