

# RECORD OF LAND CORNER MONUMENTATION

**CORNER:** SOUTH 1/4 COR. SECTION 13, TWP. 13 S., RANGE 36 E., W.M.

**ORIGINAL SURVEY BY:** Eugene P. McCornack, U.S. Deputy Surveyor

**CONTRACT NUMBER:** 398

**CONTRACT DATE:** July 2, 1881

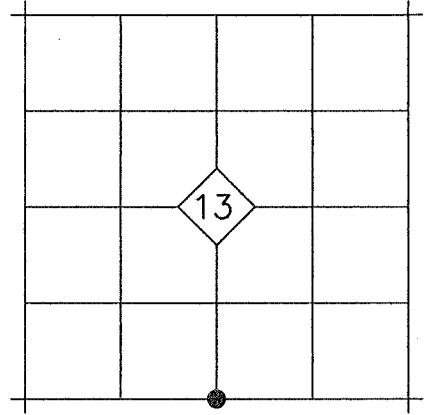

**ORIGINAL DESCRIPTION:** Set Basalt stone 18x12x7 ins, 12 ins in the ground for 1/4 Sec. Cor marked 1/4 on N face and raised a mound of stone alongside.

**EVIDENCE FOUND:** The original monument was not found. According to the field notes in Baker County Surveyor's Record Book 1, page 55, and the associated map on page 28, the old county road ran to the 1/4 Corner. Furthermore, an unrecorded map by Hanley Engineering dated October 1970 of the county road confirms that although much of the county road was realigned and paved at that time, the alignment of this portion remained unchanged. Baker County Deed No. 70-45-009 also describes the county road running to the 1/4 Corner. Therefore, this corner was determined at the intersection of the center of the existing county road and a long-established fence line running east.

## DESCRIPTION OF MONUMENTS AND ACCESSORIES SET AND METHODS USED:

At the corner location, set a 5/8"x10" iron pin 13" in the ground, with attached 2-1/2" aluminum cap. Cap is marked as shown below. The top of the cap is approximately 3" below the surface of the asphalt.

## From which, I SET THE FOLLOWING NEW REFERENCE POINTS:

- ▶ A 5/8"x30" iron pin bears N.49°29'E., 39.24 ft. with attached yellow plastic cap marked BENCHMARK SURVEYING, set in a right of way fence.
- ▶ A 5/8"x30" iron pin bears S.52°02'E., 40.60ft. with attached yellow plastic cap marked BENCHMARK SURVEYING, set in a right of way fence.
- ▶ A 5/8"x30" iron pin bears S.44°10'W., 36.62 ft. with attached yellow plastic cap marked BENCHMARK SURVEYING, set in a right of way fence.
- ▶ A 5/8"x30" iron pin bears N.55°03'W., 32.70 with attached yellow plastic cap marked BENCHMARK SURVEYING, set in a right of way fence.

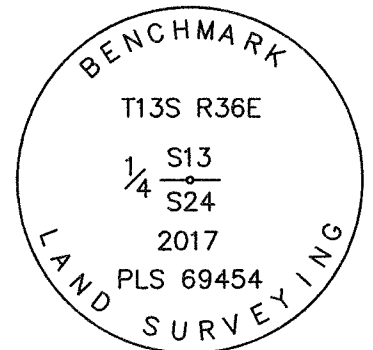

Used RTK GPS to measure the reference points. Bearings are based on Geodetic North determined by GPS observation at the SW Corner Section 13, T.13S., R.36E.

## RESTORATION BY, STAMP AND DATE:

Work Performed April 21, 2017 by:

Jason L. Hatfield, PLS  
Michael C. Springer, PLS

BENCHMARK LAND SURVEYING, INC.  
1207 Dewey Avenue  
Baker City, OR 97814  
(541) 523-5852  
www.benchmarkls.com

FILED May 9, 2017  
BAKER COUNTY SURVEYOR  
SURVEY NO. 13-36-92

REGISTERED  
PROFESSIONAL  
LAND SURVEYOR

