

RECORD OF LAND CORNER MONUMENTATION

CORNER: NORTHWEST COR. SEC. 13, TWP. 13 S., RANGE 36 E., W.M.

ORIGINAL SURVEY BY: Eugene P. McCornack, U.S. Deputy Surveyor

CONTRACT NUMBER: 398

CONTRACT DATE: July 2, 1881

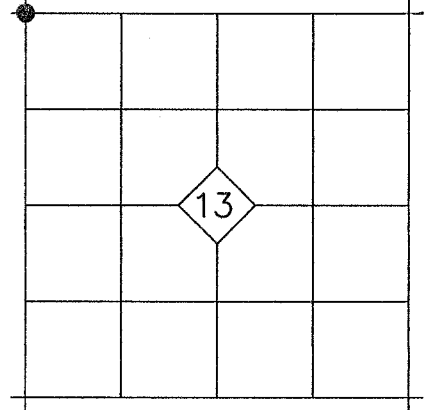

ORIGINAL DESCRIPTION: *Set Basalt stone 24x12x6 ins, 18 ins in the ground for Cor to secs 11, 12, 13 and 14 marked with 4 notches on the S and 1 notch on E edges and raised a mound of stone alongside. Pits impracticable.*

EVIDENCE FOUND: Found a basalt stone measuring 22"X12"X5" marked with 4 grooves on one face and 1 groove on adjacent edge in an old rock jack in an east-west fence.

DESCRIPTION OF MONUMENTS AND ACCESSORIES SET AND METHODS USED:

At the location of the found stone, set a 1-1/2"x30" galvanized iron pipe with attached 2-1/2" brass cap 26" in the ground. Cap is marked as shown below. Deposited marked stone south and alongside, and raised a 3 foot mound of stone to top of cap.

From which, I SET THE FOLLOWING NEW REFERENCE POINTS:

- ▶ A 5/8"x30" iron pin bears N.41°37'E., 39.57 ft. with attached yellow plastic cap marked BENCHMARK SURVEYING.
- ▶ A 5/8"x30" iron pin bears S.41°10'W., 29.25 ft. with attached yellow plastic cap marked BENCHMARK SURVEYING.
- ▶ A 5/8"x30" iron pin bears N.33°20'W., 36.62 ft. with attached yellow plastic cap marked BENCHMARK SURVEYING.

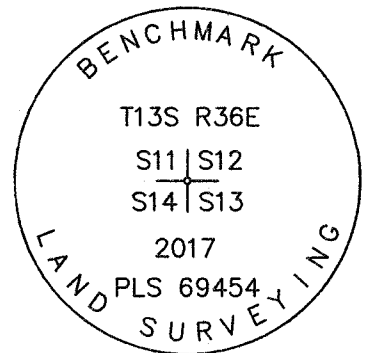

I ALSO SCRIBE A NEW BEARING TREE:

- ▶ A 14" diameter juniper bears S.83°38'E., 53.2 ft. marked *T13S R36E S13 BT*

Used RTK GPS to measure the reference points. Distance to BT was measured using a steel tape, measuring to a 20d nail driven in the side-center at the root crown of the tree. Attached a BT tag to the tree. Bearings are based on Geodetic North determined by GPS observation at the SW Corner Section 13, T.13S., R.36E.

RESTORATION BY, STAMP AND DATE:

Work Performed April 21, 2017 by:

Jason L. Hatfield, PLS
Michael C. Springer, PLS

BENCHMARK LAND SURVEYING, INC.
1207 Dewey Avenue
Baker City, OR 97814
(541) 523-5852
www.benchmarkpls.com

FILED May 9, 2017
BAKER COUNTY SURVEYOR
SURVEY NO. 13-36-86

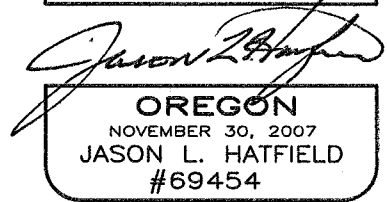
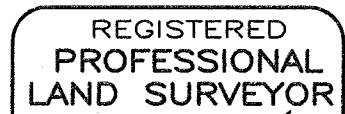

EXPIRES: 6/30/2017