

RECORD OF LAND CORNER MONUMENTATION

CORNER: SOUTHEAST COR. SECTION 13, TWP. 13 S., RANGE 36 E., W.M.

ORIGINAL SURVEY BY: Eugene P. McCornack, U.S. Deputy Surveyor

CONTRACT NUMBER: 398

CONTRACT DATE: July 2, 1881

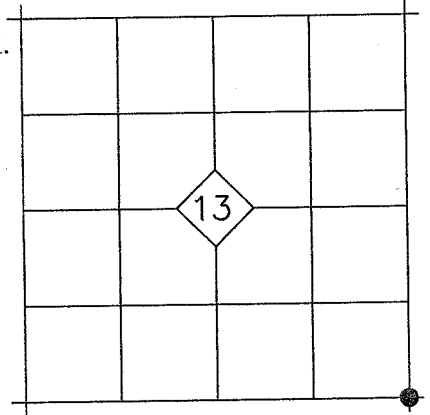

ORIGINAL DESCRIPTION: Set Basalt stone 16X14X5 ins, 11 ins in the ground for cor to secs 13, 18, 19 and 24 and marked with 3 notches on N and S edges and raised a mound of stone alongside. Pits impracticable.

EVIDENCE FOUND: The original stone was not recovered. All the stones in the immediate vicinity have been placed in nearby rock jacks. The intersection of long established fences running North, East, South and West is accepted as the best available evidence of the original corner location, which fits harmoniously with other known corners in the area.

DESCRIPTION OF MONUMENTS AND ACCESSORIES SET AND METHODS USED:

At the corner location, I set a 5/8"x30" iron pin 30" in the ground, with attached 2-1/2" aluminum cap. Cap is marked as shown below.

From which, I SET THE FOLLOWING NEW REFERENCE POINTS:

- ▶ A 5/8"x30" iron pin bears S.87°25'E., 35.38 ft. with attached yellow plastic cap marked BENCHMARK SURVEYING, set in an East-West fence.
- ▶ A 5/8"x30" iron pin bears S.01°00'W., 16.74 ft. with attached yellow plastic cap marked BENCHMARK SURVEYING, set in a North-South fence.
- ▶ A 5/8"x30" iron pin bears S.88°06'W., 22.48 ft. with attached yellow plastic cap marked BENCHMARK SURVEYING, set in an East-West fence.
- ▶ A 5/8"x30" iron pin bears N.00°45'W., 29.80 ft. with attached yellow plastic cap marked BENCHMARK SURVEYING, set in a North-South fence.

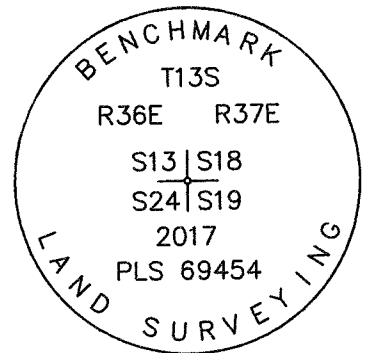

Used RTK GPS to measure the reference points. Bearings are based on Geodetic North determined by GPS observation at the SW Corner Section 13, T.13S., R.36E.

RESTORATION BY, STAMP AND DATE:

Work Performed April 21, 2017 by:

Jason L. Hatfield, PLS
Michael C. Springer, PLS

BENCHMARK LAND SURVEYING, INC.
1207 Dewey Avenue
Baker City, OR 97814
(541) 523-5852
www.benchmarkls.com

FILED May 9, 2017
BAKER COUNTY SURVEYOR
SURVEY NO. 13-36-93
13-37-35

REGISTERED
PROFESSIONAL
LAND SURVEYOR

OREGON
NOVEMBER 30, 2007
JASON L. HATFIELD
#69454

EXPIRES: 6/30/2017

N-25/N-1