

RECORD OF LAND CORNER MONUMENTATION

CORNER: NORTHEAST COR. SECTION 13, TWP. 13 S., RANGE 36 E., W.M.

ORIGINAL SURVEY BY: Eugene P. McCornack, U.S. Deputy Surveyor

CONTRACT NUMBER: 398

CONTRACT DATE: July 2, 1881

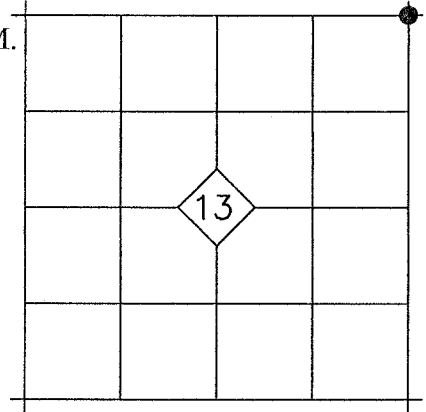

ORIGINAL DESCRIPTION: Set Basalt stone 14X10X8 ins, 10 ins in the ground for cor to secs 7, 12, 13 and 18 and marked with 2 notches on N and 4 notches on South edges and raised a mound of stone alongside. Pits impracticable.

EVIDENCE FOUND: The corner falls in the middle of a pasture, where there is no remaining evidence of the original monument. I declare this corner lost, and reestablish its position by single proportionate measurement between found monument at the NE Corner Section 1 and the established monument at the SE Corner Section 13.

DESCRIPTION OF MONUMENTS AND ACCESSORIES SET AND METHODS USED:

At the recommendation of Bill Moore, landowner, we did not monument the position due to the likelihood of it being destroyed by future plowing.

From the calculated corner position, **I SET THE FOLLOWING REFERENCE MONUMENTS:**

- ▶ A 5/8"x30" iron pin, set along a fenceline, bears N.77°52'59"E., 374.91ft. with attached aluminum cap marked as shown:

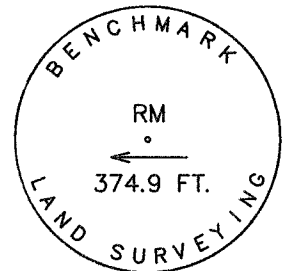

- ▶ A 5/8"x30" iron pin, set on the north side of a rock gabion gate support, bears S.31°48'45"E., 400.78ft. with attached aluminum cap marked as shown:

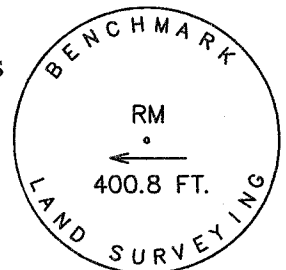

Used RTK GPS to measure the reference monuments. Bearings are based on Geodetic North determined by GPS observation at the SW Corner Section 13, T.13S., R.36E.

RESTORATION BY, STAMP AND DATE:

Work Performed April 21, 2017 by:

Jason L. Hatfield, PLS
Michael C. Springer, PLS

BENCHMARK LAND SURVEYING, INC.
1207 Dewey Avenue
Baker City, OR 97814
(541) 523-5852
www.benchmarkls.com

FILED May 9, 2017
BAKER COUNTY SURVEYOR
SURVEY NO. 13-36-87
13-37-33

