

RECORD OF LAND CORNER MONUMENTATION

CORNER: NORTHWEST COR. SEC. 13, TWP. 13 S., RANGE 36 E., W.M.

ORIGINAL SURVEY BY: Eugene P. McCormack, U.S. Deputy Surveyor

CONTRACT NUMBER: 398

CONTRACT DATE: July 2, 1881

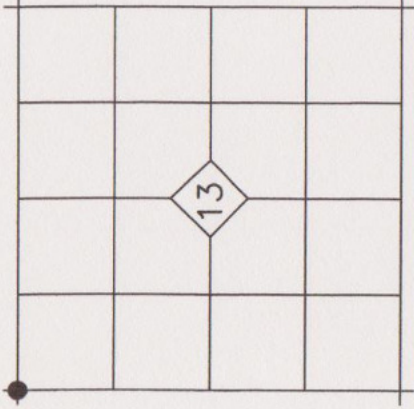

ORIGINAL DESCRIPTION: Set Basalt stone 24x12x6 ins, 18 ins in the ground for Cor to secs 11, 12, 13 and 14 marked with 4 notches on the S and 1 notch on E edges and raised a mound of stone alongside. Pits impracticable.

EVIDENCE FOUND: Found a basalt stone measuring 22"X12"X5" marked with 4 grooves on one face and 1 groove on adjacent edge in an old rock jack in an east-west fence.

DESCRIPTION OF MONUMENTS AND ACCESSORIES SET AND METHODS USED:

At the location of the found stone, set a 1-1/2"x30" galvanized iron pipe with attached 2-1/2" brass cap 26" in the ground. Cap is marked as shown below. Deposited marked stone south and alongside, and raised a 3 foot mound of stone to top of cap.

From which, I SET THE FOLLOWING NEW REFERENCE POINTS:

- ▶ A 5/8"x30" iron pin bears N.41°37'E., 39.57 ft. with attached yellow plastic cap marked BENCHMARK SURVEYING.
- ▶ A 5/8"x30" iron pin bears S.41°10'W., 29.25 ft. with attached yellow plastic cap marked BENCHMARK SURVEYING.
- ▶ A 5/8"x30" iron pin bears N.33°20'W., 36.62 ft. with attached yellow plastic cap marked BENCHMARK SURVEYING.

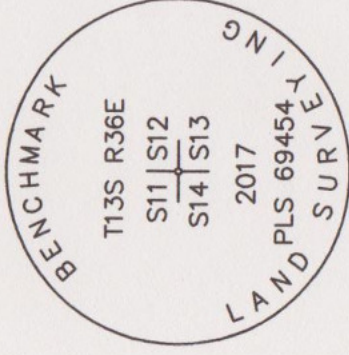

I ALSO SCRIBE A NEW BEARING TREE:

- ▶ A 14" diameter juniper bears S.83°38'E., 53.2 ft. marked T13S R36E S13 BT

Used RTK GPS to measure the reference points. Distance to BT was measured using a steel tape, measuring to a 20d nail driven in the side-center at the root crown of the tree. Attached a BT tag to the tree. Bearings are based on Geodetic North determined by GPS observation at the SW Corner Section 13, T.13S., R.36E.

RESTORATION BY, STAMP AND DATE:

Work Performed April 21, 2017 by:

Jason L. Hatfield, PLS
Michael C. Springer, PLS

BENCHMARK LAND SURVEYING, INC.

1207 Dewey Avenue
Baker City, OR 97814
(541) 523-5852

www.benchmarkls.com



Jason L. Hatfield
OREGON
NOVEMBER 30, 2007
JASON L. HATFIELD
#69454

FILED May 9, 2017
BAKER COUNTY SURVEYOR
SURVEY NO. 13-36-86

EXPIRES: 6/30/2017

RECORD OF LAND CORNER MONUMENTATION

CORNER: NORTHEAST COR. SECTION 13, TWP. 13 S., RANGE 36 E., W.M.

ORIGINAL SURVEY BY: Eugene P. McCormack, U.S. Deputy Surveyor

CONTRACT NUMBER: 398

CONTRACT DATE: July 2, 1881

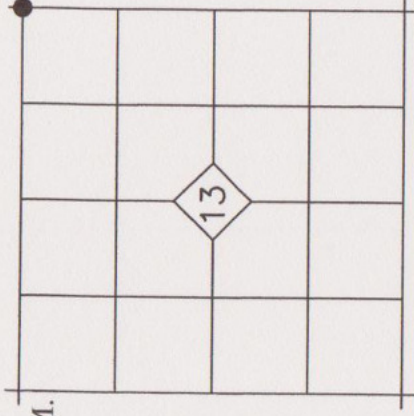

ORIGINAL DESCRIPTION: *Set Basalt stone 14X10X8 ins, 10 ins in the ground for cor to secs 7, 12, 13 and 18 and marked with 2 notches on N and 4 notches on South edges and raised a mound of stone alongside. Pits impracticable.*

EVIDENCE FOUND: The corner falls in the middle of a pasture, where there is no remaining evidence of the original monument. I declare this corner lost, and reestablish its position by single proportionate measurement between found monument at the NE Corner Section 1 and the established monument at the SE Corner Section 13.

DESCRIPTION OF MONUMENTS AND ACCESSORIES SET AND METHODS USED:

At the recommendation of Bill Moore, landowner, we did not monument the position due to the likelihood of it being destroyed by future plowing.

From the calculated corner position, **I SET THE FOLLOWING REFERENCE MONUMENTS:**

- ▶ A 5/8"x30" iron pin, set along a fenceline, bears N.77°52'59"E., 374.91ft.

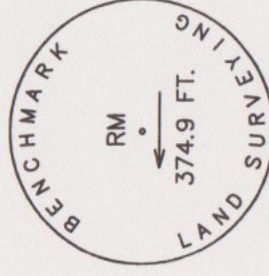

- ▶ A 5/8"x30" iron pin, set on the north side of a rock gabion gate support, bears S.31°48'45"E., 400.78ft. with attached aluminum cap marked as shown:

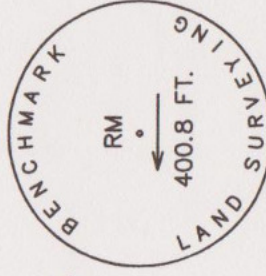

Used RTK GPS to measure the reference monuments. Bearings are based on Geodetic North determined by GPS observation at the SW Corner Section 13, T.13S., R.36E.

RESTORATION BY, STAMP AND DATE:

Work Performed April 21, 2017 by:

Jason L. Hatfield, PLS
Michael C. Springer, PLS

BENCHMARK LAND SURVEYING, INC.

1207 Dewey Avenue
Baker City, OR 97814
(541) 523-5852
www.benchmarkls.com

FILED *May 9, 2017*
BAKER COUNTY SURVEYOR
SURVEY NO. *13-36-87*
13-37-33

REGISTERED
PROFESSIONAL
LAND SURVEYOR

Jason L. Hatfield
OREGON
NOVEMBER 30, 2007
JASON L. HATFIELD
#69454

EXPIRES: 6/30/2017

J-25/J-1

RECORD OF LAND CORNER MONUMENTATION

CORNER: NE 1/16 COR. SEC. 13, TWP. 13 S., RANGE 36 E., W.M.

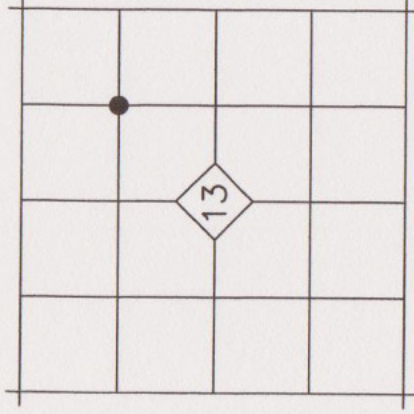

(CORNER NOT PREVIOUSLY ESTABLISHED)

ORIGINAL DESCRIPTION: N/A

EVIDENCE FOUND: N/A

DESCRIPTION OF MONUMENTS AND ACCESSORIES SET AND METHODS USED:

At the corner point, as determined by survey, I set a 5/8"x30" iron pin with attached 2" aluminum cap 30" in the ground. Cap is marked as shown below.

From which, I SET THE FOLLOWING NEW REFERENCE POINTS:

- ▶ A 5/8"x30" iron pin bears N.47°07'E., 26.25 ft. with attached yellow plastic cap marked BENCHMARK SURVEYING.
- ▶ A 5/8"x30" iron pin bears S.59°28'E., 28.96 ft. with attached yellow plastic cap marked BENCHMARK SURVEYING.

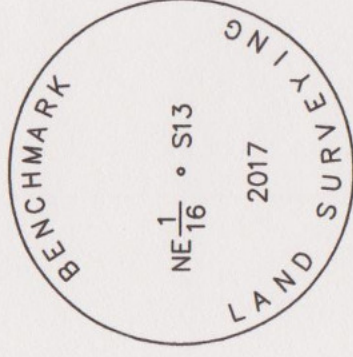

Used RTK GPS to measure the reference points. Bearings are based on Geodetic North determined by GPS observation at the SW Corner Section 13, T.13S., R.36E.

RESTORATION BY, STAMP AND DATE:

Work Performed April 28, 2017 by:

Jason L. Hatfield, PLS

BENCHMARK LAND SURVEYING, INC.

1207 Dewey Avenue
Baker City, OR 97814
(541) 523-5852
www.benchmarkls.com

FILED *May 9, 2017*
BAKER COUNTY SURVEYOR
SURVEY NO. *13-36-88*

REGISTERED
PROFESSIONAL
LAND SURVEYOR

Jason L. Hatfield
OREGON
NOVEMBER 30, 2007
JASON L. HATFIELD
#69454

EXPIRES: 6/30/2017

RECORD OF LAND CORNER MONUMENTATION

CORNER: WEST 1/4 COR. SECTION 13, TWP. 13 S., RANGE 36 E., W.M.

ORIGINAL SURVEY BY: Eugene P. McCornack, U.S. Deputy Surveyor

CONTRACT NUMBER: 398

CONTRACT DATE: July 2, 1881

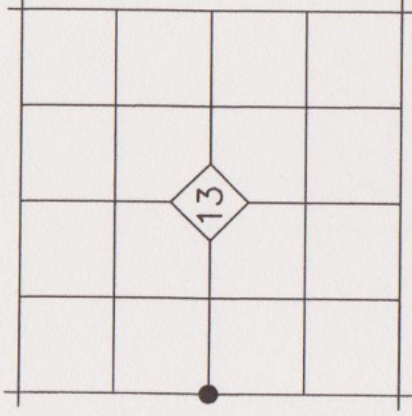

ORIGINAL DESCRIPTION: *Set Basalt stone 20x16x6 ins, 15 ins in the ground for 1/4 Sec. Cor marked 1/4 on W face and raised a mound of stone alongside. Pits impracticable.*

EVIDENCE FOUND: The original marked stone was not found, but I did find a man-made mound of stone, approximately 2 ft. diameter. Ancient remains of a fence extend east from this location. The northing position of this mound is harmoniously related to found monuments at the NW and SW corners of Section 13. I accept the mound of stone as the best available evidence of the 1/4 Corner.

DESCRIPTION OF MONUMENTS AND ACCESSORIES SET AND METHODS USED:

In the center of the found mound of stone, set a 5/8"x30" iron pin 20" in the ground, with attached 2-1/2" aluminum cap. Cap is marked as shown below.

From which, I SET THE FOLLOWING NEW REFERENCE POINTS:

- ▶ A 5/8"x15" iron pin, driven to bedrock, bears S.82°13'E., 12.31ft. with attached yellow plastic cap marked BENCHMARK SURVEYING.
- ▶ A 5/8"x15" iron pin, driven to bedrock, bears S.10°25'W., 21.23 ft. with attached yellow plastic cap marked BENCHMARK SURVEYING.
- ▶ A 5/8"x15" iron pin, driven to bedrock, bears N.01°24'W., 14.35 ft. with attached yellow plastic cap marked BENCHMARK SURVEYING.

I ALSO SCRIBE A NEW BEARING TREE:

- ▶ A double-trunk juniper, the southerly trunk of which is 12" in diameter and bears N.77°08'W., 29.5 ft., and is marked 1/4 S14 BT

Used RTK GPS to measure the reference points. Distance to BT was measured using a steel tape, measuring to a 20d nail driven in the side-center at the root crown of the tree. Attached a BT tag to the tree. Bearings are based on Geodetic North determined by GPS observation at the SW Corner Section 13, T.13S., R.36E.

RESTORATION BY, STAMP AND DATE:

Work Performed April 21, 2017 by:

Jason L. Hatfield, PLS
Michael C. Springer, PLS

BENCHMARK LAND SURVEYING, INC.

1207 Dewey Avenue
Baker City, OR 97814
(541) 523-5852

www.benchmarkls.com

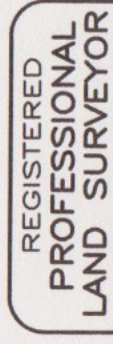

Jason L. Hatfield
OREGON
NOVEMBER 30, 2007
JASON L. HATFIELD
#69454

EXPIRES: 6/30/2017

FILED *May 9, 2017*
BAKER COUNTY SURVEYOR
SURVEY NO. *13-36-89*

RECORD OF LAND CORNER MONUMENTATION

CORNER: C-E 1/16 COR. SEC. 13, TWP. 13 S., RANGE 36 E., W.M.

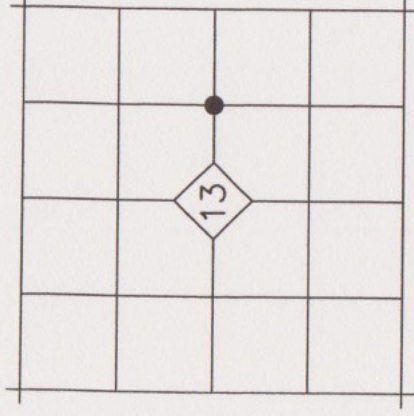

(CORNER NOT PREVIOUSLY ESTABLISHED)

ORIGINAL DESCRIPTION: N/A

EVIDENCE FOUND: N/A

DESCRIPTION OF MONUMENTS AND ACCESSORIES SET AND METHODS USED:

At the corner point, as determined by survey, I set a 1-1/2" long Mag Nail in a concrete pad.

From which, I SET THE FOLLOWING NEW REFERENCE POINTS:

- ▶ A 5/8"x30" iron pin bears N.71°18'E., 14.90 ft. with attached yellow plastic cap marked BENCHMARK SURVEYING.
- ▶ A 5/8"x30" iron pin bears S.05°42'W., 19.37 ft. with attached yellow plastic cap marked BENCHMARK SURVEYING.

Used RTK GPS to measure the reference points. Bearings are based on Geodetic North determined by GPS observation at the SW Corner Section 13, T.13S., R.36E.

RESTORATION BY, STAMP AND DATE:

Work Performed April 28, 2017 by:

Jason L. Hatfield, PLS

BENCHMARK LAND SURVEYING, INC.

1207 Dewey Avenue
Baker City, OR 97814
(541) 523-5852
www.benchmarkls.com

REGISTERED
PROFESSIONAL
LAND SURVEYOR

Jason L. Hatfield

OREGON
NOVEMBER 30, 2007
JASON L. HATFIELD
#69454

EXPIRES: 6/30/2017

FILED May 9, 2017
BAKER COUNTY SURVEYOR
SURVEY NO. 13-36-90

RECORD OF LAND CORNER MONUMENTATION

CORNER: EAST 1/4 COR. SECTION 13, TWP. 13 S., RANGE 36 E., W.M.

ORIGINAL SURVEY BY: Eugene P. McCormack, U.S. Deputy Surveyor

CONTRACT NUMBER: 398

CONTRACT DATE: July 2, 1881

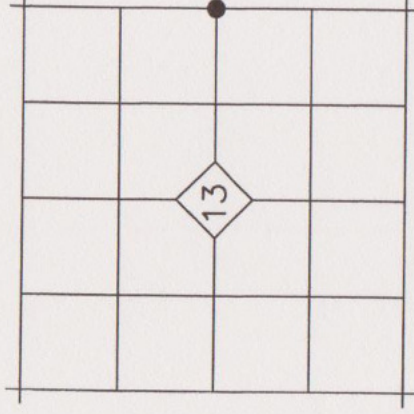

ORIGINAL DESCRIPTION: *Set Basalt stone 16x7x7 ins, 11 ins in the ground for 1/4 Sec. Cor Marked 1/4S on W face and raised a mound of stone alongside. Pits impracticable.*

EVIDENCE FOUND: After a diligent search, I found no remaining evidence of the corner. The search area falls on the south side of the county road, where the original monument would have been subject to destruction as a result of road and fence construction. Do to the alignment of the county road and the available records pertaining to its establishment, I do not believe it was ever the intent that the road be centered on the 1/4 Corner. See the Map of Survey filed in conjunction with this monumentation sheet for more details. With a lack of local evidence of the corner location, I declare this corner lost and reestablish its position by single proportionate measurement between the found monument at the NE Corner Section 1, and the monument established at the SE Corner Section 13.

DESCRIPTION OF MONUMENTS AND ACCESSORIES SET AND METHODS USED:

At the corner location, as determined by survey, I set a 5/8"x30" iron pin 28" in the ground, with attached 2-1/2" aluminum cap. Cap is marked as shown below. Raised a 2 foot mound of stone to top of cap.

From which, I SET THE FOLLOWING NEW REFERENCE POINTS:

- ▶ A 5/8"x30" iron pin bears N.82°57'E., 50.19 ft. with attached yellow plastic cap marked BENCHMARK SURVEYING, set in a right of way fence.
- ▶ A 5/8"x30" iron pin bears S.00°27'E., 43.74 ft. with attached yellow plastic cap marked BENCHMARK SURVEYING, set in a right of way fence.
- ▶ A 5/8"x30" iron pin bears N.78°56'W., 40.73 ft. with attached yellow plastic cap marked BENCHMARK SURVEYING, set in a right of way fence.
- ▶ A 5/8"x30" iron pin bears N.02°16'W., 78.07 ft. with attached yellow plastic cap marked BENCHMARK SURVEYING.

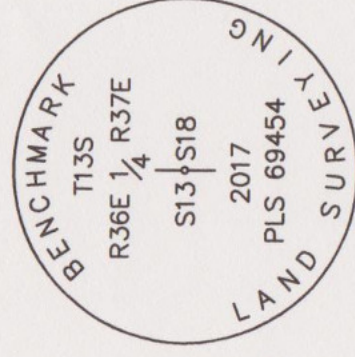

Used RTK GPS to measure the reference points. Bearings are based on Geodetic North determined by GPS observation at the SW Corner Section 13, T.13S., R.36E.

RESTORATION BY, STAMP AND DATE:

Work Performed April 28, 2017 by:

Jason L. Hatfield, PLS

BENCHMARK LAND SURVEYING, INC.

1207 Dewey Avenue
Baker City, OR 97814
(541) 523-5852

www.benchmarkls.com

REGISTERED
PROFESSIONAL
LAND SURVEYOR

Jason L. Hatfield
OREGON
NOVEMBER 30, 2007
JASON L. HATFIELD
#69454

EXPIRES: 6/30/2017

FILED *May 9, 2017*

BAKER COUNTY SURVEYOR

SURVEY NO. *13-36-91*

13-37-34

L-25/L-1

RECORD OF LAND CORNER MONUMENTATION

CORNER: SOUTH 1/4 COR. SECTION 13, TWP. 13 S., RANGE 36 E., W.M.

ORIGINAL SURVEY BY: Eugene P. McCormack, U.S. Deputy Surveyor

CONTRACT NUMBER: 398

CONTRACT DATE: July 2, 1881

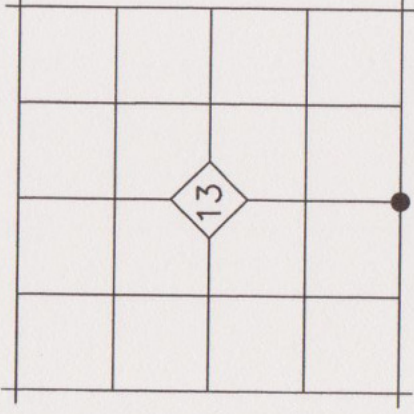

ORIGINAL DESCRIPTION: *Set Basalt stone 18x12x7 ins, 12 ins in the ground for 1/4 Sec. Cor marked 1/4 on N face and raised a mound of stone alongside.*

EVIDENCE FOUND: The original monument was not found. According to the field notes in Baker County Surveyor's Record Book 1, page 55, and the associated map on page 28, the old county road ran to the 1/4 Corner. Furthermore, an unrecorded map by Hanley Engineering dated October 1970 of the county road confirms that although much of the county road was realigned and paved at that time, the alignment of this portion remained unchanged. Baker County Deed No. 70-45-009 also describes the county road running to the 1/4 Corner. Therefore, this corner was determined at the intersection of the center of the existing county road and a long-established fence line running east.

DESCRIPTION OF MONUMENTS AND ACCESSORIES SET AND METHODS USED:

At the corner location, set a 5/8"x10" iron pin 13" in the ground, with attached 2-1/2" aluminum cap. Cap is marked as shown below. The top of the cap is approximately 3" below the surface of the asphalt.

From which, I SET THE FOLLOWING NEW REFERENCE POINTS:

- ▶ A 5/8"x30" iron pin bears N.49°29'E., 39.24 ft. with attached yellow plastic cap marked BENCHMARK SURVEYING, set in a right of way fence.
- ▶ A 5/8"x30" iron pin bears S.52°02'E., 40.60ft. with attached yellow plastic cap marked BENCHMARK SURVEYING, set in a right of way fence.
- ▶ A 5/8"x30" iron pin bears S.44°10'W., 36.62 ft. with attached yellow plastic cap marked BENCHMARK SURVEYING, set in a right of way fence.
- ▶ A 5/8"x30" iron pin bears N.55°03'W., 32.70 with attached yellow plastic cap marked BENCHMARK SURVEYING, set in a right of way fence.

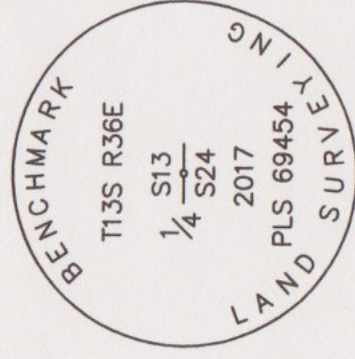

Used RTK GPS to measure the reference points. Bearings are based on Geodetic North determined by GPS observation at the SW Corner Section 13, T.13S., R.36E.

RESTORATION BY, STAMP AND DATE:

Work Performed April 21, 2017 by:

Jason L. Hatfield, PLS
Michael C. Springer, PLS

BENCHMARK LAND SURVEYING, INC.

1207 Dewey Avenue
Baker City, OR 97814
(541) 523-5852

www.benchmarkls.com

REGISTERED
PROFESSIONAL
LAND SURVEYOR

Jason L. Hatfield
OREGON
NOVEMBER 30, 2007
JASON L. HATFIELD
#69454

FILED *May 9 2017*
BAKER COUNTY SURVEYOR
SURVEY NO. *13-36-92*

EXPIRES: 6/30/2017

RECORD OF LAND CORNER MONUMENTATION

CORNER: SOUTHEAST COR. SECTION 13, TWP. 13 S., RANGE 36 E., W.M.

ORIGINAL SURVEY BY: Eugene P. McCormack, U.S. Deputy Surveyor

CONTRACT NUMBER: 398

CONTRACT DATE: July 2, 1881

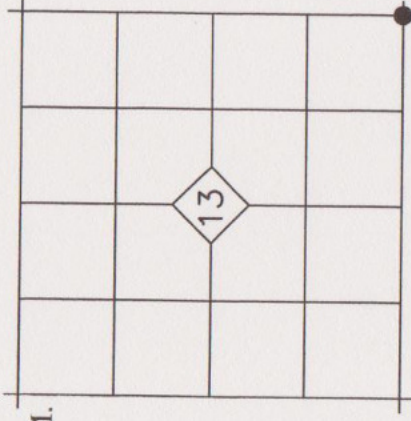

ORIGINAL DESCRIPTION: Set Basalt stone 16X14X5 ins, 11 ins in the ground for cor to secs 13, 18, 19 and 24 and marked with 3 notches on N and S edges and raised a mound of stone alongside. Pits impracticable.

EVIDENCE FOUND: The original stone was not recovered. All the stones in the immediate vicinity have been placed in nearby rock jacks. The intersection of long established fences running North, East, South and West is accepted as the best available evidence of the original corner location, which fits harmoniously with other known corners in the area.

DESCRIPTION OF MONUMENTS AND ACCESSORIES SET AND METHODS USED:

At the corner location, I set a 5/8"x30" iron pin 30" in the ground, with attached 2-1/2" aluminum cap. Cap is marked as shown below.

From which, I SET THE FOLLOWING NEW REFERENCE POINTS:

- ▶ A 5/8"x30" iron pin bears S.87°25'E., 35.38 ft. with attached yellow plastic cap marked BENCHMARK SURVEYING, set in an East-West fence.
- ▶ A 5/8"x30" iron pin bears S.01°00'W., 16.74 ft. with attached yellow plastic cap marked BENCHMARK SURVEYING, set in a North-South fence.
- ▶ A 5/8"x30" iron pin bears S.88°06'W., 22.48 ft. with attached yellow plastic cap marked BENCHMARK SURVEYING, set in an East-West fence.
- ▶ A 5/8"x30" iron pin bears N.00°45'W., 29.80 ft. with attached yellow plastic cap marked BENCHMARK SURVEYING, set in a North-South fence.

Used RTK GPS to measure the reference points. Bearings are based on Geodetic North determined by GPS observation at the SW Corner Section 13, T.13S., R.36E.

RESTORATION BY, STAMP AND DATE:

Work Performed April 21, 2017 by:

Jason L. Hatfield, PLS
Michael C. Springer, PLS

BENCHMARK LAND SURVEYING, INC.
1207 Dewey Avenue
Baker City, OR 97814
(541) 523-5852
www.benchmarkls.com

FILED May 9, 2017
BAKER COUNTY SURVEYOR
SURVEY NO. 13-36-93
13-37-35

REGISTERED
PROFESSIONAL
LAND SURVEYOR

Jason L. Hatfield
OREGON
NOVEMBER 30, 2007
JASON L. HATFIELD
#69454

EXPIRES: 6/30/2017

N-25/N-1

RECORD OF LAND CORNER MONUMENTATION

CORNER: C-S1/16 COR. SECTION 21, TWP. 10 S., RANGE 35 E., W.M.

(CORNER NOT PREVIOUSLY ESTABLISHED)

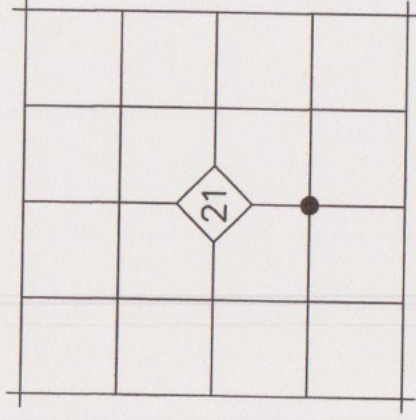

ORIGINAL DESCRIPTION: N/A

EVIDENCE FOUND: N/A

DESCRIPTION OF MONUMENTS AND ACCESSORIES SET AND METHODS USED:

At the corner point, as determined by survey, set a 5/8"x30" iron pin with attached 1 1/2" aluminum cap 30" in the ground. Cap is marked as shown below.

From which, I SET THE FOLLOWING REFERENCE POINT:

- ▶ A 5/8"x30" iron pin bears S.71°28'E., 19.61ft. with attached yellow plastic cap marked BENCHMARK SURVEYING

I also SCRIBED THE FOLLOWING BEARING TREE:

- ▶ A 7.1" dbh lodgepole pine bears N.77°W., 19.83 feet, marked *CS1/16 S21 BT*

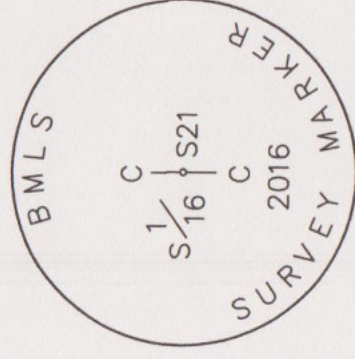

Used RTK GPS to measure the reference point. Used a magnetic compass with 15°E declination to measure the bearing to the tree. Distance measured with a steel tape, measuring to a 20d nail driven at the base of the tree (side center).

RESTORATION BY, STAMP AND DATE:

Work Performed June 30, 2016 by:

Jason L. Hatfield, PLS
Kevin M. Stolfo, Technician

BENCHMARK LAND SURVEYING, INC.

2101 Main Street, Suite 223
Baker City, OR 97814
(800) 699-0516
www.benchmarkls.com

REGISTERED
PROFESSIONAL
LAND SURVEYOR

Jason L. Hatfield
OREGON
NOVEMBER 30, 2007
JASON L. HATFIELD
#69454

EXPIRES: 6/30/2017

FILED July 13, 2016
BAKER COUNTY SURVEYOR
SURVEY NO. 10-35-245

RECORD OF LAND CORNER MONUMENTATION

CORNER: SE1/16 COR. SECTION 21, TWP. 10 S., RANGE 35 E., W.M.
(CORNER NOT PREVIOUSLY ESTABLISHED)

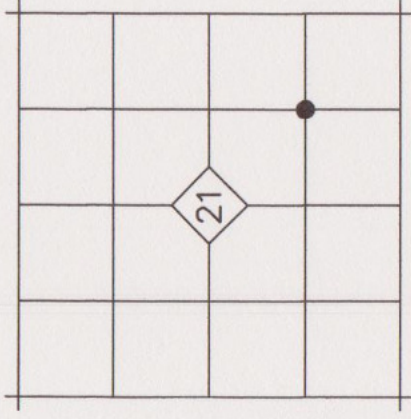

ORIGINAL DESCRIPTION: N/A

EVIDENCE FOUND: N/A

DESCRIPTION OF MONUMENTS AND ACCESSORIES SET AND METHODS USED:

At the corner point, as determined by survey, set a 5/8"x30" iron pin with attached 1 1/2" aluminum cap 30" in the ground. Cap is marked as shown below.

From which, I SET THE FOLLOWING REFERENCE POINT:

- ▶ A 5/8"x30" iron pin bears N.51°05'W., 24.03 ft. with attached yellow plastic cap marked BENCHMARK SURVEYING

I also SCRIBED THE FOLLOWING BEARING TREE:

- ▶ A 5.1" dbh lodgepole pine bears S.88°W., 8.81 feet, marked SE1/16 S21
BT

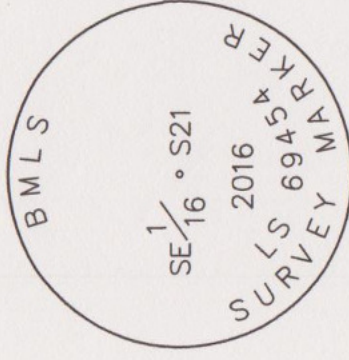

Used RTK GPS to measure the reference point. Used a magnetic compass with 15°E declination to measure the bearing to the tree. Distance measured with a steel tape, measuring to a 20d nail driven at the base of the tree (side center).

RESTORATION BY, STAMP AND DATE:

Work Performed June 30, 2016 by:

Jason L. Hatfield, PLS
Kevin M. Stolfo, Technician

BENCHMARK LAND SURVEYING, INC.

2101 Main Street, Suite 223
Baker City, OR 97814
(800) 699-0516
www.benchmarkls.com

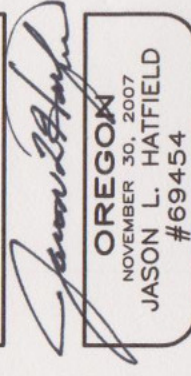

FILED July 13, 2016
BAKER COUNTY SURVEYOR
SURVEY NO. 10-35-246

EXPIRES: 6/30/2017

RECORD OF LAND CORNER MONUMENTATION

CORNER: S1/16 COR. SECTIONS 21 & 22, TWP. 10 S., RANGE 35 E., W.M.

(CORNER NOT PREVIOUSLY ESTABLISHED)

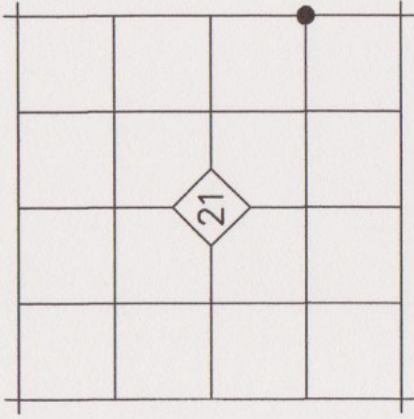

ORIGINAL DESCRIPTION: N/A

EVIDENCE FOUND: N/A

DESCRIPTION OF MONUMENTS AND ACCESSORIES SET AND METHODS USED:

At the corner point, as determined by survey, set a 5/8"x30" iron pin with attached 1 1/2" aluminum cap 30" in the ground. Cap is marked as shown below.

From which, I SET THE FOLLOWING REFERENCE POINTS:

- ▶ A 5/8"x30" iron pin bears S.36°09'E., 15.04 ft. with attached yellow plastic cap marked BENCHMARK SURVEYING
- ▶ A 5/8"x30" iron pin bears N.35°02'W., 14.17 ft. with attached yellow plastic cap marked BENCHMARK SURVEYING

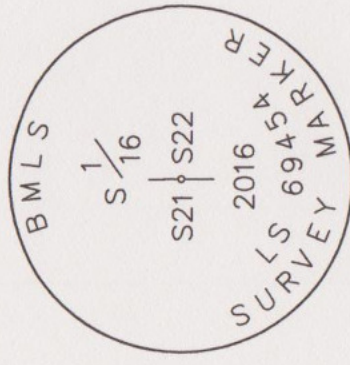

Used RTK GPS to measure the reference points.

RESTORATION BY, STAMP AND DATE:

Work Performed June 30, 2016 by:

Jason L. Hatfield, PLS
Kevin M. Stolfo, Technician

BENCHMARK LAND SURVEYING, INC.

2101 Main Street, Suite 223
Baker City, OR 97814
(800) 699-0516
www.benchmarkls.com



Jason L. Hatfield
OREGON
NOVEMBER 30, 2007
JASON L. HATFIELD
#69454

EXPIRES: 6/30/2017

FILED July 13, 2016
BAKER COUNTY SURVEYOR
SURVEY NO. 10-35-247

RECORD OF LAND CORNER MONUMENTATION

CORNER: CORNER 5 OF R.T. LINCOLN PLACER LOCATED IN SECTION 30, T.11S., R.40E., W.M.

ORIGINAL SURVEY BY: Charles M. Foster, U.S. Deputy Mineral Surveyor

SURVEY NUMBER: Mineral Survey No. 612

INSTRUCTIONS DATED: November 16, 1904

SUBSEQUENT SURVEY: Baker County Survey No. 11-40-78 by William Wells, PLS and William Hanley, PLS, filed January 23, 1987

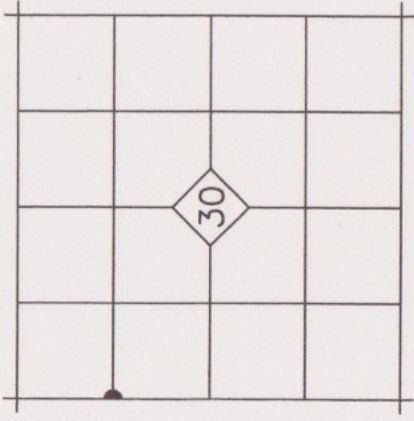

ORIGINAL DESCRIPTION: A pine post 4 ft long 4 ins square, set 18 ins in the ground, surrounded with a mound of earth scribed R.T. Lincoln cor. 5-612. Identical with the S.W. cor of Said Lot No. 1 of sec 30

SURVEY NO. 11-40-78: This corner was not monumented, but was calculated by single proportionate measurement between controlling monuments on the west line of Section 30.

EVIDENCE FOUND: We found no remaining evidence

DESCRIPTION OF MONUMENTS AND ACCESSORIES SET AND METHODS USED:

I reestablished R.T. Lincoln Corner #5 by single proportionate measurement between the found monuments from Survey 11-40-78 at R.T. Lincoln Corner #4 and the West 1/4 corner of Section 30. At the corner point, as located by survey, we set a 5/8"x30" iron pin with attached 2" aluminum cap 28" in the ground. Cap is marked as shown below.

From which, I SET A REFERENCE POINT:

- ▶ A 5/8"x30" iron pin bears N.45°14'W., 42.21 ft. with attached yellow plastic cap marked BENCHMARK SURVEYING

I ALSO SCRIBE A BEARING TREE:

- ▶ A Douglas-fir bears N.20°W., 8.0 ft. marked 5 RTL 612 BT



Used RTK GPS to measure the reference point. Distance to BT was measured with a steel tape, measuring to a 50d nail driven in the side-center at the root crown of the BT. Attached yellow aluminum BT tag to tree.

RESTORATION BY, STAMP AND DATE:

Work Performed August 19, 2016 by:

Jason L. Hatfield, PLS
Marcus R. Teague, Technician

BENCHMARK LAND SURVEYING, INC.

2101 Main Street
Baker City, OR 97814
(800) 699-0516
www.benchmarkls.com

FILED August 29 2016

BAKER COUNTY SURVEYOR

SURVEY NO. 11-39-193

11-40-256

REGISTERED
PROFESSIONAL
LAND SURVEYOR

Jason L. Hatfield
OREGON
NOVEMBER 30, 2007
JASON L. HATFIELD
#69454

EXPIRES: 6/30/2017

RECORD OF LAND CORNER MONUMENTATION

CORNER: NORTH 1/4 COR. SECTION 6, TWP. 7 S., RANGE 39 E., W.M.

ORIGINAL SURVEY BY: Timothy W. Davenport, U.S. Deputy Surveyor

CONTRACT NUMBER: 102

CONTRACT DATE: July 20, 1863

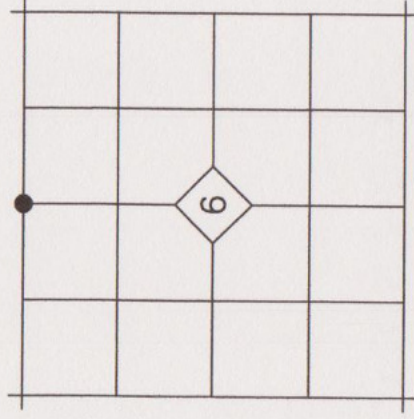

ORIGINAL DESCRIPTION: *Set qr Sec post. Made mound of earth and drove charred stake as per inst.*

EVIDENCE FOUND: After a diligent search, we found no remaining evidence of the original corner. Due to land ownership patterns in the area, there are no fences or other lines of occupation to provide evidence of the original corner location. I declare this corner lost, and reestablished its position by proportionate measure between monuments at the northwest and northeast corners of Section 6.

DESCRIPTION OF MONUMENTS AND ACCESSORIES SET AND METHODS USED:

At the corner point, I set a 5/8"x30" iron pin with attached 2 1/2 " aluminum cap 32" in the ground. Cap is marked as shown below.

From which, I SET THE FOLLOWING REFERENCE POINTS:

- ▶ A 5/8"x30" iron pin bears N.49°14'E., 35.03 ft. with attached yellow plastic cap marked BENCHMARK SURVEYING
- ▶ A 5/8"x30" iron pin bears S.38°24'E., 34.89 ft. with attached yellow plastic cap marked BENCHMARK SURVEYING
- ▶ A 5/8"x30" iron pin bears S.49°09'W., 32.64 ft. with attached yellow plastic cap marked BENCHMARK SURVEYING
- ▶ A 5/8"x30" iron pin bears N.39°29'W., 32.53 ft. with attached yellow plastic cap marked BENCHMARK SURVEYING

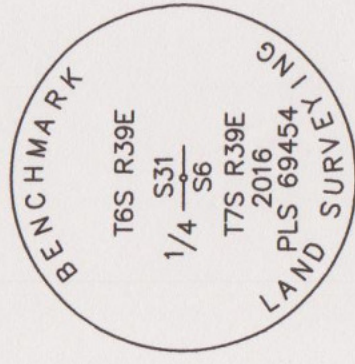

Used RTK GPS to measure the reference points. See associated survey dated July 22, 2016, filed separately.

RESTORATION BY, STAMP AND DATE:

Work Performed July 7, 2016 by:

Jason L. Hatfield, PLS
Michael C. Springer, PLS

BENCHMARK LAND SURVEYING, INC.

2101 Main Street
Baker City, OR 97814
(800) 699-0516
www.benchmarkls.com

FILED Aug. 5, 2016
BAKER COUNTY SURVEYOR
SURVEY NO. 6-39-8
7-39-81

REGISTERED
PROFESSIONAL
LAND SURVEYOR

Jason L. Hatfield
OREGON
NOVEMBER 30, 2007
JASON L. HATFIELD
#69454

EXPIRES: 6/30/2017

RECORD OF LAND CORNER MONUMENTATION

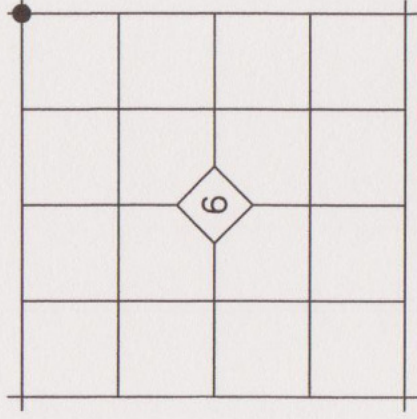

CORNER: NORTHEAST COR. SECTION 6, TWP. 7 S., RANGE 39 E., W.M.

ORIGINAL SURVEY BY: Timothy W. Davenport, U.S. Deputy Surveyor

CONTRACT NUMBER: 102

CONTRACT DATE: July 20, 1863

ORIGINAL DESCRIPTION: *Set post corner to Secs 5, 6, 31 & 32 made mound of earth and drove charred stake as per inst.*

EVIDENCE FOUND: No remaining evidence of the original post was found. The corner is reestablished at the corner of long-established fences running North, South and East, which is the best available evidence of the original corner position.

DESCRIPTION OF MONUMENTS AND ACCESSORIES SET AND METHODS USED:

At the corner point, I set a 5/8"x30" iron pin with attached 2 1/2 " aluminum cap 30" in the ground. Cap is marked as shown below.

From which, I SET THE FOLLOWING REFERENCE POINTS:

- ▶ A 5/8"x30" iron pin bears N.89°24'E., 27.91 ft. with attached yellow plastic cap marked BENCHMARK SURVEYING set in an east-west fence line
- ▶ A 5/8"x30" iron pin bears S.00°32'E., 39.30 ft. with attached yellow plastic cap marked BENCHMARK SURVEYING set in a north-south fence line
- ▶ A 5/8"x30" iron pin bears S.58°40'W., 44.40 ft. with attached yellow plastic cap marked BENCHMARK SURVEYING
- ▶ A 5/8"x30" iron pin bears N.43°24'W., 43.69 ft. with attached yellow plastic cap marked BENCHMARK SURVEYING

Used RTK GPS to measure the reference points. See associated survey dated July 22, 2016, filed separately.

RESTORATION BY, STAMP AND DATE:

Work Performed July 7, 2016 by:

Jason L. Hatfield, PLS
Michael C. Springer, PLS

BENCHMARK LAND SURVEYING, INC.

2101 Main Street
Baker City, OR 97814
(800) 699-0516
www.benchmarkls.com

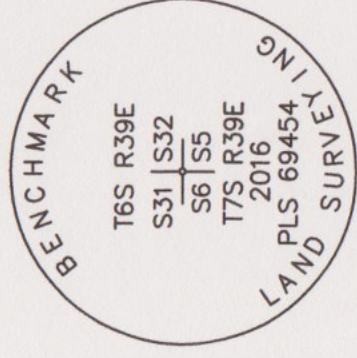

FILED Aug. 5, 2016
BAKER COUNTY SURVEYOR
SURVEY NO. 6-39-9
7-39-82

RECORD OF LAND CORNER MONUMENTATION

CORNER: NW1/16 COR. SECTION 6, TWP. 7 S., RANGE 39 E., W.M.

(CORNER NOT PREVIOUSLY ESTABLISHED)

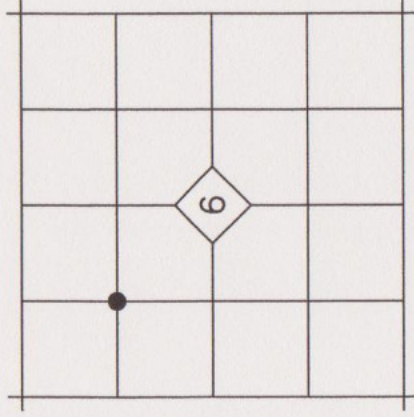

ORIGINAL DESCRIPTION: N/A

EVIDENCE FOUND: N/A

DESCRIPTION OF MONUMENTS AND ACCESSORIES SET AND METHODS USED:

At the corner point, as located by survey, I set a 5/8"x30" iron pin with attached 2" aluminum cap 24" in the ground. Cap is marked as shown below. Corner is located on East bank of the Wilson Kelsey irrigation ditch.

From which, I SET THE FOLLOWING REFERENCE POINTS:

- ▶ A 5/8"x30" iron pin bears S.39°52'W., 36.59 ft. with attached yellow plastic cap marked BENCHMARK SURVEYING
- ▶ A 5/8"x30" iron pin bears N.47°34'W., 33.31 ft. with attached yellow plastic cap marked BENCHMARK SURVEYING

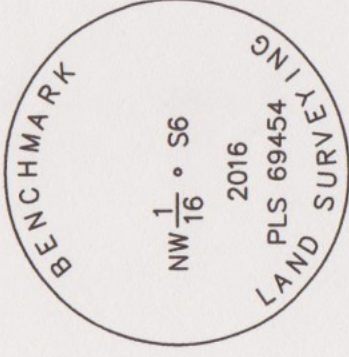

Used a Total Station to measure the reference points. See associated survey dated July 22, 2016, filed separately.

RESTORATION BY, STAMP AND DATE:

Work Performed July 7, 2016 by:

Jason L. Hatfield, PLS
Michael C. Springer, PLS

BENCHMARK LAND SURVEYING, INC.
2101 Main Street
Baker City, OR 97814
(800) 699-0516
www.benchmarkls.com



FILED Aug. 5, 2016
BAKER COUNTY SURVEYOR
SURVEY NO. 7-39-74

EXPIRES: 6/30/2017

RECORD OF LAND CORNER MONUMENTATION

CORNER: C-W1/16 COR. SECTION 6, TWP. 7 S., RANGE 39 E., W.M.

(CORNER NOT PREVIOUSLY ESTABLISHED)

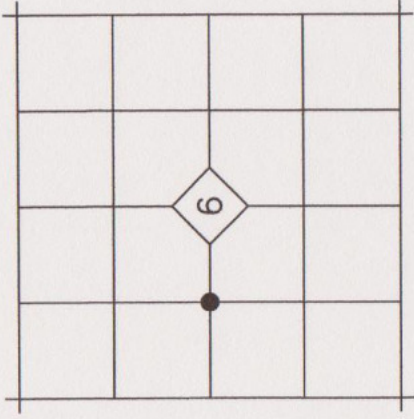

ORIGINAL DESCRIPTION: N/A

EVIDENCE FOUND: N/A

DESCRIPTION OF MONUMENTS AND ACCESSORIES SET AND METHODS USED:

At the corner point, as located by survey, I set a 5/8"x30" iron pin with attached 2" aluminum cap 28" in the ground. Cap is marked as shown below.

From which, I SET THE FOLLOWING REFERENCE POINTS:

- ▶ A 5/8"x30" iron pin bears S.52°27'W., 14.61 ft. with attached yellow plastic cap marked BENCHMARK SURVEYING, set in a North-South fence
- ▶ A 5/8"x30" iron pin bears N.35°33'W., 13.91 ft. with attached yellow plastic cap marked BENCHMARK SURVEYING, set in a North-South fence

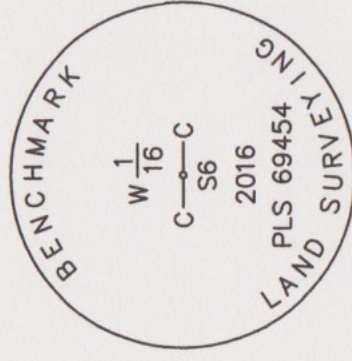

Used a Total Station to measure the reference points. See associated survey dated July 22, 2016, filed separately.

RESTORATION BY, STAMP AND DATE:

Work Performed July 7, 2016 by:

Jason L. Hatfield, PLS
Michael C. Springer, PLS

BENCHMARK LAND SURVEYING, INC.

2101 Main Street
Baker City, OR 97814
(800) 699-0516
www.benchmarkls.com

FILED Aug. 5, 2016
BAKER COUNTY SURVEYOR
SURVEY NO. 7-39-16

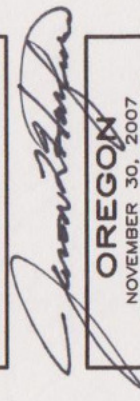

REGISTERED
PROFESSIONAL
LAND SURVEYOR

OREGON
NOVEMBER 30, 2007
JASON L. HATFIELD
#69454

EXPIRES: 6/30/2017

RECORD OF LAND CORNER MONUMENTATION

CORNER: EAST 1/4 COR. SECTION 6, TWP. 7 S., RANGE 39 E., W.M.

ORIGINAL SURVEY BY: David P. Thompson & David Chaplin,
U.S. Deputy Surveyors

CONTRACT NUMBER: 104

CONTRACT DATE: April 16, 1864

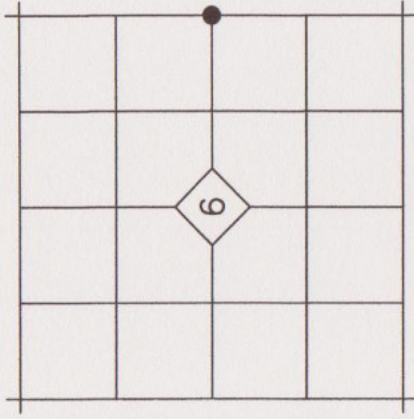

ORIGINAL DESCRIPTION: *Set post for 1/4 Sec corner in mound of Earth with charred stake pits trench as per instructions.*

EVIDENCE FOUND: After a diligent search, we found no remaining evidence of the original corner. Due to land ownership patterns in the area, there are no fences or other lines of occupation to provide evidence of the original corner location. I declare this corner lost, and reestablished its position by proportionate measure between monuments at the northeast and southeast corners of Section 6.

DESCRIPTION OF MONUMENTS AND ACCESSORIES SET AND METHODS USED:

At the corner point, I set a 5/8"x30" iron pin with attached 2 1/2" aluminum cap 30" in the ground. Cap is marked as shown below.

From which, I SET THE FOLLOWING REFERENCE POINTS:

- ▶ A 5/8"x30" iron pin bears N.36°04'E., 25.66 ft. with attached yellow plastic cap marked BENCHMARK SURVEYING
- ▶ A 5/8"x30" iron pin bears S.42°35'E., 30.03 ft. with attached yellow plastic cap marked BENCHMARK SURVEYING
- ▶ A 5/8"x30" iron pin bears S.35°00'W., 26.80 ft. with attached yellow plastic cap marked BENCHMARK SURVEYING
- ▶ A 5/8"x30" iron pin bears N.28°53'W., 27.94 ft. with attached yellow plastic cap marked BENCHMARK SURVEYING

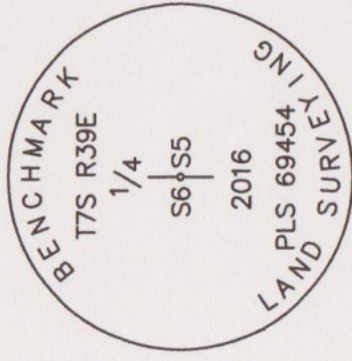

Used RTK GPS to measure the reference points. See associated survey dated July 22, 2016, filed separately.

RESTORATION BY, STAMP AND DATE:

Work Performed July 7, 2016 by:

Jason L. Hatfield, PLS
Michael C. Springer, PLS

BENCHMARK LAND SURVEYING, INC.

2101 Main Street
Baker City, OR 97814
(800) 699-0516
www.benchmarkpls.com



Jason L. Hatfield
OREGON
NOVEMBER 30, 2007
JASON L. HATFIELD
#69454

FILED *Aug 5, 2016*
BAKER COUNTY SURVEYOR
SURVEY NO. *7-39-77*

EXPIRES: 6/30/2017

RECORD OF LAND CORNER MONUMENTATION

CORNER: SW1/16 COR. SECTION 6, TWP. 7 S., RANGE 39 E., W.M.

(CORNER NOT PREVIOUSLY ESTABLISHED)

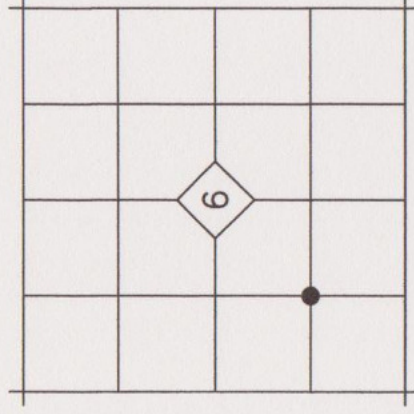

ORIGINAL DESCRIPTION: N/A

EVIDENCE FOUND: N/A

DESCRIPTION OF MONUMENTS AND ACCESSORIES SET AND METHODS USED:

At the corner point, as located by survey, I set a 5/8"x30" iron pin with attached 2" aluminum cap 30" in the ground. Cap is marked as shown below.

From which, I SET THE FOLLOWING REFERENCE POINTS:

- ▶ A 5/8"x30" iron pin bears N.01°13'E., 10.58 ft. with attached yellow plastic cap marked BENCHMARK SURVEYING
- ▶ A 5/8"x30" iron pin bears S.70°17'E., 13.03 ft. with attached yellow plastic cap marked BENCHMARK SURVEYING

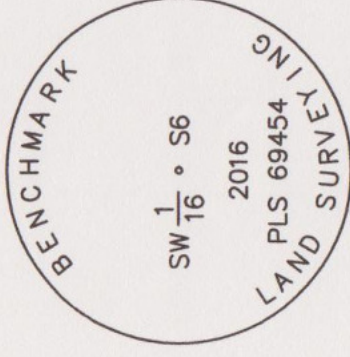

Used RTK GPS to measure the reference points. See associated survey dated July 22, 2016, filed separately.

RESTORATION BY, STAMP AND DATE:

Work Performed July 7, 2016 by:

Jason L. Hatfield, PLS
Michael C. Springer, PLS

BENCHMARK LAND SURVEYING, INC.

2101 Main Street
Baker City, OR 97814
(800) 699-0516
www.benchmarkpls.com

FILED Aug 5, 2016
BAKER COUNTY SURVEYOR
SURVEY NO. 7-39-18



Jason L. Hatfield
OREGON
NOVEMBER 30, 2007
JASON L. HATFIELD
#69454

EXPIRES: 6/30/2017

RECORD OF LAND CORNER MONUMENTATION

CORNER: SOUTH 1/4 COR. SECTION 6, TWP. 7 S., RANGE 39 E., W.M.

ORIGINAL SURVEY BY: David P. Thompson & David Chaplin,
U.S. Deputy Surveyors

CONTRACT NUMBER: 104

CONTRACT DATE: April 16, 1864

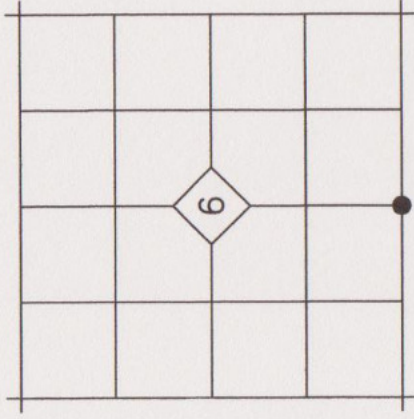

ORIGINAL DESCRIPTION: *Set post for 1/4 Sec corner in mound of Earth with charred stake pits trench as per instructions.*

EVIDENCE FOUND: There is no remaining evidence of the original post. The corner is determined to be at the corner of long-established fences running North, East and South, which is the best available evidence of the original corner position.

DESCRIPTION OF MONUMENTS AND ACCESSORIES SET AND METHODS USED:

At the corner point, I set a 5/8"x30" iron pin with attached 2 1/2 " aluminum cap 30" in the ground. Cap is marked as shown below.

From which, I SET THE FOLLOWING REFERENCE POINTS:

- ▶ A 5/8"x30" iron pin bears N.89°07'E., 39.52 ft. with attached yellow plastic cap marked BENCHMARK SURVEYING, set in an East-West fence
- ▶ A 5/8"x30" iron pin bears S.00°28'E., 25.59 ft. with attached yellow plastic cap marked BENCHMARK SURVEYING, set in a North-South fence
- ▶ A 5/8"x30" iron pin bears N.57°00'W., 32.33 ft. with attached yellow plastic cap marked BENCHMARK SURVEYING
- ▶ A 5/8"x30" iron pin bears N.00°39'E., 32.34 ft. with attached yellow plastic cap marked BENCHMARK SURVEYING, set in a North-South fence

Used RTK GPS to measure the reference points. See associated survey dated July 22, 2016, filed separately.

RESTORATION BY, STAMP AND DATE:

Work Performed July 7, 2016 by:

Jason L. Hatfield, PLS
Michael C. Springer, PLS

BENCHMARK LAND SURVEYING, INC.

2101 Main Street
Baker City, OR 97814
(800) 699-0516
www.benchmarkls.com

FILED Aug. 5, 2016
BAKER COUNTY SURVEYOR
SURVEY NO. 1-39-19

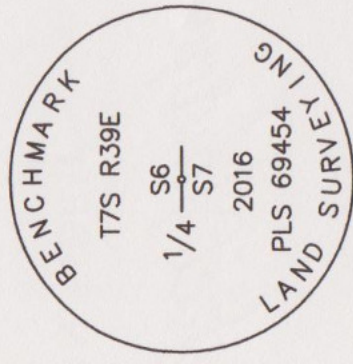

REGISTERED
PROFESSIONAL
LAND SURVEYOR

Jason L. Hatfield

OREGON
NOVEMBER 30, 2007
JASON L. HATFIELD
#69454

EXPIRES: 6/30/2017

RECORD OF LAND CORNER MONUMENTATION

CORNER: SOUTHEAST COR. SECTION 6, TWP. 7 S., RANGE 39 E., W.M.

ORIGINAL SURVEY BY: David P. Thompson & David Chaplin,
U.S. Deputy Surveyors

CONTRACT NUMBER: 104

CONTRACT DATE: April 16, 1864

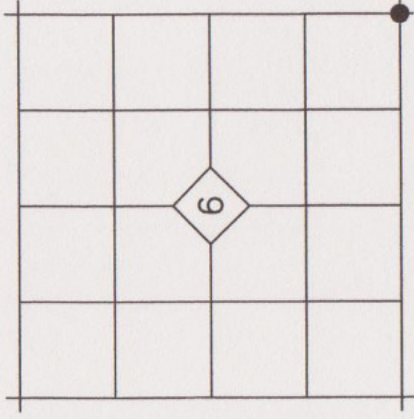

ORIGINAL DESCRIPTION: *Set post for corner to secs 5, 6, 7 & 8 in mound of Earth with charred stake pits trench as per instructions.*

EVIDENCE FOUND: No remaining evidence of the original post was found. The corner is reestablished at the intersection of a long-established north-south running fence line projected North and a long-established east-west fence line projected East. Said fences being the best available evidence of the Section lines. This position is harmoniously related to other known corners to the North, South and West. See Map of Survey dated July 22, 2016 filed in the office of the Baker County Surveyor for its relationship to other corners.

DESCRIPTION OF MONUMENTS AND ACCESSORIES SET AND METHODS USED:

At the corner point, I set a 5/8"x30" iron pin with attached 2 1/2 " aluminum cap 30" in the ground. Cap is marked as shown below.

From which, I SET THE FOLLOWING REFERENCE POINTS:

- ▶ A 5/8"x30" iron pin bears N.55°43'E., 23.39 ft. with attached yellow plastic cap marked BENCHMARK SURVEYING
- ▶ A 5/8"x30" iron pin bears S.47°16'E., 28.88 ft. with attached yellow plastic cap marked BENCHMARK SURVEYING
- ▶ A 5/8"x30" iron pin bears S.47°45'W., 31.02 ft. with attached yellow plastic cap marked BENCHMARK SURVEYING
- ▶ A 5/8"x30" iron pin bears N.64°49'W., 26.01 ft. with attached yellow plastic cap marked BENCHMARK SURVEYING

Used RTK GPS to measure the reference points. See associated survey dated July 22, 2016, filed separately.

RESTORATION BY, STAMP AND DATE:

Work Performed July 7, 2016 by:

Jason L. Hatfield, PLS
Michael C. Springer, PLS

BENCHMARK LAND SURVEYING, INC.

2101 Main Street
Baker City, OR 97814
(800) 699-0516
www.benchmarkpls.com

FILED Aug. 5, 2016
BAKER COUNTY SURVEYOR
SURVEY NO. 17-39-80

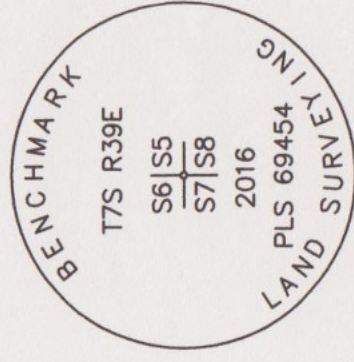

REGISTERED
PROFESSIONAL
LAND SURVEYOR

OREGON
NOVEMBER 30, 2007
JASON L. HATFIELD
#69454

EXPIRES: 6/30/2017

RECORD OF LAND CORNER MONUMENTATION

CORNER: WEST 1/4 COR. SECTION 6, TWP. 7 S., RANGE 39 E., W.M.

ORIGINAL SURVEY BY: Timothy W. Davenport, U.S. Deputy Surveyor

CONTRACT NUMBER: 102

CONTRACT DATE: July 20, 1863

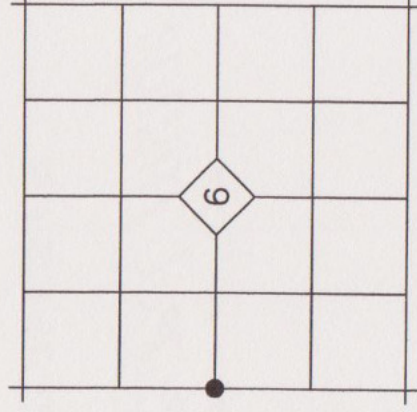

ORIGINAL DESCRIPTION: *Set qr Sec post. Made mound of earth and drove charred stake as per inst.*

EVIDENCE FOUND: This corner falls in the paved surface of Anthony Lakes Highway. I declare this corner lost, and reestablished its position by proportionate measure between monuments at the northwest and southwest corners of Section 6.

DESCRIPTION OF MONUMENTS AND ACCESSORIES SET AND METHODS USED:

At the corner point, I set a 5/8"x10" iron pin with attached 1 1/2 " yellow plastic cap 12" in the ground. Top of cap is 2" below asphalt surface. Cap is marked as shown.

From which, I SET THE FOLLOWING REFERENCE POINTS:

- ▶ A 5/8"x30" iron pin bears N.38°26'E., 51.82 ft. with attached yellow plastic cap marked BENCHMARK SURVEYING
- ▶ A 5/8"x30" iron pin bears S.89°22'14"E., 46.92 ft. with attached yellow plastic cap marked BENCHMARK SURVEYING
- ▶ A 5/8"x30" iron pin bears S.53°34'E., 45.56 ft. with attached yellow plastic cap marked BENCHMARK SURVEYING, set in a North-South fence line
- ▶ A 5/8"x30" iron pin bears N.50°44'W., 47.80 ft. with attached yellow plastic cap marked BENCHMARK SURVEYING set in a North-South fence line



Used RTK GPS to measure the reference points. See associated survey dated July 22, 2016, filed separately.

RESTORATION BY, STAMP AND DATE:

Work Performed July 7, 2016 by:

Jason L. Hatfield, PLS
Michael C. Springer, PLS

BENCHMARK LAND SURVEYING, INC.

2101 Main Street
Baker City, OR 97814
(800) 699-0516
www.benchmarkls.com

FILED Aug. 5, 2016
BAKER COUNTY SURVEYOR
SURVEY NO. 7-38-1a0
7-39-75

REGISTERED
PROFESSIONAL
LAND SURVEYOR

Jason L. Hatfield
OREGON
NOVEMBER 30, 2007
JASON L. HATFIELD
#69454

EXPIRES: 6/30/2017

RECORD OF LAND CORNER MONUMENTATION

CORNER: W1/16 COR. SECTION 17, TWP. 7 S., RANGE 38 E., W.M.
(CORNER NOT PREVIOUSLY ESTABLISHED)

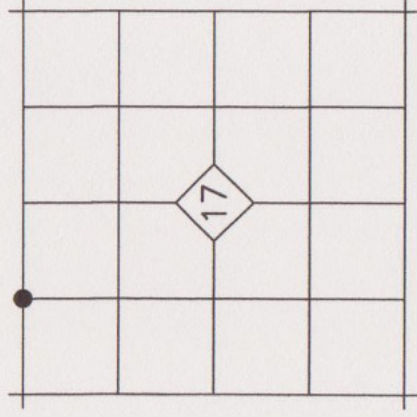

ORIGINAL DESCRIPTION: N/A

EVIDENCE FOUND: N/A

DESCRIPTION OF MONUMENTS AND ACCESSORIES SET AND METHODS USED:

At the corner point, as located by survey, I set a 5/8"x30" iron pin with attached 2" aluminum cap 28" in the ground. Cap is marked as shown below.

From which, I SET THE FOLLOWING REFERENCE POINTS:

- ▶ A 5/8"x30" iron pin bears N.10°28'E., 30.09 ft. with attached yellow plastic cap marked BENCHMARK SURVEYING
- ▶ A 5/8"x30" iron pin bears S.37°35'E., 56.63 ft. with attached yellow plastic cap marked BENCHMARK SURVEYING
- ▶ A western larch stump, 5 feet tall, bears N.64°W., 4.2 feet. I attached a BT tag to the stump with location information

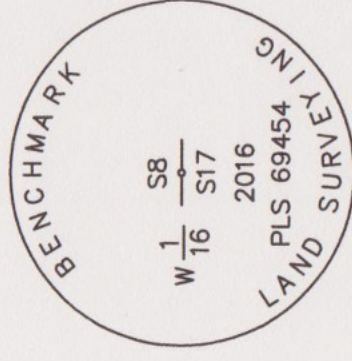

Used RTK GPS to measure the reference points. See associated survey dated July 21, 2016, filed separately.

RESTORATION BY, STAMP AND DATE:

Work Performed July 21, 2016 by:

Jason L. Hatfield, PLS
Michael C. Springer, PLS

BENCHMARK LAND SURVEYING, INC.

2101 Main Street
Baker City, OR 97814
(800) 699-0516
www.benchmarkls.com

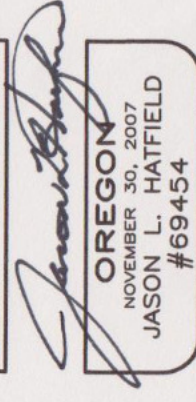

FILED Aug. 5, 2016
BAKER COUNTY SURVEYOR
SURVEY NO. 7-38-118

EXPIRES: 6/30/2017