

RECORD OF LAND CORNER MONUMENTATION

CORNER: NE 1/16 COR. SEC. 13, TWP. 13 S., RANGE 36 E., W.M.

(CORNER NOT PREVIOUSLY ESTABLISHED)

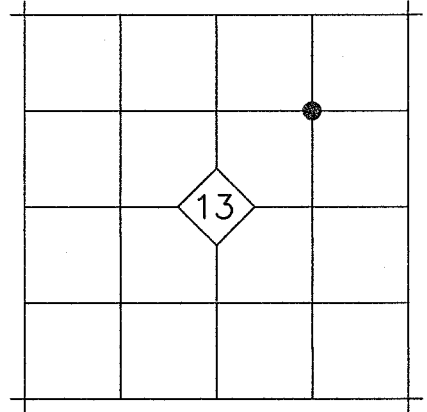

ORIGINAL DESCRIPTION: N/A

EVIDENCE FOUND: N/A

DESCRIPTION OF MONUMENTS AND ACCESSORIES SET AND METHODS USED:

At the corner point, as determined by survey, I set a 5/8"x30" iron pin with attached 2" aluminum cap 30" in the ground. Cap is marked as shown below.

From which, I SET THE FOLLOWING NEW REFERENCE POINTS:

- ▶ A 5/8"x30" iron pin bears N.47°07'E., 26.25 ft. with attached yellow plastic cap marked BENCHMARK SURVEYING.
- ▶ A 5/8"x30" iron pin bears S.59°28'E., 28.96 ft. with attached yellow plastic cap marked BENCHMARK SURVEYING.

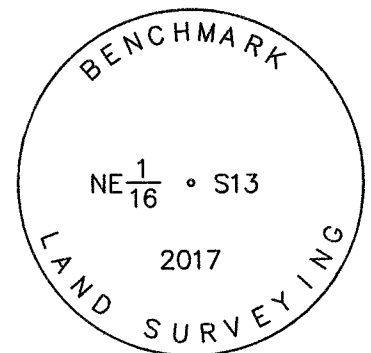

Used RTK GPS to measure the reference points. Bearings are based on Geodetic North determined by GPS observation at the SW Corner Section 13, T.13S., R.36E.

RESTORATION BY, STAMP AND DATE:

Work Performed April 28, 2017 by:

Jason L. Hatfield, PLS

BENCHMARK LAND SURVEYING, INC.
1207 Dewey Avenue
Baker City, OR 97814
(541) 523-5852
www.benchmarkls.com

FILED May 9, 2017
BAKER COUNTY SURVEYOR
SURVEY NO. 13-36-88

