

CERTIFIED RECORD OF LAND CORNER MONUMENTATION

A-17

History of original corner establishment:

Corner established by Eugene P. McCornack under Contract No. 398, and dated July 02, 1881.

Surveyor General records state: Set basalt stone 16x12x4" 11" in ground for cor to secs 2, 3, 34 & 35 marked with 2 notches on E and 4 notches on W face from which: A pine 36" diam bears N65°E, 104 lks dist marked T12SR37ES35 BT. A pine 14" diam bears S50°E, 45 lks dist marked T13SR36ES2 BT. A pine 36" diam bears S75°W, 134 lks dist marked T13SR36ES3 BT. A pine 24" diam bears N5°W, 136 lks dist marked T12SR36ES34 BT.

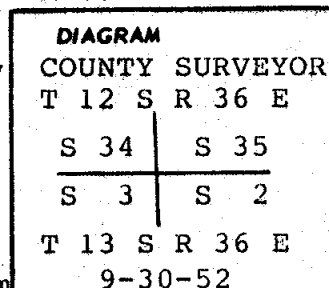

Corner re-monumented by James Hanley in 1952 and record of Baker County Survey No. 12-36-1 states: Set a 2½" brass cap on a 2" iron pipe, 30" long. (As shown in corner diagram).

Description of corner evidence found:

A 3" brass cap (record states 2½") on 2½" iron pipe protruding 8" from ground marked as shown in corner diagram from which:
 A 36" pine stump bears N65°E, 68.6' with visible scribes. A 14" pine stump bears S50°E, 29.7' with visible scribes. A 36" pine stump bears S75°W, 88.4' with visible scribes.

Description of monument and accessories I established to perpetuate the original location of this corner

Maintained mound by surrounding with more earth and stone.

New bearing trees:

A 10"p pine bears S16½°W, 88.2' dist scribed T13SR36ES3 BT.
 A 9"p pine bears N27½°W, 42.4' dist scribed T12SR36ES34 BT.
 A 8"p pine bears S58½°E, 43.8' dist scribed T13SR36ES2 BT.
 A 6"p pine bears N54°E, 96.8' dist scribed T12SR36ES35 BT.

New bearing trees have a brass washer stamped PLS 1106 nailed to face of blaze. Attached sign 54-3 & 54-9 and painted face of blaze and a 6" band around each BT. Set steel fence post alongside corner and attached sign 54-9.

Compass declination 19° East.

I hereby certify that the above corner monument was properly maintained to U.S.F.S. standards under my supervision witnessed by Willard Hulick on November 4, 1986.

**REGISTERED
PROFESSIONAL
LAND SURVEYOR**

William R. Wells

**OREGON
JULY 22, 1977
WILLIAM R. WELLS
1106**

Office of.....County Surveyor.....County of.....Baker.....
 State of.....Oregon....., I hereby certify that the within instrument was filed in this office
 for record on the.....day of....., 19....., at.....o'clock.....m., (signed)
by.....
 (COUNTY OFFICIAL) (DEPUTY)

FILED 1-23-87
 BAKER COUNTY SURVEYOR
 SURVEY NO. 13-36-62