

CERTIFIED RECORD OF LAND CORNER MONUMENTATION

X-9

HISTORY OF ORIGINAL CORNER ESTABLISHMENT:

The subdivision of T12S, R44E, W.M. was originally surveyed by Herman D. Gradon under General Land Office Contract No. 428, approved October 25, 1882. The field notes for this survey state:

Set a basalt stone 16 x 8 x 5, 10 in. deep for 1/4 section corner, marked 1/4 on W. face, dug pits 18 x 18 x 12 in. N. & S. of stone 5 1/2 ft. dist., raised mound of earth 1 1/2 ft. high, 3 1/2 ft. base alongside.

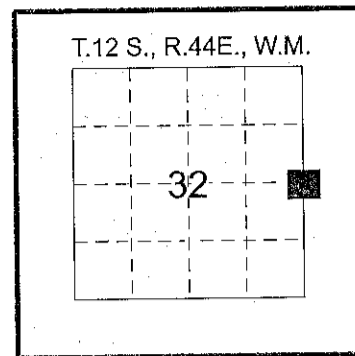

SUBSEQUENT CORNER RECOVERY OF RECORD:

The one quarter section corner to Sections 32 and 33 was used as the main tie to the PLSS for each initial point on the lode line in all four quartz claims comprising the Cleveland Consolidated Quartz Claim and Millsite. The corner is shown on the plat and called out in the field notes of U.S. Mineral Survey No. 240, surveyed by Emil F. Voigt, U.S. Deputy Mineral Surveyor, on Sept. 21 to 25, 1891.

DESCRIPTION OF CORNER EVIDENCE FOUND:

No original evidence of the corner monument was found for this corner. A corner of U.S. Mineral Survey No. 240, the corner on the lode line common to the On Time and Cleveland Quartz Claims, was found and used to reestablish this corner. The field notes for this survey on P.186 Volume OR-M0009 state: Cleveland Quartz Claim Survey of Lode, Beginning at the previously described L.S. 2 O.T. at the southwesterly end of lode, mark it on north face L.S. 1 C. from which 1/4 section corner between Sections 32 and 33 bears S.54° W. 3960 feet distant.

DESCRIPTION OF MONUMENT AND ACCESSORIES ESTABLISHED TO PERPETUATE THE ORIGINAL LOCATION OF THIS CORNER:

Set a 3/4 in. diam. alum. cap on a 2 1/2 in. diam. by 30 in. long alum. post, buried 20 inches in the ground, clear DEEP-1 magnet buried alongside at base, placed rock mound around monument to top, set a t-post 1.7 ft. SW'ly, marked as shown:

From which, I establish the following references:

A 5/8 in. diam. by 30 in. long iron rod (rebar) with a 1 1/2 in. diam. alum. cap, driven 22 in. in the ground, in fenceline on West side of Eastbound lanes of Interstate Hwy. 84, mkd.: ODOT NE, bears N44° 02' 02" E, 86.60 ft.

A 5/8 in. diam. by 30 in. long iron rod (rebar) with a 1 1/2 in. diam. alum. cap, driven 22 in. in the ground, in fenceline on West side of Eastbound lanes of Interstate Hwy. 84, mkd.: ODOT SE, bears S58° 25' 03" E, 101.03 ft.

NOTE: No suitable area for references in Southwest and Northwest quadrants.

Accessories taken with Leica 1200 GPS system using NAD 83 datum and grid bearings based on SPCS 1983, North zone. True bearings are shown hereon using average convergence angle of 2° 14' 00", positive rotation.

Witnesses:
Pete Elder, Jeff Miles

I hereby certify that the above corner position was perpetuated as hereon described on Dec. 09, 2011.

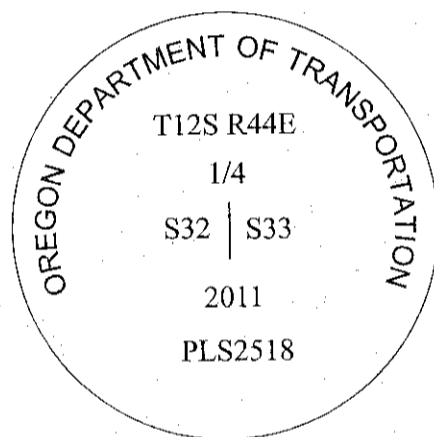

REGISTERED
PROFESSIONAL
LAND SURVEYOR

[Signature]
OREGON
JULY 25, 1991
JAY M. ROUNDTREE
2518

RENEWS: 12/31/2012

FILED May 8, 2012
BAKER COUNTY SURVEYOR
SURVEY NO. 12-44-21

OREGON DEPARTMENT OF TRANSPORTATION 	Section	Weatherby - Lime		
	Highway	Interstate 84		
	County	Baker	Scale	NTS
	Purpose	Right of Way	Date	January, 2012
	File			