

CERTIFIED RECORD OF LAND CORNER MONUMENTATION

HISTORY OF ORIGINAL CORNER ESTABLISHMENT:

A 1" IRON PIPE IS SHOWN ON OREGON DEPARTMENT OF TRANSPORTATION DRAWING NO. 1R-2-1439 AT THIS CORNER LOCATION.

DIAGRAM

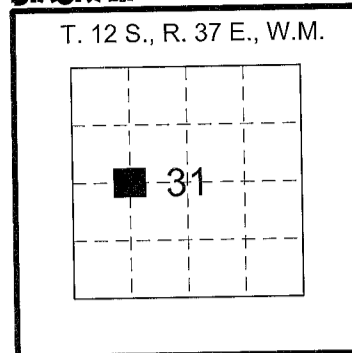

X-2

DESCRIPTION OF CORNER EVIDENCE FOUND:

NO CORNER FOUND

DESCRIPTION OF MONUMENT AND ACCESSORIES I ESTABLISHED TO PERPETUATE THE ORIGINAL LOCATION OF THIS CORNER:

ESTABLISHED THE CORNER AS SHOWN ON THE RECORD OF SURVEY FOR THE CEMETERY QUARRY BOUNDARY RESOLUTION FILED CONCURRENTLY WITH THIS CORNER MONUMENTATION RECORD.

SET 1-1/2" ALUMINUM CAP ON A 5/8" X 30" IRON ROD, UP 1" ABOVE THE GROUND, WITH A POST WITH PADDLE PLACED ALONGSIDE. THE CAP IS MARKED AS SHOWN BELOW.

THE REFERENCES SET FOR SAID CORNER ARE AS FOLLOWS:

- 1) A 5/8" X 30" IRON ROD WITH A 1-1/2" ALUMINUM CAP, UP 1", STAMPED "ODOT" BEARS S81°50'48"E, 6.91 FEET.
- 2) A 5/8" X 30" IRON ROD WITH A 1-1/2" ALUMINUM CAP, UP 1", STAMPED "ODOT" BEARS S1°25'36"W, 7.76 FEET.

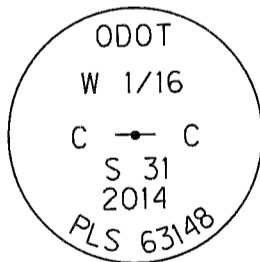

WITNESSES:

BRET ELITHORP, PLS
MARK STEWART, CODY WHEELER

I HEREBY CERTIFY THAT THE ABOVE CORNER POSITION WAS RE-ESTABLISHED AS HEREON DESCRIBED ON SEPTEMBER 29, 2014.

FILED Dec. 19, 2014

BAKER COUNTY SURVEYOR

SURVEY NO. 12-37-89

REGISTERED
PROFESSIONAL
LAND SURVEYOR

Bret Elithorp

OREGON
JAN 14, 2003
BRET N. ELITHORP
61348

RENEWS: 12/31/2015

OREGON DEPARTMENT OF TRANSPORTATION



RIGHT OF WAY
ENGINEERING

Section	CEMETERY QUARRY		
Highway	JOHN DAY HIGHWAY		
County	BAKER	Scale	NTS
Purpose	QUARRY BOUNDARY	Date	OCT. 20, 2014