

# RECORD OF LAND CORNER MONUMENTATION

CORNER: CENTER-NORTH 1/16 COR. SECTION 26, T. 12 S., R. 36 E., W.M.

(CORNER NOT PREVIOUSLY ESTABLISHED)

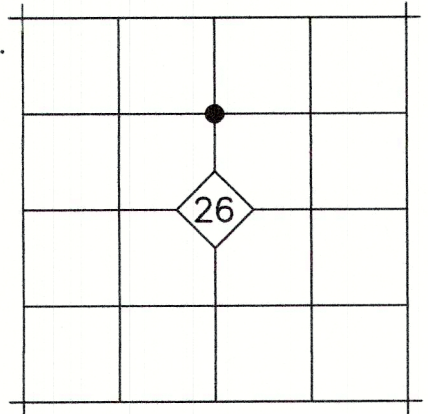

---

**ORIGINAL DESCRIPTION:** NONE

---

**EVIDENCE FOUND:** NONE

---

**DESCRIPTION OF MONUMENTS AND ACCESSORIES SET AND METHODS USED:**

At the corner position as determined by survey, I set a 5/8"x30" iron pin with attached 2½" aluminum cap 28" in the ground. Cap is marked as shown below.

**From which, I SET THE FOLLOWING REFERENCE POINTS:**

- ▶ A 5/8"x30" iron pin bears S.50°26'W., 21.79 ft. with attached yellow plastic cap marked BENCHMARK SURVEYING.
- ▶ A 5/8"x30" iron pin bears N.58°27'W., 10.52 ft. with attached yellow plastic cap marked BENCHMARK SURVEYING.

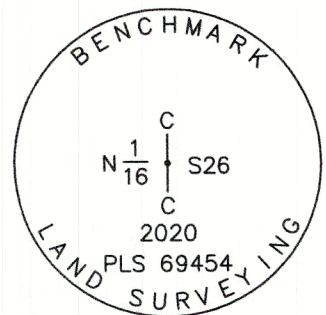

Used a total station to measure accessories. Bearings based on Baker County Survey No. 12-36-71

---

**RESTORATION BY, STAMP AND DATE:**

Work Performed August 7, 2020 by:

Jason L. Hatfield, PLS

BENCHMARK LAND SURVEYING, INC.  
1207 Dewey Avenue  
Baker City, OR 97814  
(541) 523-5852  
benchmarkls.com

FILED August 12, 2020  
BAKER COUNTY SURVEYOR  
SURVEY NO. 12-36-75

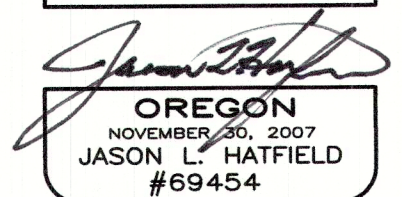
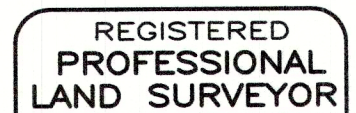

EXPIRES: 6/30/2021