

RECORD OF LAND CORNER MONUMENTATION

CORNER: NORTHWEST 1/16 COR. SECTION 26, T. 12 S., R. 36 E., W.M.

(CORNER NOT PREVIOUSLY ESTABLISHED)

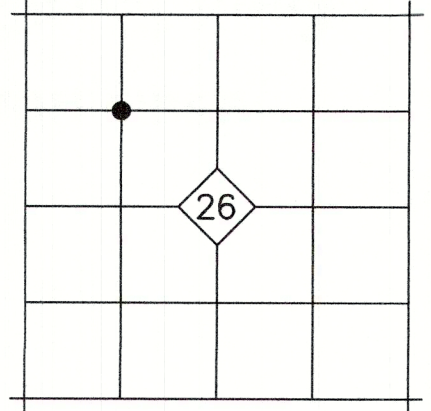

ORIGINAL DESCRIPTION: NONE

EVIDENCE FOUND: NONE

DESCRIPTION OF MONUMENTS AND ACCESSORIES SET AND METHODS USED:

At the corner position as determined by survey, I set a 5/8"x30" iron pin with attached 2½" aluminum cap 28" in the ground. Cap is marked as shown below.

From which, I SET THE FOLLOWING REFERENCE POINTS:

- ▶ A 5/8"x30" iron pin bears S.57°56'E., 18.21 ft. with attached yellow plastic cap marked BENCHMARK SURVEYING.
- ▶ A 5/8"x30" iron pin bears S.08°00'W., 22.33 ft. with attached yellow plastic cap marked BENCHMARK SURVEYING.

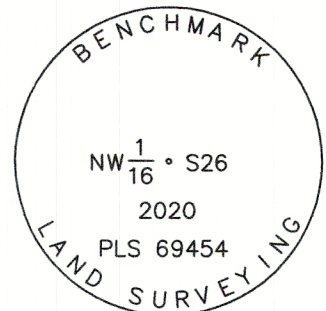

Used RTK GPS to measure accessories. Bearings based on Baker County Survey No. 12-36-71

RESTORATION BY, STAMP AND DATE:

Work Performed August 7, 2020 by:

Jason L. Hatfield, PLS

BENCHMARK LAND SURVEYING, INC.
1207 Dewey Avenue
Baker City, OR 97814
(541) 523-5852
benchmarkls.com

FILED August 12, 2020
BAKER COUNTY SURVEYOR
SURVEY NO. 12-36-74

REGISTERED
PROFESSIONAL
LAND SURVEYOR

OREGON
NOVEMBER 30, 2007
JASON L. HATFIELD
#69454
EXPIRES: 6/30/2021