

RECORD OF LAND CORNER MONUMENTATION

CORNER: WEST 1/16 COR. SECTION 26, T. 12 S., R. 36 E., W.M.

(CORNER NOT PREVIOUSLY ESTABLISHED)

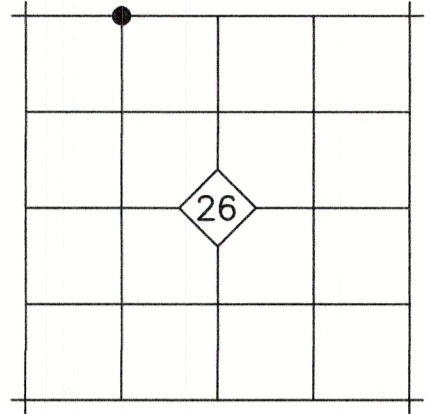

ORIGINAL DESCRIPTION: NONE

EVIDENCE FOUND: NONE

DESCRIPTION OF MONUMENTS AND ACCESSORIES SET AND METHODS USED:

At the corner position as determined by survey, I set a 5/8"x15" iron pin driven 6" into a drill hole in rock, and attached a 2 1/2" aluminum cap marked as shown below.

From which, I SET THE FOLLOWING REFERENCE POINTS:

- ▶ A 5/8"x30" iron pin bears S.68°59'E., 23.15 ft. with attached yellow plastic cap marked BENCHMARK SURVEYING.
- ▶ A 5/8"x30" iron pin bears S.15°21'W., 34.75 ft. with attached yellow plastic cap marked BENCHMARK SURVEYING.

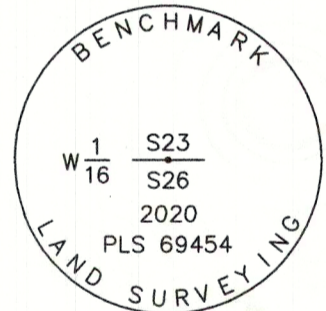

Used RTK GPS to measure accessories. Bearings based on Baker County Survey No. 12-36-71

RESTORATION BY, STAMP AND DATE:

Work Performed August 7, 2020 by:

Jason L. Hatfield, PLS

BENCHMARK LAND SURVEYING, INC.
1207 Dewey Avenue
Baker City, OR 97814
(541) 523-5852
benchmarkls.com

FILED August 12, 2020
BAKER COUNTY SURVEYOR
SURVEY NO. 12-36-72

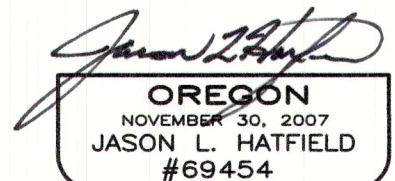
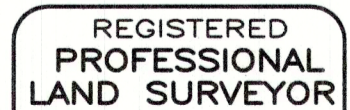

EXPIRES: 6/30/2021