

# RECORD OF LAND CORNER MONUMENTATION

**CORNER:** EAST 1/4 COR. SECTION 1, TWP. 11 S., RANGE 44 E., W.M.

**ORIGINAL SURVEY BY:** George Henderson, U.S. Deputy Surveyors

**CONTRACT NUMBER:** 402

**CONTRACT DATE:** July 8, 1881

**SUBSEQUENT SURVEY BY:** Otis O. Gould, Surveyor for the General Land Office remonumented this corner during a Dependent Resurvey under special instructions dated January 26, 1938 and letter dated September 15, 1938 for the surveys included under Group No. 219

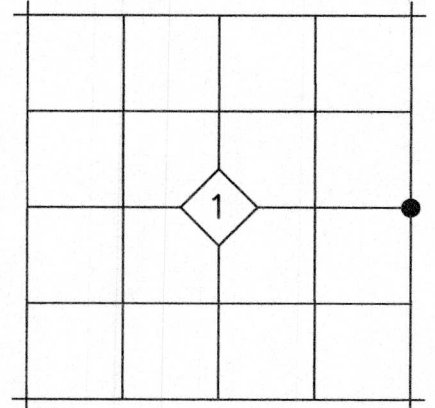

**ORIGINAL DESCRIPTION:** Set a basalt stone 16x7x6 ins. for 1/4 Sec Cor. marked 1/4S on W. side, and raised mound of stone, around stone.

**1938 DESCRIPTION:** The 1/4 sec. cor., which is a basalt stone, 18x8x6 ins., firmly set in a mound of stone, marked 1/4 on W. face.

At point for cor. Set an iron post, 3 ft. long, 1 in. diam., 6 ins. in the ground to bedrock, with the original stone deposited at the base, and in a mound of stone to top, for 1/4 sec. cor., with brass cap marked

**EVIDENCE FOUND:** I found a 1" iron pipe with attached 2½" diameter brass cap leaning and loosley projecting from a very large mound of stone. I also recovered the original marked stone west and alongside at the base of the pipe, per Gould's notes. The stone measured 18"x8"x6" and was marked 1/4S on one face. I accept the position of the base of the Gould's pipe as the 1/4 corner.

## DESCRIPTION OF MONUMENTS AND ACCESSORIES SET AND METHODS USED:

I stood the pipe up vertically and rebuilt the mound around the pipe to the top of the cap. The brass cap is marked as shown below.

From which, I SET THE FOLLOWING REFERENCE POINTS:

- ▶ A 5/8"x30" iron pin bears N.34°55'E., 49.06 ft. with attached yellow plastic cap marked BENCHMARK SURVEYING.
- ▶ A 5/8"x30" iron pin bears S.36°15'E., 31.67 ft. with attached yellow plastic cap marked BENCHMARK SURVEYING.

## STATE PLANE COORDINATES (3601 OR N)

Reference Datum: NAD83 from OPUS solution  
Northing: 370,789.4 ft.  
Easting: 9,043,626.8 ft.  
Ellip. Ht.: 5,656.3 ft.

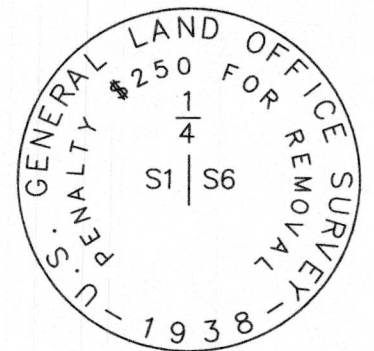

## RESTORATION BY, STAMP AND DATE:

Work Performed November 1, 2017 by:

Jason L. Hatfield, PLS  
Brandon T. Hatfield

BENCHMARK LAND SURVEYING, INC.  
1207 Dewey Avenue  
Baker City, OR 97814  
(541) 523-5852  
www.benchmarkls.com

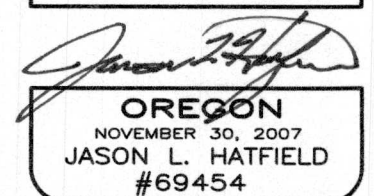
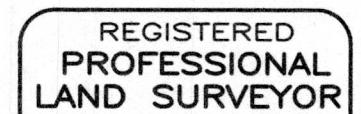

EXPIRES: 6/30/2019

FILED March 28, 2018  
BAKER COUNTY SURVEYOR  
SURVEY NO. 11-44-17  
11-45-15

C-25/C-1