

CERTIFIED RECORD OF LAND CORNER MONUMENTATION

**History of original corner establishment:**

The original corner was set by Benj. F. Vaughan under GLO contract no. 211, dated July 14, 1874, as part of a subdivisional survey of T. 11 S., R. 43 E., W.M.

Index# P-13

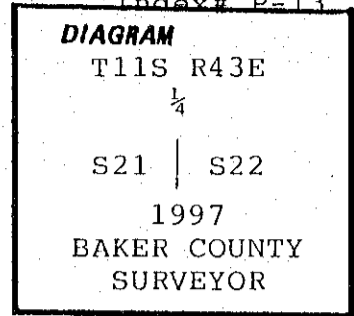

The original GLO notes state: Set stone 14x8x6 for ¼ sec. cor.

**Description of corner evidence found:**

The original GLO corner was not found. The corner position was determined from old fence remnants and the reestablished North-South section line: See CS 11-43-7.

Note: Concluded that the GLO stone was buried under ground due to mud slides which were apparent in the immediate area.

**Description of monument and accessories | established to perpetuate the original location of this corner:**

At the reestablished corner position set a 1¼"x30" galv. pipe with a 2½" dia. brass cap 20" into the ground with a 24" dia. stone mound surrounding it and set a steel fence post alongside. The brass cap is marked as shown in the corner diagram.

Corner monument references: Four 1"x2½" magnets encased in plastic were set 6" below the ground. From the corner monument:

- A silver magnet mkd. "1" bears N. 73° 31' E., 9.0 ft. dist.
- A pink magnet mkd. "2" bears S. 40° 44' E., 9.6 ft. dist.
- A blue magnet mkd. "3" bears S. 69° 35' W., 7.5 ft. dist.
- A orange magnet mkd. "4" bears N. 37° 14' W., 9.1 ft. dist.

Basis of bearings: See CS 11-43-7.

I James D. Hanley certify that this corner was properly reestablished as witnessed by Larry McBroom and Dan Lees on March 5, 1997.

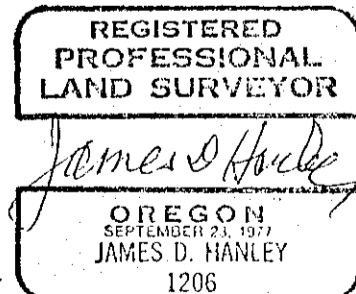

Office of..... County of.....  
 State of....., I hereby certify that the within instrument was filed in this office  
 for record on the..... day of....., 19.....  
 ..... by .....  
 (COUNTY OFFICIAL) (DEPUTY)

Form R6-7100-57 (9/71)

FILED 3-5-97  
 BAKER COUNTY SURVEYOR  
 SURVEY NO. CP # 49  
11-43-3E