

CERTIFIED RECORD OF LAND CORNER MONUMENTATION

Index# N-13

**History of original corner establishment:**

The original corner was set by Benj. F. Vaughan under GLO contract no. 211, dated July 14, 1874, as part of a subdivisional survey of T. 11 S., R. 43 E., W.M.

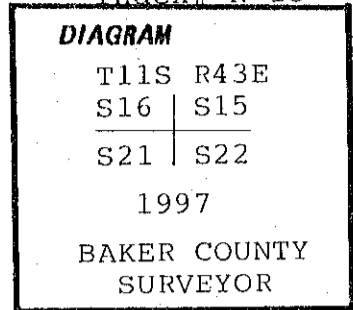

The original GLO notes state: Set stone 16x10x8 for cor. to secs. 15-16-21 and 22.

**Description of corner evidence found:**

No evidence of the original GLO corner was found. The corner position was reestablished from old fence remnants, see CS 11-43-7.

**Description of monument and accessories established to perpetuate the original location of this corner:**

At the reestablished corner position set a 1 1/4"x30" galv. pipe with a 2 1/2" dia. brass cap 20" into the ground with a 24" dia. stone mound surrounding it and set a steel fence post alongside. The brass cap is marked as shown in the corner diagram.

Corner monument references: Four 1"x2 1/2" magnets encased in plastic were set 6" below the ground. From the corner monument:

- A silver magnet mkd. "1" bears N. 63° 37' E., 10.5 ft. dist.
- A pink magnet mkd. "2" bears S. 48° 06' E., 10.4 ft. dist.
- A blue magnet mkd. "3" bears S. 59° 12' W., 9.3 ft. dist.
- A orange magnet mkd. "4" bears N. 43° 43' W., 7.8 ft. dist.

Basis of bearings: See CS 11-43-7.

REGISTERED PROFESSIONAL LAND SURVEYOR

*James D. Hanley*

OREGON  
SEPTEMBER 23, 1977  
JAMES D. HANLEY  
1206

I James D. Hanley certify that this corner was properly reestablished as witnessed by Larry McBroom and Dan Lees on March 5, 1997.

Office of..... County of.....

State of....., I hereby certify that the within instrument was filed in this office

for record on the..... day of....., 19.....

..... by .....

(COUNTY OFFICIAL)

(DEPUTY)

Form R6-7100-57 (9/71)

FILED 3-5-97  
BAKER COUNTY SURVEYOR  
SURVEY NO. CP#48  
11-43-3D