

CERTIFIED RECORD OF LAND CORNER MONUMENTATION

Index# N-11

History of original corner establishment:

The original corner was set by Benj. F. Vaughan under GLO contract no. 211, dated July 14, 1874, as part of a subdivisional survey of T. 11 S., R. 43 E., W.M.

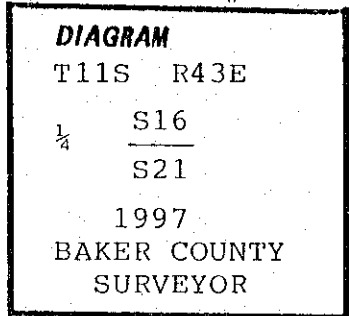

The original GLO notes state: Set stone 12x10x10 for $\frac{1}{4}$ sec. cor.

Description of corner evidence found:

No evidence of the original corner was found. Accepted a old South-East-West fence intersection for the $\frac{1}{4}$ corner, See CS 11-43-7.

Description of monument and accessories | established to perpetuate the original location of this corner:

At the position of the fence corner set a 1 $\frac{1}{2}$ "x30" galv. pipe with a 2 $\frac{1}{2}$ " dia. brass cap 24" into the ground. The brass cap is marked as shown in the corner diagram.

Corner monument references: Four 1"x2 $\frac{1}{2}$ " magnets encased in plastic were set 6" below the ground. From the corner monument:

- A silver magnet mkd. "1" bears N. 50° E., 11.7 ft. dist.
- A pink magnet mkd. "2" bears S. 45° E., 11.0 ft. dist.
- A blue magnet mkd. "3" bears S. 50° W., 9.0 ft. dist.
- A orange magnet mkd. "4" bears N. 45° W., 10.3 ft. dist.

Compass declination 19°

**REGISTERED
PROFESSIONAL
LAND SURVEYOR**

James D. Hanley

OREGON
SEPTEMBER 21, 1977
JAMES D. HANLEY
1206

I James D. Hanley certify that this corner was properly monumented as witnessed by Larry McBroom and Dan Lees on Feb. 28, 1997.

Office of..... County of.....
 State of....., I hereby certify that the within instrument was filed in this office
 for record on the..... day of....., 19.....
 by
 (COUNTY OFFICIAL) (DEPUTY)

Form R6-7100-57 (9/71)

FILED 2-28-97
 BAKER COUNTY SURVEYOR
 : SURVEY NO. CP# 45
11-43-3A