

**CERTIFIED RECORD OF LAND CORNER MONUMENTATION**

**HISTORY OF ORIGINAL CORNER ESTABLISHED:**

Corner originally established by Douglas Ferguson in Survey Number 11-41-01. Survey 11-41-01 states:

Set a 2 1/2"x30" aluminum pipe with a 3 1/2" aluminum cap stamped as shown, with corner accessories:

Set 1/2"x24" iron pin with aluminum cap as follows: S06°29'E, 50.73 ft. stamped C 1/4 S19 RM and an arrow with course to monument.

**NEW BEARING TREES:**

- A W. fir 12" diam. bears S 85°39'W, 12.7 scribed C 1/4 S19 BT.
- A W. Fir 10" diam. bears N21°22'W, 26.9, scribed C1/4 S19 BT.
- A P. Pine 8" diam. bears N69°33'E, 10.6 scribed C1/4 S19 BT.

T 11 S R 41 E P-03

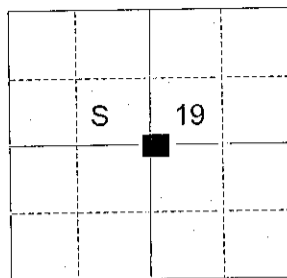

**DESCRIPTION OF CORNER EVIDENCE FOUND:**

Found a 2 1/2" aluminum pipe with a 3" brass cap, 4" above ground, from which:

- An 11 inch Ponderosa Pine bears North 70° East, a distance of 10.6 feet, alive and vigorous with healed blaze.
- A stump bears South 85° West, a distance of 12.7 feet, no marks visible.
- A 1/2" rebar bears South 6° East, a distance of 50.7 feet, no cap.

**DESCRIPTION OF MONUMENT AND ACCESSORIES I ESTABLISHED**

**TO PERPETUATE THE ORIGINAL LOCATION OF THIS CORNER:**

From the aluminum pipe monument,

**NEW BEARING OBJECTS:**

- A 5 inch Ponderosa Pine bears South 78° West, a distance of 33.70 feet, marked C 1/4 S19 BT.
- A 3 inch Ponderosa Pine bears South 8° West, a distance of 9.70 feet, marked X BT.

I hereby certify that the corner was perpetuated on July 14, 2014.

Witness: Thomas J. Kopp

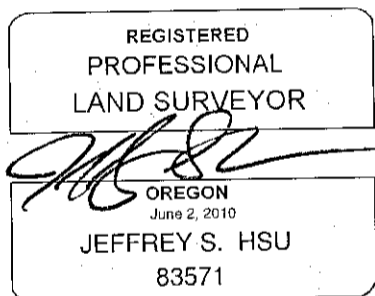

Renewal Date: June 30, 2015

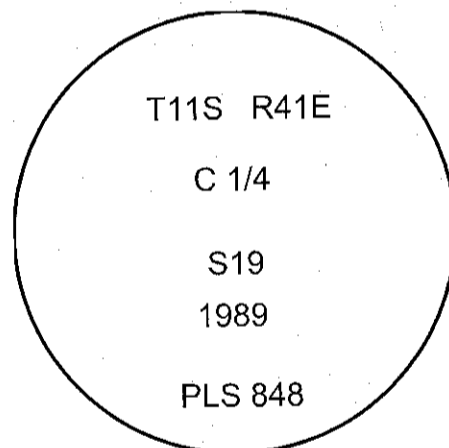

I used a steel tape and magnetic compass in the establishment of the new accessories. I used 16° East declination, the distances are to a 60d spike driven into the right side of the root crown of the new bearing trees. A brass washer marked OPLS 83571 is attached to the BT blaze of the new bearing tree.

FILED Aug. 5, 2014  
BAKER COUNTY SURVEYOR  
SURVEY NO. 11-41-59