

CERTIFIED RECORD OF LAND CORNER MONUMENTATION

HISTORY OF ORIGINAL CORNER ESTABLISHED:

Corner originally established by Benjamin F. Vaughn under GLO Contract No. 211, dated July 1874.
Survey General States:

Set stone 12x10x8 for 1/4 Sec. corner.

Corner reset at proportionate position by C. Albert White in dependent resurvey, completed under special instructions dated September 3, 1940, Group No. 261. Which states:

Set and iron post, 28 ins. long, 2 1/2 ins. diam., 24 ins. in the ground with brass cap marked as shown below. From which:

- A Yellow Pine, 12 ins. diam., bears N 51° W, 47 lks. dist., mkd. 1/4 S7 BT.
- A Yellow Pine, 10 ins. diam., bears S 53° W, 24 lks. dist., mkd. 1/4 S18 BT.

T 11 S R 41 E J-03

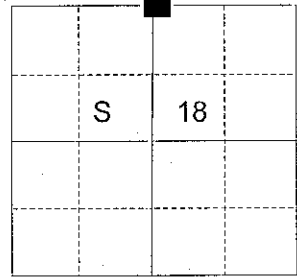

DESCRIPTION OF CORNER EVIDENCE FOUND:

Found a 2 1/2" iron pipe with a 3" brass cap, 3" above ground, in a collar of stone, 1 ft. diam., from which:

- A stump bears S 53° W., a distance of 16', with scribe marks visible on a partially healed blaze.
- A stump hole bears N 51° W, a distance of 31', with a tree adjacent, dead and downed, with visible scribe marks on a partially healed blaze.

DESCRIPTION OF MONUMENT AND ACCESSORIES I ESTABLISHED

TO PERPETUATE THE ORIGINAL LOCATION OF THIS CORNER:

From the iron pipe monument,

NEW BEARING OBJECTS:

- From the iron pipe:
- A 5" Ponderosa Pine bears N 66° E, a distance of 7.35 ft., marked 1/4 S7 BT.
- An 8" Ponderosa Pine bears S 89° E, a distance of 20.40 ft., marked 1/4 S18 BT.
- A 10" Ponderosa Pine bears S 18° W, a distance of 80.70 ft, marked 1/4 S18 BT.
- A 4" Ponderosa Pine bears N 25° W, a distance of 17.00', marked 1/4 S7 BT.

I hereby certify that the corner was perpetuated on July 14, 2014.

Witness: Thomas J. Kopp

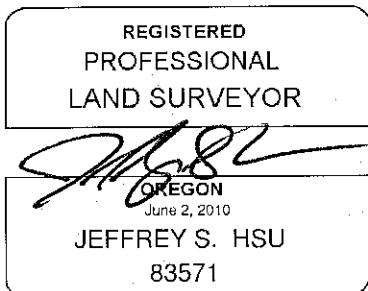

Renewal Date: June 30, 2015

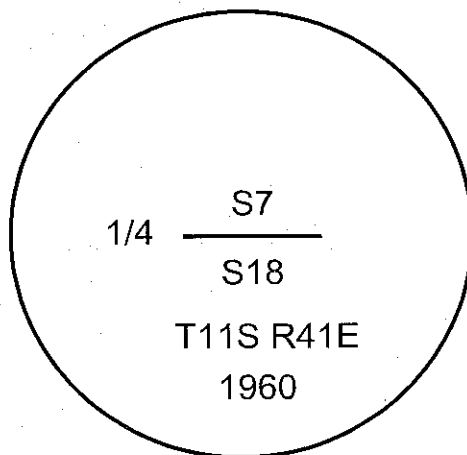

I used a steel tape and magnetic compass in the establishment of the new accessories. I used 16° East declination, the distances are to a 60d spike driven into the right side of the root crown of the new bearing trees. A brass washer marked OPLS 83571 is attached to the BT blaze of the new bearing trees.

FILED Aug. 5, 2014
BAKER COUNTY SURVEYOR
SURVEY NO. 11-41-54