

**CERTIFIED RECORD OF LAND CORNER MONUMENTATION**

**HISTORY OF ORIGINAL CORNER ESTABLISHMENT:**

Originally established by Benjamin F. Vaughn under GLO Contract No. 211, dated July 14, 1874. Surveyor record states:

Set stone 12x10x8 for cor. for 1/4 sec. cor.

Corner reestablished by C. Albert White under special instructions dated September 3, 1940, included under Group No. 261. Surveyor record states:

Point for 1/4 sec. cor. of secs. 10 and 11, at proportionate distance; there is no remaining evidence of the original corner.

Set an iron post, 28 ins. Long, 2 1/2 ins. diam., 22 ins. in the ground with brass cap. From which:

- A fir, 7 ins. diam., bears N. 14° E., 41 lks. dist., mkd 1/4 S11 BT.
- A yellow pine, 14 ins. diam., bears N. 70° W., 57 lks. dist., mkd. 1/4 S10 BT.

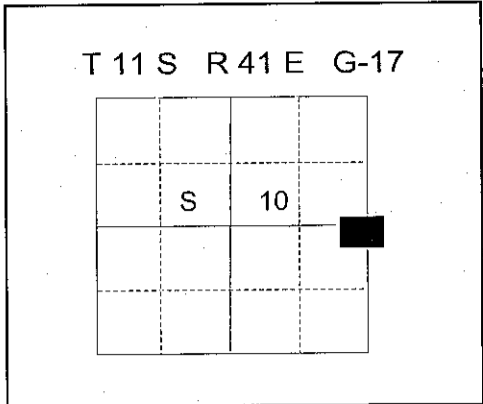

**DESCRIPTION OF CORNER EVIDENCE FOUND:**

Found Bureau of Land Management 3" Brass cap, marked as shown below, on 2 1/2" iron post, 3 inches above ground, from which:

- A 20 inch Douglas Fir bears North 16° East, a distance of 26.70 feet, alive and vigorous with healed blaze.
- A 16 inch Ponderosa Pine bears North 70° West, a distance of 38.25 feet, alive and vigorous with healed blaze.

**DESCRIPTION OF MONUMENT AND ACCESSORIES I ESTABLISHED**

**TO PERPETUATE THE ORIGINAL LOCATION OF THIS CORNER:**

**NEW BEARING TREES:**

- A 13 inch Douglas Fir bears South 7° East, a distance of 47.40 feet, marked 1/4 S11 BT.
- An 8 inch Douglas Fir bears South 83° West, a distance of 45.40 feet, marked 1/4 S10 BT.

I hereby certify that the corner was perpetuated on April 18, 2012  
Witness: Jeff Hsu

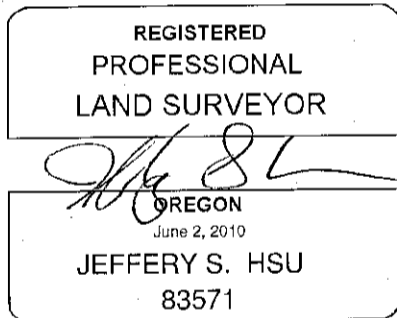

Renewal Date: June 30, 2013

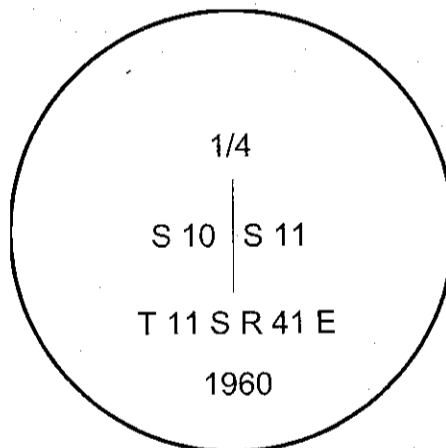

I used a steel tape and magnetic compass in the establishment of the bearing trees. Magnetic declination used was 16° East. Bearings for the new bearing trees are to a washer in the top of the BT Blaze marked OPLS 83571. Bearings to the old bearing trees are to the center of the tree at the root crown. Distances are to a 50d spike in the right hand side of the root crown of the tree.

G-17

FILED May 3, 2012  
BAKER COUNTY SURVEYOR  
SURVEY NO. 11-41-41