

CERTIFIED RECORD OF LAND CORNER MONUMENTATION

HISTORY OF ORIGINAL CORNER ESTABLISHMENT:

None.

No record of subsequent monumentation found in Baker County survey records

DESCRIPTION OF CORNER EVIDENCE FOUND:

None.

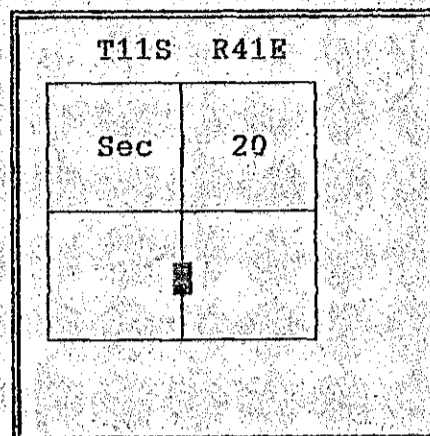

DIAGRAM

DESCRIPTION OF MONUMENT AND ACCESSORIES I ESTABLISHED TO PERPETUATE THE ORIGINAL LOCATION OF THIS CORNER:

At proportionate position, I set a 2½" x 30" aluminum pipe with aluminum cap marked as shown, 24 inches in the ground, from which;

NEW BEARING TREES:

A 16 inch diameter Ponderosa Pine bears N89°E, 32.11 feet marked CS 1/16 S20 BT.
A 19 inch diameter Douglas Fir bears N53°W, 58.08 feet marked CS 1/16 S20 BT.

Raised a mound of stone around monument, 1 ft. base to top of cap.

Painted a 6" red band around all BTs and attached Bearing Tree signs.

Set a steel fence post approximately 5 feet North with Land Survey Monument sign attached.

I hereby certify that the above corner point was perpetuated as hereon described on August 2, 1994.
Witnesses: Peter Crabtree and Travis Foster.

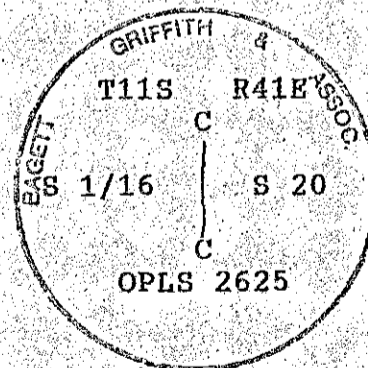
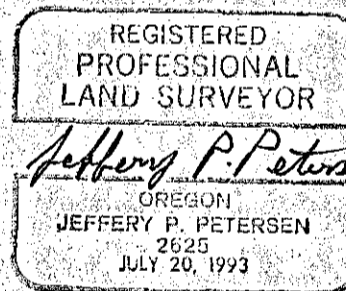

I used a steel tape and magnetic compass in the establishment of new accessories. I used 20° East magnetic declination and the distances are to a 50d spike driven in the right side of the root crown.

Q-7 FILED 8-24-94
BAKER COUNTY SURVEYOR
SURVEY NO. 11-41-16