

Section 27

Section 26

SURVEY
SCALE: 1" = 50'

TOPOGRAPHY
SCALE: 1" = 50'

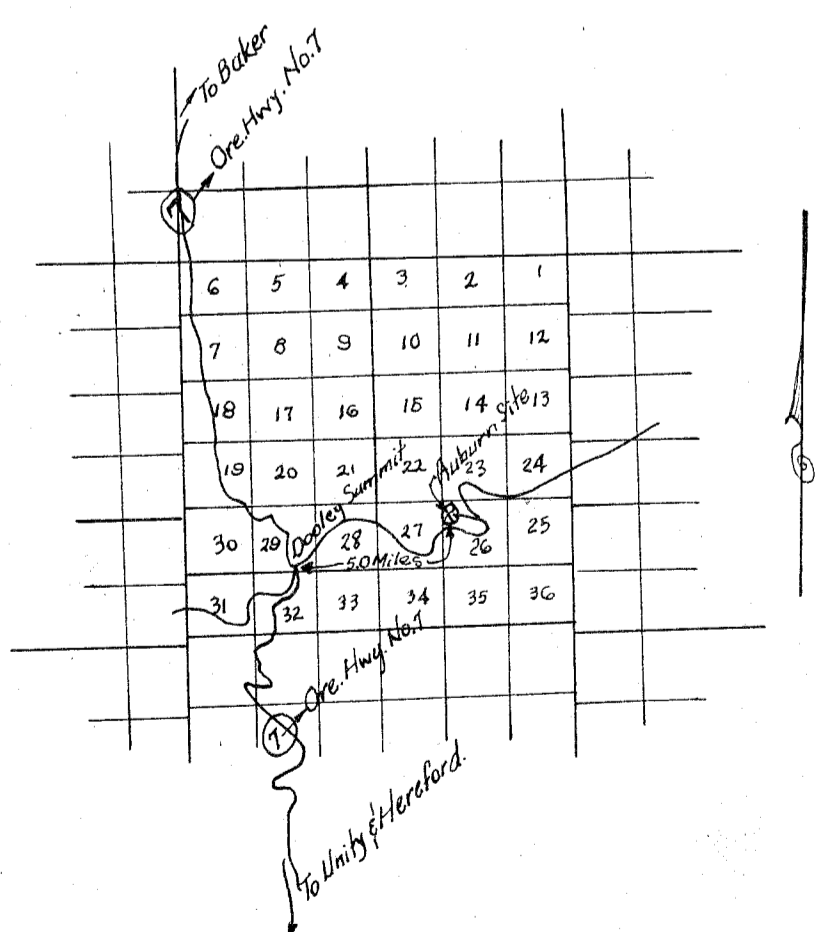

VICINITY MAP
SCALE: 1" = 3 Miles.

John R. Gray

FILED
APR 23 1959
GRANT A. BOULG
BAKER COUNTY CLERK

FILED April 30, 1959
BAKER COUNTY SURVEYOR
OFFICE NO. 11-40-2

John R. Gray
R.P.E. 3352
359 N.E. 130 th. Place AL 4-7550 Portland 30, Oregon

SURVEY & TOPOGRAPHY
//
AUBURN M.W.R. TOWER SITE
//
Baker County, Oregon

Dr. by: JRG	4-17-59	1 of 1.
Check. by: JRG	4-18-59	JOB 58-6.