

CERTIFIED RECORD OF LAND CORNER MONUMENTATION

HISTORY OF ORIGINAL CORNER ESTABLISHED:

Corner originally established by Henry W. Cooke, under GLO Contract No. 418, dated August 30, 1881. Surveyor General record states:

Set a post 3 ft. long, 3 ins. sqr. 24 ins. in ground for 1/4 sec. cor, from which:
A pine 10 in. dia. bears N35°E, 25 lks. dist., marked 1/4 S BT.
Tamarack 5 in. dia., bears N18°W, 24 lks. dist., marked 1/4 S BT.

In 1976 Leland L. Myers, PLS 699, finds no remaining evidence of the corner and re-established this corner by single proportion. Baker County monumentation record states that he set a 2"x30" galvanized pipe with a 2 1/2" brass cap 26" in the ground. From which new bearing trees:
A 14" Western Larch bears N 34° E, 44.8'.
A 16" Douglas Fir bears N 88° W, 14.8'.

In 1991 Douglas M. Ferguson accepts monument set by Leland Meyers. The monument is within tolerance, but he finds some discrepancy to the bearing trees. Old bearing trees taken by Meyers:

A 18" Douglas Fir dead, with partially healed blaze, bears N 45°37' W, 14.5'.
A 14" Western Larch with partially healed blaze, bears N 70°12' E, 45.6'.

And takes new bearing objects:
A White Fir, 10" in diam., bears N 56°30' W, 50.0', scribed 1/4 S17 BT.
A White Fir, 22" in diam., bears N 44°30' E, 25.0', scribed 1/4 S16 BT.
A White Fir, 16" in diam., bears N 81°30' W, 36.6', scribed 1/4 S17 BT.

DESCRIPTION OF CORNER EVIDENCE FOUND:

Found 2 1/2" iron pipe with and 2 1/2" brass cap marked as shown below, flush in collar of stone, 1 1/2 ft. diam., from which:
A 25" White Fir bears North 44° East, a distance of 25.0 feet, alive and vigorous with a healed blaze.
Found Northwest bearing trees taken by Ferguson dead and downed.

DESCRIPTION OF MONUMENT AND ACCESSORIES I ESTABLISHED TO PERPETUATE THE ORIGINAL LOCATION OF THIS CORNER:

NEW BEARING OBJECTS:

A 12 inch White Fir bears North, a distance of 11.70 feet, marked 1/4 S17 BT.
An 8 inch Western Larch bears S 74° E, a distance of 14.50 feet, marked 1/4 S16 BT.
A 5 inch White Fir bears S 38° W, a distance of 9.15 feet, marked 1/4 S17 BT.

A North/South barbed wire fence falls 18' to the East.

I hereby certify that the corner was perpetuated on April 30, 2014.

Witness: Thomas J. Kopp

T 11 S R 39 E L-09

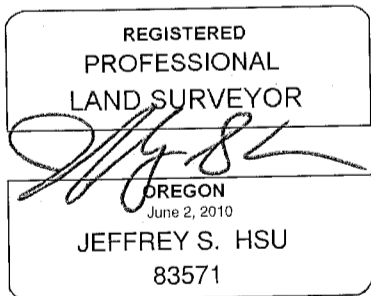
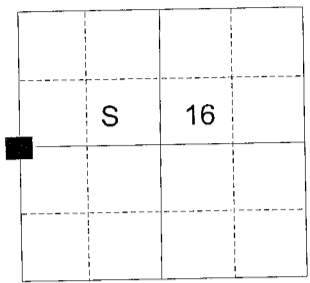

Renewal Date: June 30, 2015

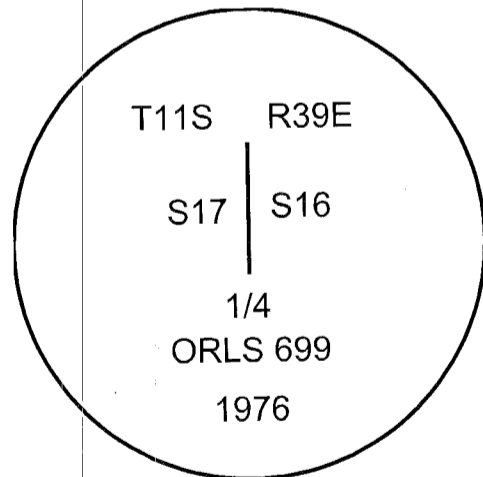

I used a steel tape and magnetic compass in the establishment of the new accessories. I used 16° East declination, the distances are to a 60d spike driven into the right side of the root crown of the new bearing trees. A brass washer marked OPLS 83571 is attached to the BT blaze of the new bearing trees.

L-09

FILED August 5, 2014
BAKER COUNTY SURVEYOR
SURVEY NO. 11-39-191