

CORNER RESTORATION

CORNER: S1/16 SEC. 2 TWP. 11 S. RANGE 39 E.

ORIGINAL SURVEY BY: Corner

CONTRACT NUMBER: Not Previously

CONTRACT DATE: Established

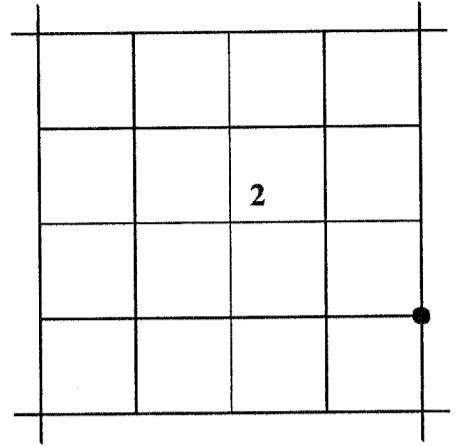

ORIGINAL DESCRIPTION: None

RESTORATION BY, STAMP AND DATE:

J.L. Hatfield
M.C. Springer

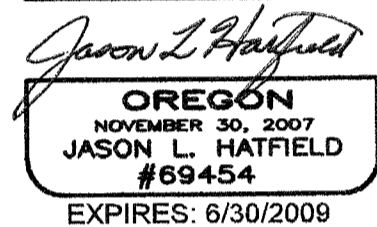
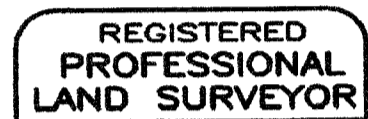

June 24, 2008

EVIDENCE FOUND: None

See Record Survey No. 11-39-157

DESCRIPTION OF MONUMENTS AND ACCESSORIES SET AND METHODS USED:

Show how trees are scribed and basis of bearings including compass var.
At the corner point: I set a 5/8"x30" iron pin, 30" in the ground, with attached 2" diameter Bagett, Griffith and Blackman aluminum cap marked as shown.

From which, I SET NEW REFERENCE POINTS:
A 5/8"x30" iron pin, bears N49°02'20"E, 24.05 ft., with attached alum. cap marked BGB SURVEY MARKER RP 1 2008.

A 5/8"x30" iron pin, bears N55°26'26"W, 28.57 ft., with attached alum. cap marked BGB SURVEY MARKER RP 2 2008.

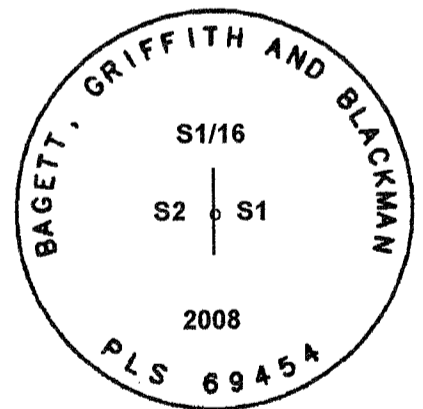

Used RTK GPS to measure accessories.

FILED July 21, 2008
BAKER COUNTY SURVEYOR
SURVEY NO. 11-39-168