

# CORNER RESTORATION

CORNER: E1/4 SEC. 2 TWP. 11 S. RANGE 39 E.

ORIGINAL SURVEY BY: Henry W. Cooke

CONTRACT NUMBER: 418

CONTRACT DATE: August 30, 1881

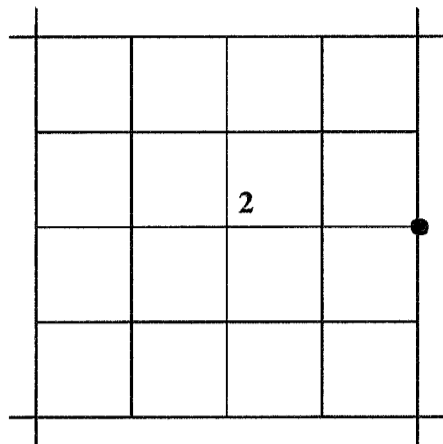

**ORIGINAL DESCRIPTION:** Set a basalt stone 16X12X10 10 in. deep for 1/4 sec. cor. marked 1/4 on W. face raised Md stone alongside.

**RESTORATION BY, STAMP AND DATE:**

J.L. Hatfield  
M.C. Springer

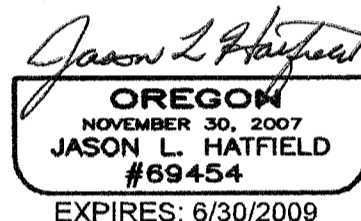
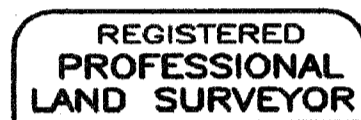

June 17, 2008

**EVIDENCE FOUND:** Found an unmarked basalt stone, 16x12x10, firmly set in a 2 ft. mound of stone in an old dilapidated barbed wire fence running north-south. I accept the stone for the position of the 1/4 section corner.

See Record Survey No. 11-39-157

**DESCRIPTION OF MONUMENTS AND ACCESSORIES SET AND METHODS USED:**

Show how trees are scribed and basis of bearings including compass var. At the corner point: I set a 1½"x30" galv. iron pipe, 24" in the ground, with attached Bagett, Griffith and Blackman brass cap marked as shown.

From which I SCRIBE A NEW BEARING TREE:  
A 17" diameter ponderosa pine bears S28°51'E, 107.0 ft., marked T11S R39E 1/4 S1 BT.

I also SET NEW REFERENCE POINTS:  
A 5/8"x30" iron pin, bears S44°26'42"W, 29.79 ft., with attached alum. cap marked BGB SURVEY MARKER RP 1 2008.

A 5/8"x30" iron pin, bears N44°48'45"W, 30.18 ft., with attached alum. cap marked BGB SURVEY MARKER RP 2 2008.

A 5/8"x30" iron pin, bears N45°45'50"E, 30.23 ft., with attached alum. cap marked BGB SURVEY MARKER RP 3 2008.

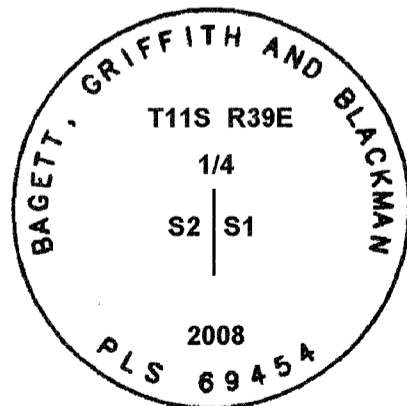

Raised a mound of stone 3 ft. base to top of cap. Placed found stone alongside iron pipe in the mound. Used RTK GPS to measure accessories. Distance to BT was measured with a steel tape to a 50d nail driven in the side-center at the root crown of the tree. Attached a BT tag to the tree.

FILED July 21, 2008  
BAKER COUNTY SURVEYOR  
SURVEY NO. 11-39-166