

CORNER RESTORATION

CORNER: C1/4 SEC. 2 TWP. 11 S. RANGE 39 E.

ORIGINAL SURVEY BY: Corner

CONTRACT NUMBER: Not Previously

CONTRACT DATE: Established

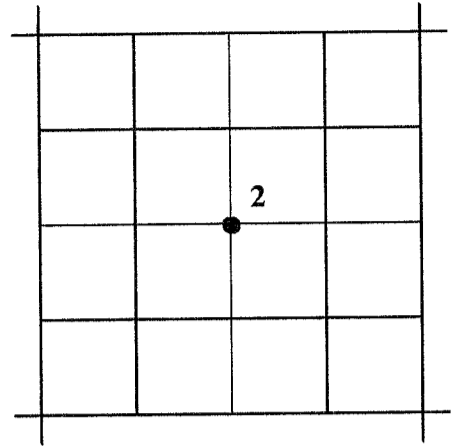

ORIGINAL DESCRIPTION: None

RESTORATION BY, STAMP AND DATE:

J.L. Hatfield
M.C. Springer

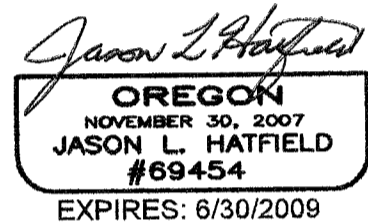
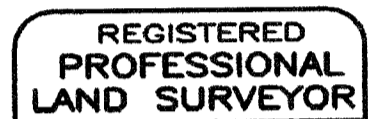

July 2, 2008

EVIDENCE FOUND: None

See Record Survey No. 11-39-157

DESCRIPTION OF MONUMENTS AND ACCESSORIES SET AND METHODS USED:

Show how trees are scribed and basis of bearings including compass var.

At the corner point: I set a 1½"x30" galv. iron pipe, 24" in the ground, with attached Bagett, Griffith and Blackman brass cap marked as shown.

From which I SCRIBE A NEW BEARING TREE:

A 30" diameter ponderosa pine bears N52°41'E, 44.0 ft., marked C1/4 S2 BT.

I also SET NEW REFERENCE POINTS:

A 5/8"x30" iron pin, bears N40°56'56"W, 25.12 ft., with attached alum. cap marked BGB SURVEY MARKER RP 1 2008.

A 5/8"x30" iron pin, bears S47°58'47"E, 43.76 ft., with attached alum. cap marked BGB SURVEY MARKER RP 2 2008.

A 5/8"x30" iron pin, bears S16°25'51"W, 30.98 ft., with attached alum. cap marked BGB SURVEY MARKER RP 3 2008.

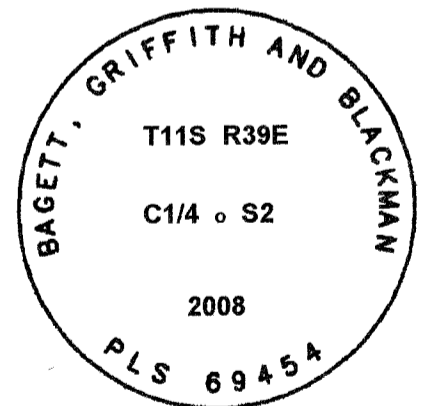

Raised a mound of stone 3 ft. base to top of cap. Used Total Station to measure accessories. Distance to BT was measured to a 50d nail driven in the side-center at the root crown of the tree. Attached a BT tag to the tree.

FILED July 21, 2008
BAKER COUNTY SURVEYOR
SURVEY NO. 11-39-165