

# CORNER RESTORATION

CORNER: NE SEC. 2 TWP. 11 S. RANGE 39 E.

ORIGINAL SURVEY BY: Henry W. Cooke

CONTRACT NUMBER: 418

CONTRACT DATE: August 30, 1881

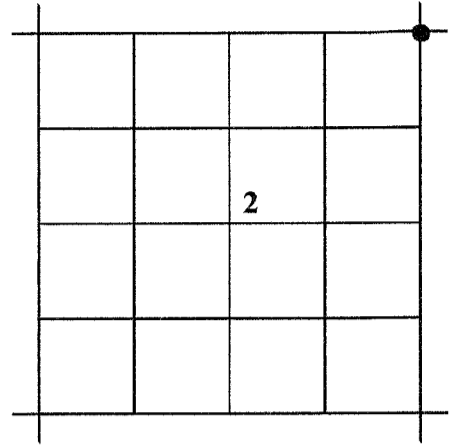

**ORIGINAL DESCRIPTION:** Set a basalt stone 24X16X5 18 in. deep for closing cor. to Sec. 1&2 marked C.C. with 5 notches on W. 1 notch on E. edges raised Md stone alongside.

**RESTORATION BY, STAMP AND DATE:**

J.L. Hatfield  
M.C. Springer

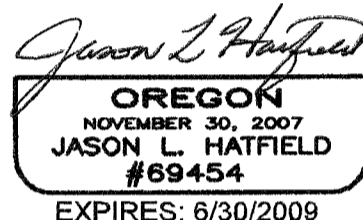
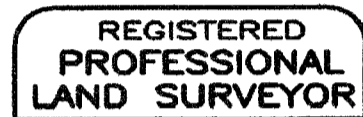

June 17, 2008

**EVIDENCE FOUND:** After searching the area, I found no evidence of the original corner. I established its position at single proportionate measure between the found monuments at the southwest and southeast corners of Section 35, T.10S., R.39E. However, during the monumentation process, as we were building a mound of stone around the pipe, we found a 29"x14"x7" basalt stone with 5 notches on one edge that had been moved into the mound. We were unable to determine the original position of this marked stone, but we know that the stones used in the mound were collected from within arm's reach of the proportionate position. After examination of the soil line on the marked stone, it was clear that this stone was not set in the ground as described in the G.L.O. field notes, but had been lying loose on the ground. As I still had no acceptable evidence as to the original position of this stone, I declare this corner lost, and established its position at proportionate measure, as stated above.  
See Record Survey No. 11-39-157

**DESCRIPTION OF MONUMENTS AND ACCESSORIES SET AND METHODS USED:**

Show how trees are scribed and basis of bearings including compass var. At the corner point: I set a 1½"x30" galv. iron pipe, 12" in the ground, with attached Bagett, Griffith and Blackman brass cap marked as shown.

**From which I SCRIBE A NEW BEARING TREE:**

A 26" diameter ponderosa pine bears S45°38'W, 92.90 ft., marked T11S R39E S2 BT

**I also SET NEW REFERENCE POINTS:**

A 5/8"x30" iron pin, bears N48°44'31"E, 24.19 ft., with attached alum. cap marked BGB SURVEY MARKER RP 1 2008.

A 5/8"x30" iron pin, bears S43°15'58"E, 25.50 ft., with attached alum. cap marked BGB SURVEY MARKER RP 2 2008.

A 5/8"x30" iron pin, bears N35°24'06"W, 31.52 ft., with attached alum. cap marked BGB SURVEY MARKER RP 3 2008.

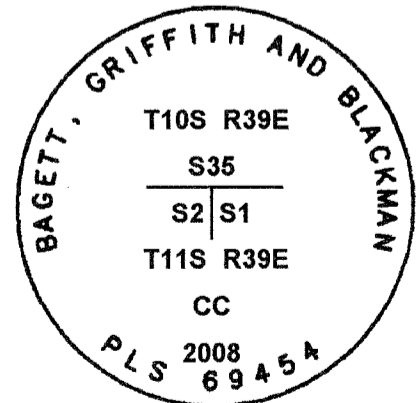

Raised a mound of stone 3 ft. base to top of cap. Placed marked stone alongside iron pipe in mound of stone. Used RTK GPS to measure accessories. Distance to BT was measured with a steel tape to a 50d nail driven in the side-center at the root crown of the tree. Attached a BT tag to the tree.

FILED July 21, 2008  
BAKER COUNTY SURVEYOR  
SURVEY NO. 11-39-160