

# CORNER RESTORATION

CORNER: NW SEC. 2 TWP. 11 S. RANGE 39 E.

ORIGINAL SURVEY BY: Henry W. Cooke

CONTRACT NUMBER: 418

CONTRACT DATE: August 30, 1881

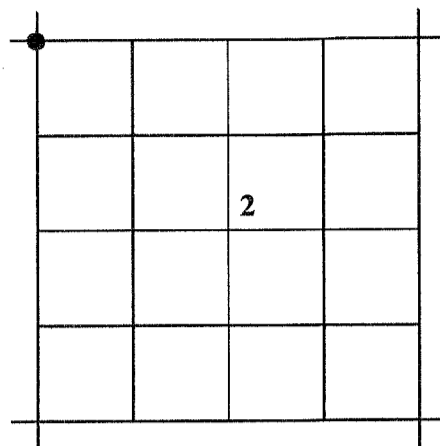

**ORIGINAL DESCRIPTION:** Set a basalt stone 14X14X8 9 in. deep for closing cor. to Sec. 2&3 marked C.C. with 2 notches on E and 4 notches on W. edges raised Md stone alongside.

**RESTORATION BY, STAMP AND DATE:**

J.L. Hatfield  
M.C. Springer

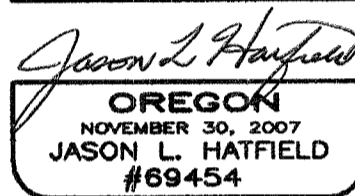
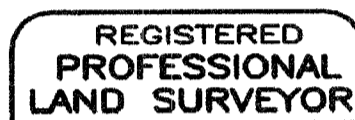

June 17, 2008

**EVIDENCE FOUND:** After a diligent search, I found no evidence of the original corner. I declare this corner lost and establish its position at single proportionate measure between the found monuments at the south 1/4 corner and southeast corner of Section 34, T.10S., R.39E. This corner falls in an east-west fence.

See Record Survey No. 11-39-157

**DESCRIPTION OF MONUMENTS AND ACCESSORIES SET AND METHODS USED:**

Show how trees are scribed and basis of bearings including compass var. At the corner point: I set a 1½"x30" galv. iron pipe, 28" in the ground, with attached Bagett, Griffith and Blackman brass cap marked as shown.

From which, I SET NEW REFERENCE POINTS:  
A 5/8"x30" iron pin, in a north-south fence, bears N39°42'21"E, 55.94 ft., with attached alum. cap marked BGB SURVEY MARKER RP 1 2008.

A 5/8"x30" iron pin, bears S45°15'13"E, 42.30 ft., with attached alum. cap marked BGB SURVEY MARKER RP 2 2008.

A 5/8"x30" iron pin, in a north-south fence, bears S33°34'44"W, 36.09 ft., with attached alum. cap marked BGB SURVEY MARKER RP 3 2008.

A 5/8"x30" iron pin, bears N25°27'47"W, 45.15 ft., with attached alum. cap marked BGB SURVEY MARKER RP 4 2008.

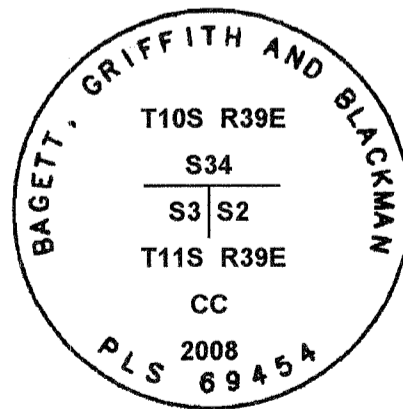

Raised a mound of stone 3 ft. base to top of cap. Used RTK GPS to measure accessories.

FILED July 21, 2008  
BAKER COUNTY SURVEYOR  
SURVEY NO. 11-39-158