

CERTIFIED RECORD OF LAND CORNER MONUMENTATION
TOWNSHIP 10 SOUTH, RANGE 44 EAST

West 1/4 corner section 18,
 T. 10 S., R. 44 E., of the W.M.

History of original corner
 Original corner set by N. Walden
 Deputy Surveyor under contract
 No. 198, dated July 15, 1873
 Set sandstone 24"x10"x8"

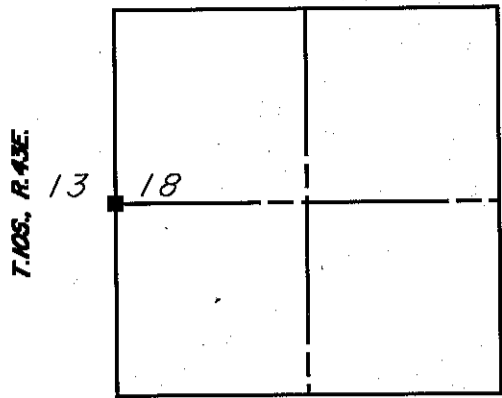

Subsequent survey:
 W.B. Barr survey under contract no. 388
 Dated May 7, 1881 found sandstone 24" x 10" x 8"
 agreeing with description.

Description of evidence found:
 Found stone 24" x 10" x 80" with 1/4 on the west face and in small mound on a steep westerly slope.

Description of monument and accessories
 established to perpetuate the location of this corner:
 Set a 5/8" diameter x 30" long iron rod and 2" Diameter aluminum cap marked:

T10S R44E
 1/4 13 | 18
 LS1015
 2001

From the corner point:
 A 5/8" diameter x 30" long iron rod with a 1.3" diameter yellow plastic cap marked "LS1015" bears North 18° East 6.48 feet.

A 5/8" diameter x 30" long iron rod with a 1.3" diameter yellow plastic cap marked "LS1015" bears South 14° East 9.47 feet.

Deposited stone alongside new monument. An old east-west fence, down and partially covered by dirt is 24 feet north of corner point.

Compass declination 19° East .

I hereby certify that the above corner point was perpetuated as herein described on 11/15/01.

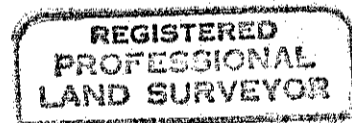

Richard A. Shaver

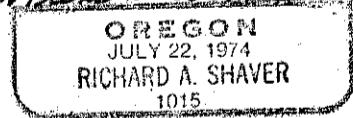

FILED JUNE 3, 2002
 BAKER COUNTY SURVEYOR
 SURVEY NO. 10-44-5
 CP# 85

Timberline Surveys
 P.O. Box 61
 Wallowa, Oregon 97885
 Phone 541-886-2605
 Registration expires
 6/30/02

Office of County Surveyor for the County of Baker, State of Oregon, I hereby
 Certify that the within instrument was filed in this office for record on the
 day of 2002

..... by.....
 (county official) (deputy)