

RECORD OF LAND CORNER MONUMENTATION

CORNER: C $\frac{1}{4}$ Cor. Sec. 30, T.10S., R.38E., W.M.

ORIGINAL SURVEY BY: Corner

CONTRACT NUMBER: Not Previously

CONTRACT DATE: Established

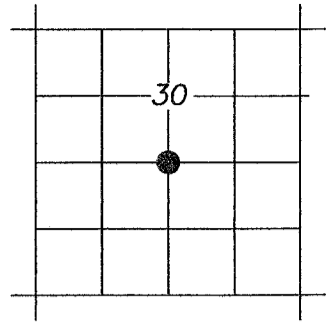

ORIGINAL G.L.O. DESCRIPTION: None, Corner not previously established.

EVIDENCE FOUND: None, Corner not previously established

DESCRIPTION OF MONUMENT AND ACCESSORIES SET:

Set 5/8" x 30" iron pin 28" in the ground, with attached 2 1/2" aluminum cap marked as shown below. Built 2' mound of stone around corner.

FROM WHICH, I set the following reference points:

A 5/8" x 30" iron pin, bears N.57°35'E., 12.22 ft., with attached yellow plastic cap marked BENCHMARK SURVEYING.

A 5/8" x 30" iron pin, bears N.37°01'W., 25.70 ft., with attached yellow plastic cap marked BENCHMARK SURVEYING.

ALSO FROM WHICH, I scribe the following Bearing Trees:

A Ponderosa Pine, 15" diam., bears S.56°E., 37.35 ft., mkd. C $\frac{1}{4}$ S30 BT.

A Ponderosa Pine, 6" diam., bears S.32°W., 4.57 ft., mkd. C $\frac{1}{4}$ S30 BT.

Placed BT tags on BT's.

Used RTK GPS to measure RP's. Bearings to RP's are based on a survey dated October 19, 2016, submitted to the Baker County Surveyor for recording October 25, 2016. Used a steel tape measuring to a 50d nail driven in side-center of root crown of BT. Used a compass with 15' variance to measure bearing to BT.

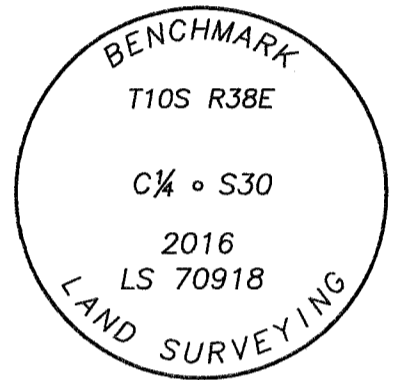

MONUMENTED BY:

Michael C. Springer, PLS
Marcus Teague, Technician

Benchmark Land Surveying
217 N. Canyon Blvd.
John Day, OR 97845
Phone: (541) 575-1251

Surveyed October 10, 2016
October 19, 2016

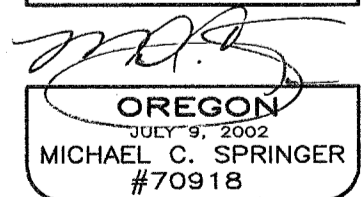
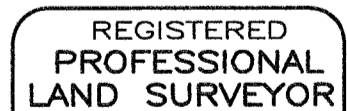

EXPIRES: 6/30/2018

FILED Oct. 25, 2016
BAKER COUNTY SURVEYOR
SURVEY NO. 10-38-169

T-03