

RECORD OF LAND CORNER MONUMENTATION

CORNER: CE1/16 Cor. Sec. 30, T.10S., R.38E., W.M.

ORIGINAL SURVEY BY: Corner

CONTRACT NUMBER: Not Previously

CONTRACT DATE: Established

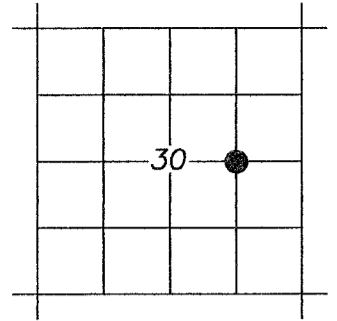

ORIGINAL G.L.O. DESCRIPTION: None, Corner not previously established.

EVIDENCE FOUND: None, Corner not previously established

DESCRIPTION OF MONUMENT AND ACCESSORIES SET:

Set 5/8" x 30" iron pin 29" in the ground with 2" aluminum cap marked as shown below. Built 2 ft. mound of stone around corner. Corner is approximately 15 ft. W. of fence running N-S.

FROM WHICH, I set the following reference points:

A 5/8" x 30" iron pin bears N.33°59'E., 14.54 ft., with attached yellow plastic cap mkd. BENCHMARK SURVEYING.

A 5/8" x 30" iron pin bears S.38°31'E., 13.19 ft., with attached yellow plastic cap mkd. BENCHMARK SURVEYING.

Used RTK GPS to measure RP's. Bearings to RP's are based on a survey dated October 19, 2016, submitted to the Baker County Surveyor for recording October 25, 2016.

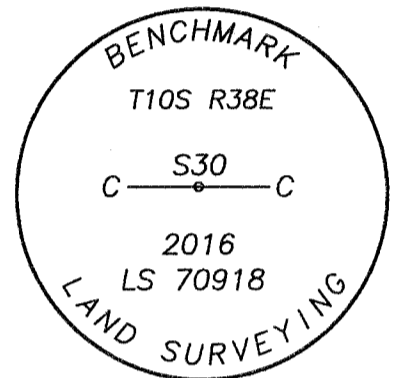

MONUMENTED BY:

Michael C. Springer, PLS
Marcus Teague, Technician

Benchmark Land Surveying
217 N. Canyon Blvd.
John Day, OR 97845
Phone: (541) 575-1251

Surveyed October 10, 2016
October 19, 2016

REGISTERED
PROFESSIONAL
LAND SURVEYOR

OREGON
JULY 9, 2002
MICHAEL C. SPRINGER
#70918

EXPIRES: 6/30/2018

FILED Oct. 25, 2016
BAKER COUNTY SURVEYOR
SURVEY NO. 10-38-170

T-04