

RECORD OF LAND CORNER MONUMENTATION

CORNER: N¼ Cor. Sec. 30, T.10S., R.38E., W.M.

ORIGINAL SURVEY BY: William R. Gradon

CONTRACT NUMBER: 409

CONTRACT DATE: March 28, 1882

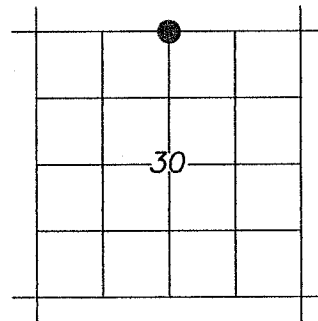

ORIGINAL G.L.O. DESCRIPTION: Set a post 3 ft. long 3 ins. square 12 ins. in ground for ¼ sec. cor. marked ¼ S. on N. face. From which a pine 24 ins. dia. bears S10°W., 20 lks. dist. marked ¼ S BT. A pine 24 ins. dia. bears N68°W., 31 lks dist. marked ¼ S BT.

EVIDENCE FOUND: After a thorough search, I was unable to find any evidence of original GLO corner or accessories. I therefore determine this corner to be lost.

DESCRIPTION OF MONUMENT AND ACCESSORIES SET:

At a position determined by proportionate measure between the NE and NW corners of section 30, set 5/8" x 30" iron pin 28" in the ground, with 2½" aluminum cap marked as shown below. Built a 2 ft. mound of stone around the corner.

FROM WHICH, I set the following reference points:

A 5/8" x 30" iron pin, bears N.47°20'E., 67.65 ft., with attached yellow plastic cap mkd. BENCHMARK SURVEYING.

A 5/8" x 30" iron pin, bears S.14°56'E., 37.23 ft., with attached yellow plastic cap mkd. BENCHMARK SURVEYING.

A 5/8" x 30" iron pin, bears N.46°53'W., 13.61 ft., with attached yellow plastic cap mkd. BENCHMARK SURVEYING.

ALSO FROM WHICH, I scribed the following bearing tree:

A Ponderosa Pine, 9" diam., bears S.78°30'W., 30.95 ft. dist. mkd. ¼S30 BT. Attached yellow BT tag.

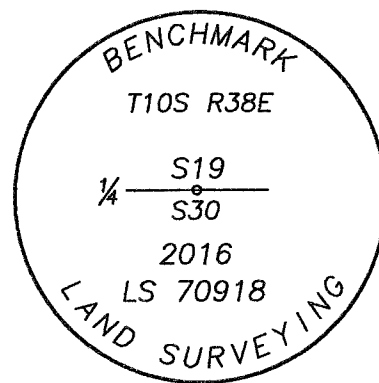

Used RTK GPS to measure RP's. Bearings to RP's are based on a survey dated October 19, 2016, submitted to the Baker County Surveyor for recording October 25, 2016. Used a steel tape measuring to a 50d nail driven in side-center of root crown of BT. Used a compass with 15' variance to measure bearing to BT.

MONUMENTED BY:

Michael C. Springer, PLS
 Marcus Teague, Technician

Benchmark Land Surveying
 217 N. Canyon Blvd.
 John Day, OR 97845
 Phone: (541) 575-1251

Surveyed October 10, 2016
 October 19, 2016

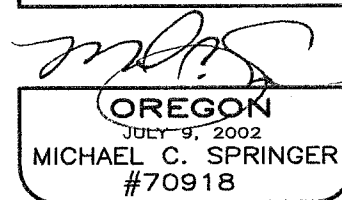
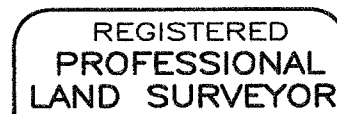

EXPIRES: 6/30/2018

FILED Oct. 25, 2016
 BAKER COUNTY SURVEYOR
 SURVEY NO. 10-38-167

R-03