

B07 34 0223

B07 34 0224

B07 34 0225

N.W. CORNER OF
THE E $\frac{1}{2}$ NW $\frac{1}{4}$ SW $\frac{1}{4}$
OF SECTION 3,
T. 10 S., R. 37 E., W.M.

PP PARCEL 3
No. 1999-010

PP PARCEL 2
No. 1999-010

P.O.B.

PARCEL 4
5.06 ACRES

PARCEL 4
1.42 ACRES

BASIS OF BEARING

12' WIDE UTILITY EASEMENT
CREATED BY PP 1999-010

TΔ = 7° 32' 30" Ts = 401.81'
R = 3869.72' R = 3819.72'
L = 106.65'
C = S. 87° 45' 13" W,
106.64'

1'30" C.L.
TΔ = 7° 32' 30"
Ts = 401.81'
R = 3819.72'

O.S.H.D. Centerline Data

300' Sp.
S = 2' 15"
a = 0.5

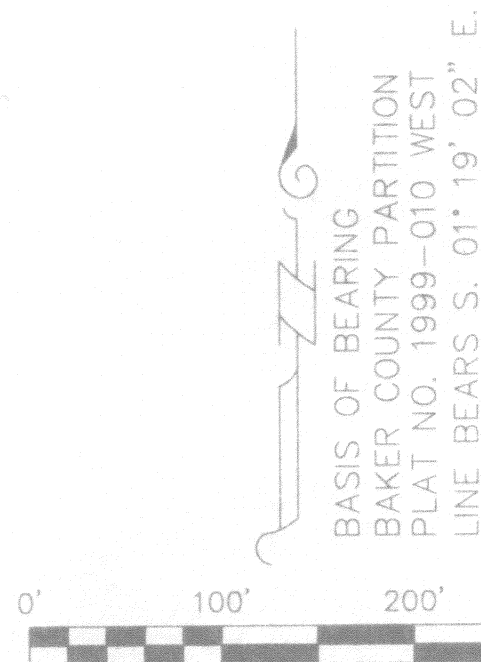

LEGEND

- Set 5/8" x 30" rebar with plastic cap marked "HANLEY ENGR. PLS 1817".
- Found, 5/8" rebar with plastic cap marked "HANLEY ENGR. PLS 1206". Set by Baker County PP No. 1999-010
- Record data per Baker Co. Survey No. 10-37-119 MP
- Highway control, not monumented

State of Oregon
County of Baker

This instrument was acknowledged before me

This 9th day of July 2007

By Chris J. Skidgel and Myra L. Skidgel

Notary Public in & for

My Commission Expires 3-22-2008

HANLEY ENGINEERING, INC.

P.O. BOX 701, 2043 MAIN STREET, BAKER CITY, OREGON 97814 (541) 523-3803

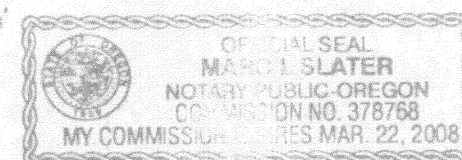

I, Thomas J. Hanley, hereby certify that this is an exact duplicate copy of the partition plat as submitted to the Baker County Clerk for recording.

Thomas J. Hanley

PARTITION PLAT NO.

SURVEYOR'S CERTIFICATE

P2007-010

I, Thomas J. Hanley, certify that I have correctly surveyed and platted two parcels of land on this partition plat in accordance with O.R.S. Chapter 92. The boundary of the partition is as follows:
Land located in the E $\frac{1}{2}$ NW $\frac{1}{4}$ SW $\frac{1}{4}$ of Section 3, T. 10 S., R. 37 E., W.M., Baker County, Oregon, lying North of Sumpter Valley Highway No. 220, more particularly described as Parcel No. 1 of Baker County Partition Plat No. 1999-010, the exterior boundary of which is described as follows;

Commencing at the Northwest corner of the said E $\frac{1}{2}$ NW $\frac{1}{4}$ SW $\frac{1}{4}$; thence S. 01° 19' 02" E., 781.66 feet along the West line of said E $\frac{1}{2}$ NW $\frac{1}{4}$ SW $\frac{1}{4}$ to the Point of Beginning; thence S. 89° 40' 00" E., 557.71 feet; thence S. 01° 20' 52" E., 502.20 feet; thence N. 89° 18' 17" W., 24.72 feet; thence along a spiral curve left, the chord of which bears S. 89° 55' 44" W., 298.01 feet to a point 50 feet right of and opposite centerline Station 479+98.19 P.S.C.; thence along a 3869.72 foot radius curve left to a point 50 feet right of centerline Station 481+00, the chord of which bears S. 87° 45' 13" W., 106.64 feet; thence S. 85° 08' 49" W., 128.74 feet; thence N. 01° 19' 02" W., 520.57 feet along said West line to the Point of Beginning.

Land containing 6.48 acres

REGISTERED
PROFESSIONAL
LAND SURVEYOR

THOMAS J. HANLEY
JULY 13, 1979
1817

Renews June 30, 2007

NARRATIVE

The purpose of this survey and plat for Jack D. Williams and GERALYN WILLIAMS and Chris J. Skidgel and Myra L. Skidgel is to partition the above described land into two parcels. Monumentation described in Baker County Partition Plat No. 1999-010 was recovered. Baker County Deed No. 94-17-0137 provided the property descriptions for the subject property.

DECLARATION

Know all people by these presents that Jack D. Williams and GERALYN WILLIAMS and Chris J. Skidgel and Myra L. Skidgel are the owners of the land represented on this partition plat, and more particularly described in the accompanying Surveyor's Certificate and have caused the same to be partitioned into two parcels as shown, in accordance with O.R.S. Chapter 92.

Jack D. Williams
GERALYN WILLIAMS

Chris J. Skidgel
Myra L. Skidgel

ACKNOWLEDGMENT

State of Arizona } S.S.
County of La Paz }

On June 25, 2007 before me did personally appear the within named Jack D. Williams and GERALYN WILLIAMS and Chris J. Skidgel and Myra L. Skidgel who acknowledged to me that they have executed the same freely and voluntarily.

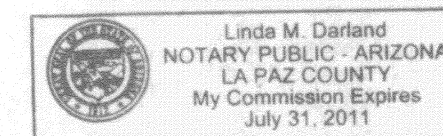

Linda M. Darland
NOTARY PUBLIC
My Commission Expires 7-31-11

APPROVALS

We the undersigned officers in and for Baker County, Oregon do hereby approve this minor partition plat.

Baker County Surveyor by: Linda M. Darland; Date MAY 29, 2007

Baker County Planning by: Anna Livingston; Date Aug. 21, 2007

I hereby certify that all taxes for the subject property have been paid as required.

Baker County Tax Collector by: Alice Sunfinger; Date Aug 21, 2007

State of Oregon } S.S.
County of Baker }

I do hereby certify that the annexed minor partition plat was received for recording on the 21st day of August, 2007 at 1:50 o'clock P. M., and recorded in Baker County records and is hereby approved.

Baker County Clerk by: Samara J. Green, by Cindy Carpenter, Deputy

FILED August 22, 2007
BAKER COUNTY SURVEYOR
SURVEY NO. 10-37-130