

CERTIFIED RECORD OF LAND CORNER MONUMENTATION

History of original corner establishment:

Not previously set.

DIAGRAM

T10S R37E

C1/4

+

S9

1994

PLS699

Description of corner evidence found:

Corner is being set by this survey.

Description of monument and accessories I established to perpetuate the original location of this corner:

Set 2" aluminum pipe with 3 1/4" aluminum cap, stamped as shown in diagram, 26" in ground, at a point as determined by the procedures set forth in the MANUAL OF INSTRUCTIONS FOR THE SURVEY OF PUBLIC LANDS for the subdivision of sections, in mound of earth 30" base, 4" high, from which new accessories are:

A 10" Ponderosa Pine, bears N9°45'W, 9.16 ft., scribed "C1/4 S9 BT"

A 9" Ponderosa Pine, bears N84°30'E, 12.97 ft., scribed "C1/4 S9 BT"

A pink DEEP (Underground Magnetic Locator), bears S9°45'E, 3.1 ft. from corner position, 1.6 ft. in ground.

A blue DEEP, bears S84°30'W, 2.8 ft. from corner position, 1.3 ft. in ground.

Also set galvanized steel post with "Land Survey Monument" sign 5 ft. W..

I, Leland Lee Myers, 587 E Auburn Street, PO Box 98, Sumpter, OR 97877, do hereby certify that on June 14, 1994, I monumented the corner as herein described.

FILED IN THE OFFICE OF THE BAKER COUNTY SURVEYOR THIS

7 DAY OF Feb, 1995.

10-37-47

Baker County Surveyor

Client: US Forest Service

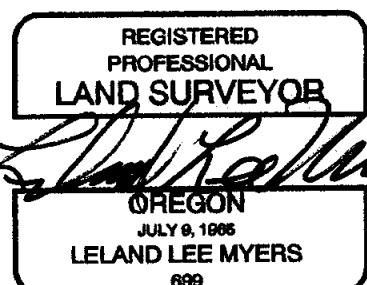

Renewal Date 1/1/97

T10S R37E G-11