

CERTIFIED RECORD OF LAND CORNER MONUMENTATION

History of original corner establishment:

U-12

Corner originally established by Douglas M. Ferguson, PLS 848, on September 22, 1988 under U.S. Forest Service contract.

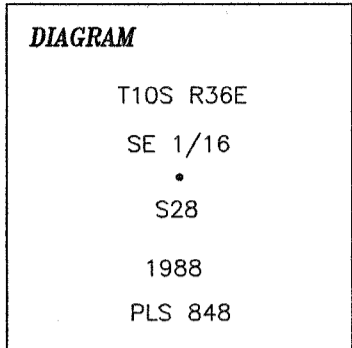

Ferguson's record states:

Set 2-1/2"x30" aluminum pipe with 3-1/2" aluminum cap, stamped as shown on the DIAGRAM, set 24" in the ground.

From which:

Lodgepole Pine 18" dia., Bears N87°51'E, 83.6 ft., scribed: SE 1/16 S28 BT

Lodgepole Pine 18" dia., Bears N1°43'E, 46.2 ft., scribed: SE 1/16 S28 BT

Measurements to trees taken with Electronic Tacheometer with bearings turned from the survey control network.

Nailed a brass washer stamped PLS 848 on blaze above BT scribe, Bearing Tree sign above blaze, and warning sign on back of each tree. Painted a 6" red band at breast ht. around each tree. Set steel fence posts with warning & boundary signs, North & East 4 ft. from the corner.

Description of corner evidence found:

Found 3/4" (record 3 1/2") diameter aluminum cap on 30" aluminum pipe laying on top of ground.

From which:

A Lodgepole Pine 18" diameter, 7' tall snag, bears N87°51'E, 83.6', with visible scribing.

A Lodgepole Pine 20" diameter, bears N1°43'E, 46.2', with visible scribing.

No trace of steel fence posts.

Description of monument and accessories I established to perpetuate the original location of this corner:

Reset monument from existing bearing trees. Set flush with ground in small stone mound.

New accessory:

A 2" aluminum cap on 5/8"x30" rebar, bears N88°E, 15.0', marked as shown below, flush with ground.

Geodetic Coordinates (NAD83):

N 44°39'44.7"

W 118°17'58.2"

Geodetic coordinates were obtained from a Garmin recreational grade GPS receiver and have been averaged.

Date: August 9, 2014

Declination: 14 1/2° E

Witnesses: Mark Lichtenthaler

Lisa Adair

Dan Lee

Paul Guglielmelli

Toribio Quinones

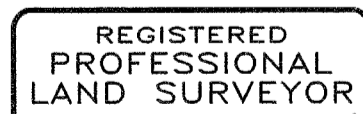

Kenneth A. Lind

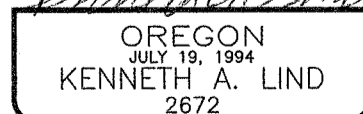

Renews: 12-31-14

FILED November 18, 2014

BAKER COUNTY SURVEYOR

SURVEY NO. 10-36-164