

**CERTIFIED RECORD OF LAND CORNER MONUMENTATION**

**History of original corner establishment:**

This corner was established by Charles M. Foster, U.S. Deputy Mineral Surveyor, as part of MS 332, during December, 1896. The original notes state that at the corner  $4\frac{1}{2}'$  long by 4" square marked post was set 18" in the ground and surrounded with a mound of earth from which:

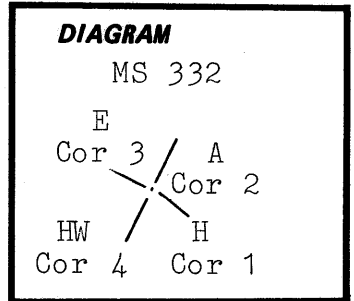

A  $2\frac{1}{2}'$  pine bears  $S31\frac{1}{2}^{\circ}W-16'$ , marked 1-332 BT.  
A 20" pine bears  $N3\frac{1}{2}^{\circ}E-9'$  marked 1-332 BT.

Atlantic Cor. 2  
Haggard Cor. 1  
Emma Cor. 3  
Haggard West Cor. 4

A previous survey by Charles M. Foster in 1892, as part of MS 266 A, established this corner as Corner No. 4 of the Haggard Quartz Claim. The 266 A notes state that a  $4\frac{1}{2}'$  long by 4" square marked post was set 12" in the ground with a mound of earth from which:

A 14" pine bears  $N60^{\circ}E-83'$  marked H QTZ C Cor 4 BT.

**Description of corner evidence found:**

A 10" pine bears  $S35^{\circ}E-3'$ , marked H QTZ C. Cor 4 BT.

Found a mound of earth with rotted remains of post at ground level from which:

A rotted pon. pine stump bears  $S35^{\circ}E-3.5'$  with scribing visible on a log next to stump. (MS 266 A bearing tree).

A 20" pon. pine stump for which there is no record bears  $N26^{\circ}W-35.3'$  with scribing "BT" visible on stump.

See survey narrative recorded with this corner certificate.

No evidence of MS 332 bearing trees remain.

**Description of monument and accessories | established to perpetuate the original location of this corner:**

Set a  $2\frac{1}{2}"$  by 30" aluminum pipe with  $2\frac{1}{2}"$  aluminum cap 24" in the ground and surrounded with a mound of earth and stone. Placed original post remains on the new mound. From the new monument:

A 10" white fir bears  $N43^{\circ}E-18.6'$  scribed 2-A-1-H-4-HW-3-E-332 BT.  
A 9" white fir bears  $S21\frac{1}{2}^{\circ}E-16.5'$  scribed 2-A-1-H-4-HW-3-E-332 BT.

New bearing trees have a brass washer stamped PLS 1106 nailed to the face of blaze. Attached sign 54-3 and 54-9 and painted face of blaze and a 6" red band around each bearing tree. Set steel fence post on claim line near corner and attached sign 54-9.

Used steel tape and staff compass with  $20^{\circ}E$  declination, measured to the center of the bearing trees.

Cap is marked:  
MS 332

This corner was remonumented on October 31, 1985.

Witness: Willard Hulick.

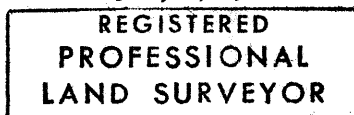

*William R. Wells*

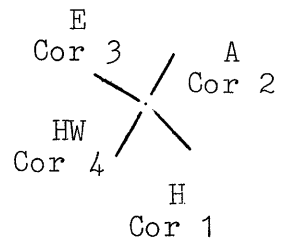
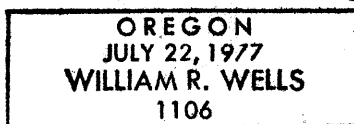

1985  
PLS 1106

Office of.....County Surveyor.....County of.....Baker.....  
State of.....Oregon....., I hereby certify that the within instrument was filed in this office  
for record on the..... day of....., 19.....  
..... by .....  
(COUNTY OFFICIAL) (DEPUTY)

FILED 2-3-86  
BAKER COUNTY SURVEYOR  
SURVEY NO. 10-35 1/2-129