

RECORD OF LAND CORNER MONUMENTATION

CORNER: C-S1/16 COR. SECTION 21, TWP. 10 S., RANGE 35 E., W.M.

(CORNER NOT PREVIOUSLY ESTABLISHED)

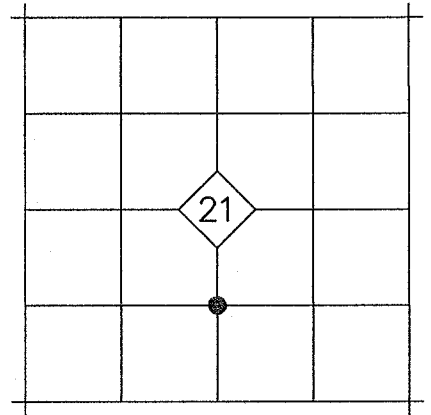

ORIGINAL DESCRIPTION: N/A

EVIDENCE FOUND: N/A

DESCRIPTION OF MONUMENTS AND ACCESSORIES SET AND METHODS USED:

At the corner point, as determined by survey, set a 5/8"x30" iron pin with attached 1 1/2" aluminum cap 30" in the ground. Cap is marked as shown below.

From which, **I SET THE FOLLOWING REFERENCE POINT:**

- ▶ A 5/8"x30" iron pin bears S.71°28'E., 19.61ft. with attached yellow plastic cap marked BENCHMARK SURVEYING

I also **SCRIBED THE FOLLOWING BEARING TREE:**

- ▶ A 7.1" dbh lodgepole pine bears N.77°W., 19.83 feet, marked *CS1/16 S21 BT*

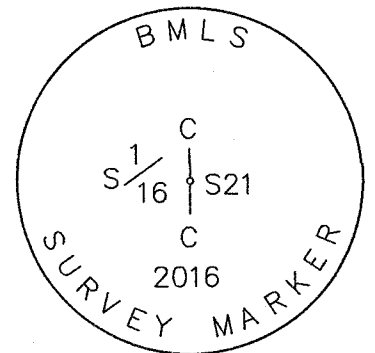

Used RTK GPS to measure the reference point. Used a magnetic compass with 15°E declination to measure the bearing to the tree. Distance measured with a steel tape, measuring to a 20d nail driven at the base of the tree (side center).

RESTORATION BY, STAMP AND DATE:

Work Performed June 30, 2016 by:

Jason L. Hatfield, PLS
Kevin M. Stolfo, Technician

BENCHMARK LAND SURVEYING, INC.
2101 Main Street, Suite 223
Baker City, OR 97814
(800) 699-0516
www.benchmarkls.com

FILED July 13, 2016
BAKER COUNTY SURVEYOR
SURVEY NO. 10-35-245

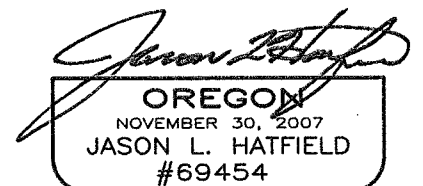
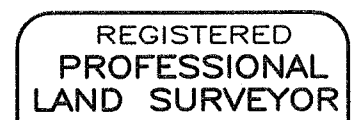

EXPIRES: 6/30/2017